

**WATER WELL PLUGGING RECORD Form WWC-5P**

KSA 82a-1212 ID NO.

**IW 10**

<b>1 LOCATION OF WATER WELL:</b> County: <u>Kiowa</u>	Fraction <u>¼ sw ¼ ne ¼ ne ¼</u>	Section Number <u>16</u>	Township Number <u>T 28 S</u>	Range Number <u>19</u> <input type="checkbox"/> E <input checked="" type="checkbox"/> W
--	-------------------------------------	-----------------------------	----------------------------------	--

Street/Rural Address of Well Location; if unknown, distance & direction from nearest town or intersection: If at owner's address, check here  ANR Pipeline Company  
15499 Avenue 19  
Greensburg, KS 67054

**Global Positioning Systems (GPS) information:**  
Latitude: 37.612822 (in decimal degrees)  
Longitude: -99.39705 (in decimal degrees)  
Elevation: 2280  
Horizontal Datum:  WGS84,  NAD83,  NAD27  
Collection Method:

**2 WATER WELL OWNER:** ANR Pipeline Company  
RR#, St. Address, Box #: 717 Texas Avenue #2400  
City, State ZIP Code: Houston, TX 77002

GPS unit (Make/Model: \_\_\_\_\_)  
 Digital Map/Photo,  Topographic Map,  Land Survey  
Est. Accuracy:  < 3 m,  3-5 m,  5-15 m,  > 15 m

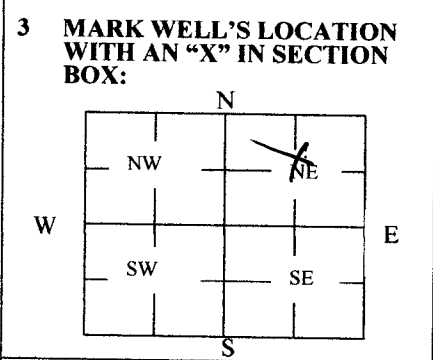

**4 DEPTH OF WELL** 85 ft.

WELL'S STATIC WATER LEVEL \_\_\_\_\_ ft

WELL WAS USED AS:

<input type="checkbox"/> Domestic	<input type="checkbox"/> Public Water Supply	<input type="checkbox"/> Dewatering
<input type="checkbox"/> Irrigation	<input type="checkbox"/> Oil Field Water Supply	<input type="checkbox"/> Monitoring
<input type="checkbox"/> Feedlot	<input type="checkbox"/> Domestic (Lawn & Garden)	<input checked="" type="checkbox"/> Injection Well
<input type="checkbox"/> Industrial	<input type="checkbox"/> Air Conditioning	<input type="checkbox"/> Other <u>IW-10</u>

Was a chemical/bacteriological sample submitted to Department? Yes  No

**5 TYPE OF BLANK CASING USED:**

Steel  RMP (SR)  Wrought  Fiberglass  Other (Specify below)  
 PVC  ABS  Asbestos-Cement  Concrete Tile

Blank casing diameter 2 in. Was casing pulled? Yes  No  If yes, how much 3-feet  
 Casing height above or below land surface 0 in.

**6 GROUT PLUG MATERIAL:**  Neat cement  Cement grout  Bentonite  Other 0.5 to 3' Topsoil/Seed

Grout Plug Intervals: From 3 ft. to 85 ft., From N/A ft. to N/A ft., From N/A ft. to N/A ft.

What is the nearest source of possible contamination:

<input type="checkbox"/> Septic tank	<input type="checkbox"/> Seepage pit	<input type="checkbox"/> Fuel storage	<input checked="" type="checkbox"/> Other (specify below) <u>Natural Gas Compressor Station</u>
<input type="checkbox"/> Sewer lines	<input type="checkbox"/> Pit privy	<input type="checkbox"/> Fertilizer storage	
<input type="checkbox"/> Watertight sewer lines	<input type="checkbox"/> Sewage lagoon	<input type="checkbox"/> Insecticide storage	
<input type="checkbox"/> Lateral lines	<input type="checkbox"/> Feedyard	<input type="checkbox"/> Abandoned water well	
<input type="checkbox"/> Cess pool	<input type="checkbox"/> Livestock pens	<input type="checkbox"/> Oil well/Gas well	

Direction from well? Adjacent  
How many feet? 0-feet

FROM	TO	PLUGGING MATERIALS	FROM	TO	PLUGGING MATERIALS
0	0.5	Topsoil/Grass Seed			
0.5	85	Bentonite (hydrated)			

**7 CONTRACTOR'S OR LANDOWNER'S CERTIFICATION:** This water well was plugged under my jurisdiction and was completed on (mo/day/year) 8/10/2020 and this record is true to the best of my knowledge and belief. Kansas Water Well Contractor's License No. 759. This Water Well Record was completed on (mo/day/year) 8/12/2020 under the business name of RAZEK Environmental, LLC by (signature) *[Signature]*

Send one white copy to Kansas Department of Health & Environment, Geology Section, 1000 SW Jackson Street, Ste. 420, Topeka, KS 66612-1367. Send one copy to WATER WELL OWNER and retain one for your records.  
 Visit us at <http://www.kdheks.gov/waterwell/index.html> Telephone 785-296-5524.