

1 LOCATION OF WATER WELL: County: KIOWA Fraction: NW 1/4 NW 1/4 SW 1/4 Section Number: 27 Township Number: T 28 S Range Number: R 20 EW

Distance and direction from nearest town or city street address of well if located within city? 1 1/2 WEST OF MULLINVILLE

2 WATER WELL OWNER: SCOTTY ALEXANDER Board of Agriculture, Division of Water Resources Application Number: MULLINVILLE, KS 67109

3 LOCATE WELL'S LOCATION WITH AN "X" IN SECTION BOX:

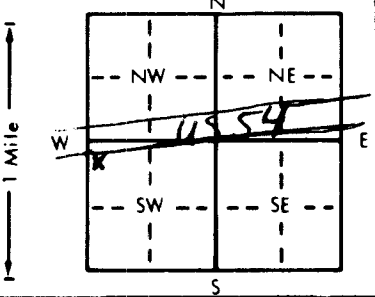

4 DEPTH OF COMPLETED WELL: 100 ft. ELEVATION: ... Depth(s) Groundwater Encountered: 1. 85 ft. 2. ... ft. 3. ... ft. WELL'S STATIC WATER LEVEL: 85 ft. below land surface measured on 2-15-88 Pump test data: Well water was 85 ft. after 2 hours pumping 30 gpm Est. Yield: 30 gpm; Well water was ... ft. after ... hours pumping ... gpm Bore Hole Diameter: 7 7/8 in. to 100 ft., and ... in. to ... ft. WELL WATER TO BE USED AS: 1 Domestic 2 Irrigation 3 Feedlot 4 Industrial 5 Public water supply 6 Oil field water supply 7 Lawn and garden only 8 Air conditioning 9 Dewatering 10 Observation well 11 Injection well 12 Other (Specify below) Was a chemical/bacteriological sample submitted to Department? Yes ... No If yes, mo/day/yr sample was submitted Water Well Disinfected? Yes No

5 TYPE OF BLANK CASING USED: 1 Steel 2 PVC 3 RMP (SR) 4 ABS 5 Wrought iron 6 Asbestos-Cement 7 Fiberglass 8 Concrete tile 9 Other (specify below) CASING JOINTS: Glued Clamped ... Welded ... Threaded ...

Blank casing diameter: 4 in. to 80 ft., Dia ... in. to ... ft., Dia ... in. to ... ft. Casing height above land surface: 18" in., weight 1.895 lbs./ft. Wall thickness or gauge No. SDR 21

TYPE OF SCREEN OR PERFORATION MATERIAL: 1 Steel 2 Brass 3 Stainless steel 4 Galvanized steel 5 Fiberglass 6 Concrete tile 7 PVC 8 RMP (SR) 9 ABS 10 Asbestos-cement 11 Other (specify) 12 None used (open hole)

SCREEN OR PERFORATION OPENINGS ARE: 1 Continuous slot 2 Louvered shutter 3 Mill slot 4 Key punched 5 Gauzed wrapped 6 Wire wrapped 7 Torch cut 8 Saw cut 9 Drilled holes 10 Other (specify) 11 None (open hole)

SCREEN-PERFORATED INTERVALS: From 80 ft. to 100 ft., From ... ft. to ... ft. GRAVEL PACK INTERVALS: From 13 ft. to 100 ft., From ... ft. to ... ft.

6 GROUT MATERIAL: 1 Neat cement 2 Cement grout 3 Bentonite 4 Other Grout intervals: From 3 ft. to 13 ft., From ... ft. to ... ft.

What is the nearest source of possible contamination: 1 Septic tank 2 Sewer lines 3 Watertight sewer lines 4 Lateral lines 5 Cess pool 6 Seepage pit 7 Pit privy 8 Sewage lagoon 9 Feedyard 10 Livestock pens 11 Fuel storage 12 Fertilizer storage 13 Insecticide storage 14 Abandoned water well 15 Oil well/Gas well 16 Other (specify below)

Direction from well? EAST How many feet? 125

FROM	TO	LITHOLOGIC LOG	FROM	TO	LITHOLOGIC LOG
<u>0</u>	<u>3</u>	<u>TOPSOIL</u>			
<u>3</u>	<u>45</u>	<u>CLAY - YELLOW</u>			
<u>45</u>	<u>65</u>	<u>SANDY CLAY</u>			
<u>65</u>	<u>85</u>	<u>CLAY - SOME SANDY STREAKS</u>			
<u>85</u>	<u>100</u>	<u>SAND and GRAVEL</u>			
<u>100</u>		<u>SHALE</u>			

7 CONTRACTOR'S OR LANDOWNER'S CERTIFICATION: This water well was (1) constructed (2) reconstructed, or (3) plugged under my jurisdiction and was completed on (mo/day/year) 2-26-88 and this record is true to the best of my knowledge and belief. Kansas Water Well Contractor's License No. 217 This Water Well Record was completed on (mo/day/yr) 3-3-88 under the business name of BRAU DRILLING CO. by (signature) [Signature]

INSTRUCTIONS: Use typewriter or ball point pen, PLEASE PRESS FIRMLY and PRINT clearly. Please fill in blanks, underline or circle the correct answers. Send top three copies to Kansas Department of Health and Environment, Division of Environment, Environmental Geology Section, Topeka, KS 66620. Send one to WATER WELL OWNER and retain one for your records.