

WATER WELL RECORD

Form WWC-5

Division of Water Resources App. No.

25733

1 LOCATION OF WATER WELL: County: Kiowa Fraction 1/4 SE 1/4 SE 1/4 NE 1/4 Section Number 25 Township No. T 28 S Range Number R 20 [ ] E [X] W

Street/Rural Address of Well Location; if unknown, distance & direction from nearest town or intersection: If at owner's address, check here [ ]. 1/4 South, 1 1/2 East of Mullinville Global Positioning System (GPS) information: Latitude: Longitude: Elevation: Datum: [ ] WGS 84, [ ] NAD 83, [ ] NAD 27 Collection Method: [ ] GPS unit (Make/Model: [ ]) [ ] Digital Map/Photo, [ ] Topographic Map, [ ] Land Survey Est. Accuracy: [ ] <3 m, [ ] 3-5 m, [ ] 5-15 m, [ ] >15 m

2 WATER WELL OWNER: Jon Myers RR#, Street Address, Box #: 10090 SW Eastridge Road City, State, ZIP Code : Pratt, KS 67124

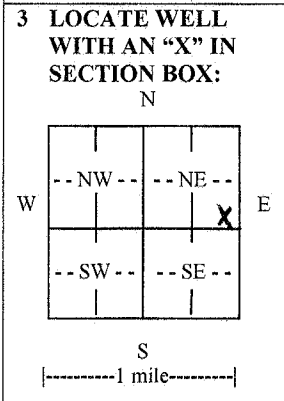

3 LOCATE WELL WITH AN "X" IN SECTION BOX: 4 DEPTH OF COMPLETED WELL 185 ft. Depth(s) Groundwater Encountered (1) 111 ft. (2) ft. (3) ft. WELL'S STATIC WATER LEVEL 111 ft. below land surface measured on mo/day/yr. 4-12-13 Pump test data: Well water was 154 ft. after 3 hours pumping 821 gpm EST. YIELD 892 gpm Well water was 160 ft. after 3 1/2 hours pumping 892 gpm Bore Hole Diameter 26 in. to 185 ft. and in. to ft. WELL WATER TO BE USED AS: [ ] Public water supply [ ] Geothermal [ ] Injection well [ ] Domestic [ ] Feedlot [ ] Oil field water supply [ ] Dewatering [ ] Other (Specify below) [X] Irrigation [ ] Industrial [ ] Domestic-lawn & garden [ ] Monitoring well Was a chemical/bacteriological sample submitted to Department? [ ] Yes [X] No If yes, mo/day/yr sample was submitted Water well disinfected? [X] Yes [ ] No

5 TYPE OF CASING USED: [ ] Steel [X] PVC [ ] Other CASING JOINTS: [X] Glued [ ] Clamped [ ] Welded [ ] Threaded Casing diameter .16 in. to .185 ft., Diameter in. to ft., Diameter in. to ft. Casing height above land surface .18 in., Weight Sch 40 lbs./ft., Wall thickness or gauge No. TYPE OF SCREEN OR PERFORATION MATERIAL: [ ] Steel [ ] Stainless Steel [X] PVC [ ] Other (Specify) [ ] Brass [ ] Galvanized Steel [ ] None used (open hole) SCREEN OR PERFORATION OPENINGS ARE: [ ] Continuous slot [ ] Mill slot [ ] Gauze wrapped [ ] Torch cut [ ] Drilled holes [ ] None (open hole) [ ] Louvered shutter [ ] Key punched [ ] Wire wrapped [X] Saw cut [ ] Other (specify) SCREEN-PERFORATED INTERVALS: From 185 ft. to 145 ft., From ft. to ft. GRAVEL PACK INTERVALS: From 185 ft. to 20 ft., From ft. to ft. From ft. to ft. From ft. to ft.

6 GROUT MATERIAL: [ ] Neat cement [ ] Cement grout [X] Bentonite [ ] Other Grout Intervals: From ft. to ft., From 20 ft. to 0 ft., From ft. to ft. What is the nearest source of possible contamination: [ ] Septic tank [ ] Lateral lines [ ] Pit privy [ ] Livestock pens [ ] Insecticide storage [X] Other (specify below) [ ] Sewer lines [ ] Cesspool [ ] Sewage lagoon [ ] Fuel storage [ ] Abandoned water well [ ] Watertight sewer lines [ ] Seepage pit [ ] Feedyard [ ] Fertilizer storage [ ] Oil well/gas well None Direction from well Distance from well

FROM	TO	LITHOLOGIC LOG	FROM	TO	LITHO. LOG (cont.) or PLUGGING INTERVALS
0	3	Top soil	149	184.5	Sand & gravel- small to med w/ broken & flat rock
3	53	Tan clay			
53	61	Clay, fine sand, & limestone	184/5	185	Yellow clay & shale
61	75	Sandy tan clay			
75	77	Cemented sand			
77	115.5	Sand & gravel- small to med, tight			
115.5	120	Cemented sand- VERY HARD			
120	144	Tan clay w/ streaks of limestone			
144	149	Sandy tan clay w/ broken rock & gravel			

7 CONTRACTOR'S OR LANDOWNER'S CERTIFICATION: This water well was [X] constructed, [ ] reconstructed, or [ ] plugged under my jurisdiction and was completed on (mo/day/year) 4-13-13 and this record is true to the best of my knowledge and belief. Kansas Water Well Contractor's License No. 134 This Water Well Record was completed on (mo/day/year) 5-14-13 under the business name of Rosencrantz- Bemis Ent Inc by (signature) [Signature]

INSTRUCTIONS: Use typewriter or ball point pen. PLEASE PRESS FIRMLY and PRINT clearly. Please fill in blanks and check the correct answers. Send three copies (white, blue, pink) to Kansas Department of Health and Environment, Bureau of Water, Geology Section, 1000 SW Jackson St., Suite 420, Topeka, Kansas 66612-1367. Telephone 785-296-5524. Send one copy to WATER WELL OWNER and retain one for your records. Include fee of \$5.00 for each constructed well. Visit us at http://www.kdheks.gov/waterwell/index.html.