

**WATER WELL RECORD Form WWC-5**

Division of Water Resources App. No.                      Well ID                     

Original Record     Correction     Change in Well Use

**1 LOCATION OF WATER WELL:**  
 County: Gray    Fraction SE 1/4 SE 1/4 SE 1/4 SE 1/4    Section Number 30    Township Number T 28 S    Range Number R 27 E W

**2 WELL OWNER:** Last Name: Glassco    First: Scott  
 Business Address: PO Box 82  
 Address:                       
 City: Montezuma    State: KS    ZIP: 67867  
 Street or Rural Address where well is located (if unknown, distance and direction from nearest town or intersection): Intersection County Rd 20 & FF 3/4 Mile south

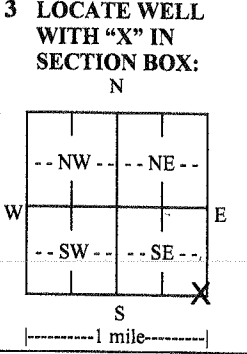

**4 DEPTH OF COMPLETED WELL:** 305 ft.  
 Depth(s) Groundwater Encountered: 1) 180 ft.    2)                      ft.    3)                      ft., or 4)  Dry Well  
 WELL'S STATIC WATER LEVEL: 142 ft.  
 below land surface, measured on (mo-day-yr) 10/27/2015  
 above land surface, measured on (mo-day-yr)                       
 Pump test data: Well water was                      ft. after                      hours pumping                      gpm  
 Well water was                      ft. after                      hours pumping                      gpm  
 Estimated Yield: 20 gpm  
 Bore Hole Diameter: 10 in. to 305 ft. and                      in. to                      ft.

**5 Latitude:** 37.577226 (decimal degrees)  
**Longitude:** 100.307736 (decimal degrees)  
 Datum:  WGS 84     NAD 83     NAD 27  
 Source for Latitude/Longitude:  
 GPS (unit make/model:                     ) (WAAS enabled?  Yes  No)  
 Land Survey     Topographic Map  
 Online Mapper:                     

**6 Elevation:** 2742 ft.     Ground Level     TOC  
 Source:  Land Survey     GPS     Topographic Map  
 Other: KOLAR

**7 WELL WATER TO BE USED AS:**

1. Domestic: <input type="checkbox"/> Household <input type="checkbox"/> Lawn & Garden <input checked="" type="checkbox"/> Livestock	2. <input type="checkbox"/> Irrigation	3. <input type="checkbox"/> Feedlot	4. <input type="checkbox"/> Industrial	5. <input type="checkbox"/> Public Water Supply: well ID <u>                    </u>	6. <input type="checkbox"/> Dewatering: how many wells? <u>                    </u>	7. <input type="checkbox"/> Aquifer Recharge: well ID <u>                    </u>	8. <input type="checkbox"/> Monitoring: well ID <u>                    </u>	9. Environmental Remediation: well ID <u>                    </u> <input type="checkbox"/> Air Sparge <input type="checkbox"/> Soil Vapor Extraction <input type="checkbox"/> Recovery <input type="checkbox"/> Injection	10. <input type="checkbox"/> Oil Field Water Supply: lease <u>                    </u>	11. Test Hole: well ID <u>                    </u> <input type="checkbox"/> Cased <input type="checkbox"/> Uncased <input type="checkbox"/> Geotechnical	12. Geothermal: how many bores? <u>                    </u> a) Closed Loop <input type="checkbox"/> Horizontal <input type="checkbox"/> Vertical b) Open Loop <input type="checkbox"/> Surface Discharge <input type="checkbox"/> Inj. of Water	13. <input type="checkbox"/> Other (specify): <u>                    </u>
---	--	-------------------------------------	--	--	---	---	---	---	--	---	---	---

Was a chemical/bacteriological sample submitted to KDHE?  Yes     No    If yes, date sample was submitted:                       
 Water well disinfected?  Yes     No

**8 TYPE OF CASING USED:**  Steel     PVC     Other                         CASING JOINTS:  Glued     Clamped     Welded     Threaded  
 Casing diameter 5 in. to 305 ft., Diameter                      in. to                      ft., Diameter                      in. to                      ft.  
 Casing height above land surface 12 in.    Weight                      lbs./ft.    Wall thickness or gauge No. SDR17  
 TYPE OF SCREEN OR PERFORATION MATERIAL:  
 Steel     Stainless Steel     Fiberglass     PVC     Other (Specify)                       
 Brass     Galvanized Steel     Concrete tile     None used (open hole)  
 SCREEN OR PERFORATION OPENINGS ARE:  
 Continuous Slot     Mill Slot     Gauze Wrapped     Torch Cut     Drilled Holes     Other (Specify)                       
 Louvered Shutter     Key Punched     Wire Wrapped     Saw Cut     None (Open Hole)  
 SCREEN-PERFORATED INTERVALS: From 180 ft. to 300 ft., From                      ft. to                      ft., From                      ft. to                      ft.  
 GRAVEL PACK INTERVALS: From 40 ft. to 300 ft., From                      ft. to                      ft., From                      ft. to                      ft.

**9 GROUT MATERIAL:**  Neat cement     Cement grout     Bentonite     Other                       
 Grout Intervals: From 0 ft. to 40 ft., From                      ft. to                      ft., From                      ft. to                      ft.  
 Nearest source of possible contamination:  
 Septic Tank     Lateral Lines     Pit Privy     Livestock Pens     Insecticide Storage  
 Sewer Lines     Cess Pool     Sewage Lagoon     Fuel Storage     Abandoned Water Well  
 Watertight Sewer Lines     Seepage Pit     Feedyard     Fertilizer Storage     Oil Well/Gas Well  
 Other (Specify)                       
 Direction from well?                         Distance from well?                      ft.

10 FROM	TO	LITHOLOGIC LOG	FROM	TO	LITHO. LOG (cont.) or PLUGGING INTERVALS
0	10	TOP SOIL, FINE MED SAND, BROWN CLAY	200	220	TAN SANDSTONE, GRAY CLAY
10	40	FINE SAND, WHITE CLAY, WHITE CALK	220	240	GRAY SANDSTONE, GRAY CLAY
		WITH WHITE ROCK LAYERS	240	280	GRAY CLAY WITH GRAY SANDSTONE
40	60	BLUE SHALE	280	300	GRAY SANDSTONE, GRAY CLAY
60	140	BLUE SHALE WITH GRAY CLAY STREA	300	320	GRAY CLAY, GRAY SANDSTONE
140	160	BLUE CLAY			
160	180	GRAY CLAY WITH SANDSTONE STREA			
180	200	GRAY SANDSTONE WITH GRAY CLAY STREAKS			

**11 CONTRACTOR'S OR LANDOWNER'S CERTIFICATION:** This water well was  constructed,  reconstructed, or  plugged under my jurisdiction and was completed on (mo-day-year) 10/27/2015 and this record is true to the best of my knowledge and belief. Kansas Water Well Contractor's License No. 846 This Water Well Record was completed on (mo-day-year) 11/02/2015 under the business name of Nash Water Well Service, LLC