

WATER WELL RECORD

Form WWC-5

Division of Water Resources App. No.

1 LOCATION OF WATER WELL: County: <u>Gray</u>	Fraction <u>NE 1/4 NE 1/4 SE 1/4 SW 1/4</u>	Section Number <u>10</u>	Township No. T <u>28</u> S	Range Number R <u>29</u> <input type="checkbox"/> E <input checked="" type="checkbox"/> W
---	--	-----------------------------	-------------------------------	--

Street/Rural Address of Well Location; if unknown, distance & direction from nearest town or intersection: If at owner's address, check here **Global Positioning System (GPS) information:**
 Latitude: (in decimal degrees)
 Longitude: (in decimal degrees)
 Elevation:
 Datum: WGS 84, NAD 83, NAD 27
 Collection Method:
 GPS unit (Make/Model:)
 Digital Map/Photo, Topographic Map, Land Survey
 Est. Accuracy: <3 m, 3-5 m, 5-15 m, >15 m

2 WATER WELL OWNER: Montezuma Mennonite Church
 RR#, Street Address, Box #: 11506 AA Rd.
 City, State, ZIP Code : Montecuma, Ks. 67867

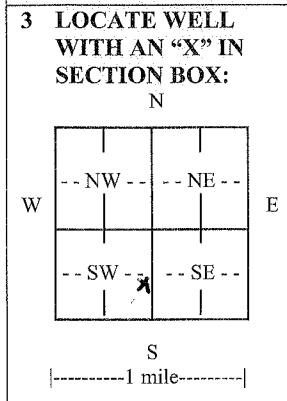

4 DEPTH OF COMPLETED WELL 485' ft.
 Depth(s) Groundwater Encountered (1)..... ft. (2)..... ft. (3)..... ft.
 WELL'S STATIC WATER LEVEL..... 280 ft. below land surface measured on mo/day/yr..... 11/20/12
 Pump test data: Well water was.....ft. after..... hours pumping..... gpm
 EST. YIELD.....gpm. Well water was.....ft. after..... hours pumping..... gpm
 Bore Hole Diameter 7 7/8 in. toft., andin. toft.
 WELL WATER TO BE USED AS: Public water supply Geothermal Injection well
 Domestic Feedlot Oil field water supply Dewatering Other (Specify below)
 Irrigation Industrial Domestic-lawn & garden Monitoring well
 Was a chemical/bacteriological sample submitted to Department? Yes No
 If yes, mo/day/yr sample was submitted.....
 Water well disinfected? Yes No

5 TYPE OF CASING USED: Steel PVC Other
 CASING JOINTS: Glued Clamped Welded Threaded
 Casing diameter 5 in. to 485 ft., Diameter in. to ft., Diameter in. to ft.
 Casing height above land surface..... 12 in., Weightlbs./ft., Wall thickness or gauge No. SAR 21
 TYPE OF SCREEN OR PERFORATION MATERIAL:
 Steel Stainless Steel PVC Other (Specify)
 Brass Galvanized Steel None used (open hole)
 SCREEN OR PERFORATION OPENINGS ARE:
 Continuous slot Mill slot Gauze wrapped Torch cut Drilled holes None (open hole)
 Louvered shutter Key punched Wire wrapped Saw cut Other (specify)
 SCREEN-PERFORATED INTERVALS: From..... 385 ft. to 485 ft., From ft. to ft.
 From..... ft. to ft., From ft. to ft.
 GRAVEL PACK INTERVALS: From..... 24 ft. to 285 ft., From 295 ft. to 485 ft.
 From..... ft. to ft., From ft. to ft.

6 GROUT MATERIAL: Neat cement Cement grout Bentonite Other
 Grout Intervals: From..... 4 ft. to 24 ft., From 285 ft. to 295 ft., From ft. to ft.
 What is the nearest source of possible contamination:
 Septic tank Lateral lines Pit privy Livestock pens Insecticide storage Other (specify below)
 Sewer lines Cesspool Sewage lagoon Fuel storage Abandoned water well
 Watertight sewer lines Seepage pit Feedyard Fertilizer storage Oil well/gas well Southwest
 Direction from well Southwest Distance from well 20

FROM	TO	LITHOLOGIC LOG	FROM	TO	LITHO. LOG (cont.) or PLUGGING INTERVALS
0	32	Tan clay	475	545	Sandstone
32	37	Fine sand			
37	163	Tan sandy clay			
163	179	med. sand			
179	212	white clay			
212	310	Shale			
310	350	Sandstone			
350	375	Shale			
375	470	Shale & sandstone layers			
470	475	Red clay			

7 CONTRACTOR'S OR LANDOWNER'S CERTIFICATION: This water well was constructed, reconstructed, or plugged under my jurisdiction and was completed on (mo/day/year) 11/20/12 and this record is true to the best of my knowledge and belief.
 Kansas Water Well Contractor's License No. 533 This Water Well Record was completed on (mo/day/year) 10/4/13
 under the business name of Tan Teem Water Well by (signature) [Signature]

INSTRUCTIONS: Use typewriter or ball point pen. PLEASE PRESS FIRMLY and PRINT clearly. Please fill in blanks and check the correct answers. Send three copies (white, blue, pink) to Kansas Department of Health and Environment, Bureau of Water, Geology Section, 1000 SW Jackson St., Suite 420, Topeka, Kansas 66612-1367. Telephone 785-296-5524. Send one copy to WATER WELL OWNER and retain one for your records. Include fee of \$5.00 for each constructed well. Visit us at <http://www.kdheks.gov/waterwell/index.html>.