

WATER WELL RECORD

Form WWC-5

Division of Water Resources App. No.

12,148

1 LOCATION OF WATER WELL: County: GRAY	Fraction ¼ NW ¼ NE ¼ SE ¼	Section Number 18	Township No. T 28 S	Range Number R 30 <input type="checkbox"/> E <input checked="" type="checkbox"/> W
--	------------------------------	----------------------	------------------------	---

Street/Rural Address of Well Location; if unknown, distance & direction from nearest town or intersection: If at owner's address, check here .
APPROX 5 MILE NORTH AND 1 MILE WEST OF COPELAND KANSAS

Global Positioning System (GPS) information:
 Latitude: 37.61292 N..... (in decimal degrees)
 Longitude: 100.63751 W..... (in decimal degrees)
 Elevation:
 Datum: WGS 84, NAD 83, NAD 27
 Collection Method:
 GPS unit (Make/Model:)
 Digital Map/Photo, Topographic Map, Land Survey
 Est. Accuracy: <3 m, 3-5 m, 5-15 m, >15 m

2 WATER WELL OWNER: DAVID LOUCKS
 RR#, Street Address, Box #: 28104 2 ROAD
 City, State, ZIP Code : COPELAND KS 67837

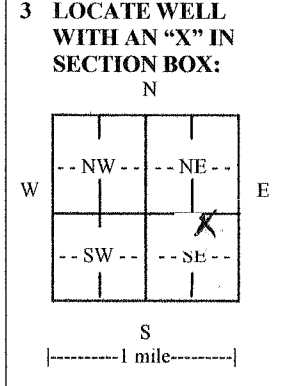

4 DEPTH OF COMPLETED WELL 511..... ft.
 Depth(s) Groundwater Encountered (1)..... ft. (2)..... ft. (3)..... ft.
 WELL'S STATIC WATER LEVEL 238..... ft. below land surface measured on mo/day/yr. 12-28-201.....
 Pump test data: Well water was 350.....ft. after 4.5..... hours pumping 1329..... gpm
 EST. YIELD.....gpm. Well water was.....ft. after..... hours pumping..... gpm
 Bore Hole Diameter 24.....in. to 511.....ft., andin. toft.
 WELL WATER TO BE USED AS: Public water supply Geothermal Injection well
 Domestic Feedlot Oil field water supply Dewatering Other (Specify below)
 Irrigation Industrial Domestic-lawn & garden Monitoring well
 Was a chemical/bacteriological sample submitted to Department? Yes No
 If yes, mo/day/yr sample was submitted.....
 Water well disinfected? Yes No

5 TYPE OF CASING USED: Steel PVC Other
 CASING JOINTS: Glued Clamped Welded Threaded
 Casing diameter .16..... in. to 511..... ft., Diameter in. to ft., Diameter in. to ft.
 Casing height above land surface 12..... in., Weight 42.09.....lbs./ft., Wall thickness or gauge No. 250.....
 TYPE OF SCREEN OR PERFORATION MATERIAL:
 Steel Stainless Steel PVC Other (Specify)
 Brass Galvanized Steel None used (open hole)
 SCREEN OR PERFORATION OPENINGS ARE:
 Continuous slot Mill slot Gauze wrapped Torch cut Drilled holes None (open hole)
 Louvered shutter Key punched Wire wrapped Saw cut Other (specify)
 SCREEN-PERFORATED INTERVALS: From 245..... ft. to 285..... ft., From 346..... ft. to 506..... ft.
 From..... ft. to ft., From..... ft. to ft.
 GRAVEL PACK INTERVALS: From 20..... ft. to 255..... ft., From 255..... ft. to 511..... ft.
 From..... ft. to ft., From..... ft. to ft.

6 GROUT MATERIAL: Neat cement Cement grout Bentonite Other
 Grout Intervals: From 0..... ft. to 20..... ft., From..... ft. to ft., From..... ft. toft.
 What is the nearest source of possible contamination:
 Septic tank Lateral lines Pit privy Livestock pens Insecticide storage Other (specify below)
 Sewer lines Cesspool Sewage lagoon Fuel storage Abandoned water well
 Watertight sewer lines Seepage pit Feedyard Fertilizer storage Oil well/gas well
 Direction from well WEST & NORTH..... Distance from well 91' & 34'.....

FROM	TO	LITHOLOGIC LOG	FROM	TO	LITHO. LOG (cont.) or PLUGGING INTERVALS
0	2	SURFACE	382	395	SAND, SILTY TO SMALL
2	95	BROWN CLAY, CALICHE FINE SAND	395	409	SAND, SILTY TO SMALL
95	114	FINE SAND, CLAY	409	423	SANDSTONE
114	134	BROWN GREY CLAY, LIMEROCK	423	460	SOAPSTONE, SANDSTONE
134	200	SAND, FINE TO MED, ROCK	460	485	SOAPSTONE, SOME SANDSTONE, LIMESTO
200	260	SAND, FINE TO MED, SM GRV, CL LED	485	491	SOAPSTONE, LIMESTONE, SHALE
260	271	SAND, FINE, SMALL CLAY	491	506	SHALE, SANDSTONE,
271	340	BROWN CLAY, LIMEROCK	506	513	SHALE, SOAPSTONE
340	360	SAND, SILTY TO FINE, THIN CLAY	513	530	SHALE, LIMESTONE
360	382	SAND, SILTYFINE, SMALL THIN CLAY			

7 CONTRACTOR'S OR LANDOWNER'S CERTIFICATION: This water well was constructed, reconstructed, or plugged under my jurisdiction and was completed on (mo/day/year) and this record is true to the best of my knowledge and belief.
 Kansas Water Well Contractor's License No. 145..... This Water Well Record was completed on (mo/day/year) 1/15/12.....
 under the business name of HYDRO RESOURCES..... by (signature) *David Loucks*.....

INSTRUCTIONS: Use typewriter or ball point pen. PLEASE PRESS FIRMLY and PRINT clearly. Please fill in blanks and check the correct answers. Send three copies (white, blue, pink) to Kansas Department of Health and Environment, Bureau of Water, Geology Section, 1000 SW Jackson St., Suite 420, Topeka, Kansas 66612-1367. Telephone 785-296-5522. Send one copy to WATER WELL OWNER and retain one for your records. Include fee of \$5.00 for each constructed well. Visit us at <http://www.kdheks.gov/waterwell/index.html>.