

WATER WELL RECORD

Form WWC-5

Division of Water Resources App. No.

1 LOCATION OF WATER WELL: County: HASKELL	Fraction ¼ NW ¼ NW ¼ SE ¼	Section Number 1	Township No. T 28 S	Range Number R 31 <input type="checkbox"/> E <input checked="" type="checkbox"/> W
---	------------------------------	---------------------	------------------------	---

Street/Rural Address of Well Location; if unknown, distance & direction from nearest town or intersection: If at owner's address, check here .
 SUBLETTE-10 M. NE ON HWY 56 TO COUNTY LINE, 6-3/4 M. N. 2,300 FT. NORTH & 2,580 FT. WEST

Global Positioning System (GPS) information:
 Latitude: ...37.64104... (in decimal degrees)
 Longitude: ...100.66113... (in decimal degrees)
 Elevation:
 Datum: WGS 84, NAD 83, NAD 27
 Collection Method:
 GPS unit (Make/Model: GARMIN 62ST.....)
 Digital Map/Photo, Topographic Map, Land Survey
 Est. Accuracy: <3 m, 3-5 m, 5-15 m, >15 m

2 WATER WELL OWNER: DON & JEWEL NIGHTINGALE & ***
 RR#, Street Address, Box #: 759 YY ROAD
 City, State, ZIP Code : COPELAND, KANSAS 67837

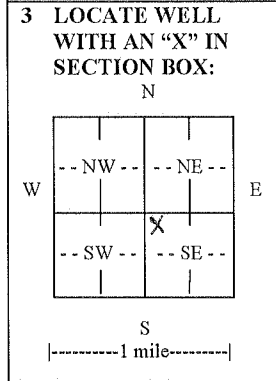

4 DEPTH OF COMPLETED WELL ... 520 ft.

Depth(s) Groundwater Encountered (1)..... ft. (2)..... ft. (3)..... ft.

WELL'S STATIC WATER LEVEL..... ft. below land surface measured on mo/day/yr.....

Pump test data: Well water was.....ft. after..... hours pumping..... gpm
 EST. YIELD.....gpm. Well water was.....ft. after..... hours pumping..... gpm

Bore Hole Diameter .30.....in. to .520.....ft., andin. toft.

WELL WATER TO BE USED AS: Public water supply Geothermal Injection well
 Domestic Feedlot Oil field water supply Dewatering Other (Specify below)
 Irrigation Industrial Domestic-lawn & garden Monitoring well

Was a chemical/bacteriological sample submitted to Department? Yes No

If yes, mo/day/yr sample was submitted.....

Water well disinfected? Yes No

5 TYPE OF CASING USED: Steel PVC Other

CASING JOINTS: Glued Clamped Welded Threaded

Casing diameter ...16..... in. to ...330..... ft., Diameter in. to ft., Diameter in. to ft.
 Casing height above land surface...12..... in., Weight .42.05.....lbs./ft., Wall thickness or gauge No. ...250.....

TYPE OF SCREEN OR PERFORATION MATERIAL:
 Steel Stainless Steel PVC Other (Specify)
 Brass Galvanized Steel None used (open hole)

SCREEN OR PERFORATION OPENINGS ARE:
 Continuous slot Mill slot Gauze wrapped Torch cut Drilled holes None (open hole)
 Louvered shutter Key punched Wire wrapped Saw cut Other (specify)

SCREEN-PERFORATED INTERVALS: From...330..... ft. to ...520..... ft., From ft. to ft.
 From..... ft. to ft., From ft. to ft.

GRAVEL PACK INTERVALS: From...20..... ft. to ...260..... ft., From 320..... ft. to 520..... ft.
 From..... ft. to ft., From ft. to ft.

6 GROUT MATERIAL: Neat cement Cement grout Bentonite Other

Grout Intervals: From ...0..... ft. to ...20..... ft., From 260..... ft. to 320..... ft., From ft. to ft.

What is the nearest source of possible contamination:
 Septic tank Lateral lines Pit privy Livestock pens Insecticide storage Other (specify below)
 Sewer lines Cesspool Sewage lagoon Fuel storage Abandoned water well
 Watertight sewer lines Seepage pit Feedyard Fertilizer storage Oil well/gas well

Direction from well EAST..... Distance from well ...280.FT.....

FROM	TO	LITHOLOGIC LOG	FROM	TO	LITHO. LOG (cont.) or PLUGGING INTERVALS
		SEE ATTACHED LOG			
		*** CIRCLE N TRUST & EMERY F. JOSSERAND LLC C/O DON NIGHTINGALE 759 YY ROAD COPELAND, KANSAS 67837			

7 CONTRACTOR'S OR LANDOWNER'S CERTIFICATION: This water well was constructed, reconstructed, or plugged under my jurisdiction and was completed on (mo/day/year) ..3-28-12..... and this record is true to the best of my knowledge and belief. Kansas Water Well Contractor's License No. 208..... This Water Well Record was completed on (mo/day/year) ..4-11-12..... under the business name of ..MINTER-WILSON DRILLING CO., INC..... by (signature) *Nara Kellers*.....

INSTRUCTIONS: Use typewriter or ball point pen. PLEASE PRESS FIRMLY and PRINT clearly. Please fill in blanks and check the correct answers. Send three copies (white, blue, pink) to Kansas Department of Health and Environment, Bureau of Water, Geology Section, 1000 SW Jackson St., Suite 420, Topeka, Kansas 666 12-1367. Telephone 785-296-5524. Send one copy to WATER WELL OWNER and retain one for your records. I include fee of \$5.00 for each constructed well. Visit us at <http://www.kdheks.gov/waterwell/index.html>.

The
Professionals

MINTER-WILSON DRILLING CO.

INCORPORATED

Irrigation
and Domestic
Water Systems
Complete Installation
and Repairing

Phone 620-276-8269 • P.O. Box A • GARDEN CITY, KANSAS 67846

NAME DON NIGHTINGALE
COUNTY HASKELL
DATE 1-25-12

LOCATION: E 1/2 1-28-31 - FROM SALEM CHURCH - 1-1/2 MILES EAST &
1/2 MILE SOUTH
- 345 FT. SOUTH OF EXISTING WELL

STATIC WATER LEVEL - APPROX. 300 FT.

TEST # 2

0' TO 1' - TOP SOIL
1' TO 48' - BROWN SANDY CLAY
48' TO 80' - FINE TO MEDIUM SAND
80' TO 95' - BROWN SANDY CLAY WITH LAYERS OF FINE SAND
95' TO 135' - GRAY CLAY WITH STRIPS OF WHITE ROCK
135' TO 153' - FINE TO MEDIUM SAND & GRAVEL
153' TO 168' - BROWN SANDY CLAY
168' TO 197' - FINE TO MEDIUM SAND & GRAVEL
197' TO 203' - BROWN SANDY CLAY
203' TO 242' - FINE TO MEDIUM SAND & GRAVEL
242' TO 248' - BROWN SANDY CLAY
248' TO 285' - FINE TO MEDIUM SAND & GRAVEL
285' TO 292' - BROWN SANDY CLAY
292' TO 302' - FINE TO MEDIUM SAND & GRAVEL
302' TO 306' - BROWN SANDY CLAY
306' TO 316' - FINE TO MEDIUM SAND & GRAVEL
316' TO 326' - BROWN SANDY CLAY
326' TO 335' - FINE TO MEDIUM SAND WITH STRIPS OF BROWN SANDY CLAY - 25%
335' TO 354' - BROWN SANDY CLAY WITH STRIPS OF SAND - 10%
354' TO 358' - FINE TO MEDIUM SAND
358' TO 376' - BROWN SANDY CLAY
376' TO 383' - FINE TO MEDIUM SAND
383' TO 390' - BROWN SANDY & WHITE CLAY WITH STRIPS OF SAND - 15%
390' TO 415' - BROWN SANDY CLAY
415' TO 440' - BROWN CLAY
440' TO 466' - BROWN SANDY CLAY & FINE TO MEDIUM SAND MIXED - 50/50
466' TO 494' - FINE TO MEDIUM SAND & GRAVEL WITH 15% BROWN ROCK
494' TO 500' - BROWN SANDY CLAY
500' TO 510' - BROWN, YELLOW & WHITE CLAY WITH 40% BROWN ROCK
510' TO 526' - HARD BROWN, YELLOW & WHITE CLAY WITH 15% BROWN ROCK
526' TO 543' - SHALE - 250 PULL DOWN
543' - HARD ROCK - 700 PULL DOWN