

WATER WELL RECORD Form WWC-5

Original Record Correction Change in Well Use

Division of Water Resources App. No.

Well ID MW12

1 LOCATION OF WATER WELL: County: Grant	Fraction NE ¼ SE ¼ NE ¼ NE ¼	Section Number 34	Township Number T 28 S	Range Number R 37 <input type="checkbox"/> E <input checked="" type="checkbox"/> W
---	---------------------------------	----------------------	---------------------------	---

2 WELL OWNER: Last Name: J & J Oil Business: J & J Oil Address: 820 E. Oklahoma Address: City: Ulysses State: KS ZIP: 67880	First: Street or Rural Address where well is located (if unknown, distance and direction from nearest town or intersection): If at owner's address, check here: <input type="checkbox"/> South side of E Texas Ave between S Cheyenne St and S Rd K Ulysses, KS
--	---

3 LOCATE WELL WITH "X" IN SECTION BOX:

N

NW	NE
SW	SE

S

-----1 mile-----

4 DEPTH OF COMPLETED WELL: 70 ft.

Depth(s) Groundwater Encountered: 1) 62 ft.
2) ft. 3) ft., or 4) Dry Well

WELL'S STATIC WATER LEVEL: ft.
 below land surface, measured on (mo-day-yr) 6-2-18
 above land surface, measured on (mo-day-yr)

Pump test data: Well water was ft.
after hours pumping gpm
Well water was ft.
after hours pumping gpm

Estimated Yield: gpm
Bore Hole Diameter: 8.5 in. to 70 ft. and
..... in. to ft.

5 Latitude: 37.57479 (decimal degrees)
Longitude: 101.34552 (decimal degrees)
Horizontal Datum: WGS 84 NAD 83 NAD 27
Source for Latitude/Longitude:
 GPS (unit make/model:)
(WAAS enabled? Yes No)
 Land Survey Topographic Map
 Online Mapper:

6 Elevation: 3039.25 ft. Ground Level TOC
Source: Land Survey GPS Topographic Map
 Other

7 WELL WATER TO BE USED AS:

1. Domestic: <input type="checkbox"/> Household <input type="checkbox"/> Lawn & Garden <input type="checkbox"/> Livestock	5. <input type="checkbox"/> Public Water Supply: well ID 6. <input type="checkbox"/> Dewatering: how many wells? 7. <input type="checkbox"/> Aquifer Recharge: well ID 8. <input checked="" type="checkbox"/> Monitoring: well ID MW12	10. <input type="checkbox"/> Oil Field Water Supply: lease 11. Test Hole: well ID <input type="checkbox"/> Cased <input type="checkbox"/> Uncased <input type="checkbox"/> Geotechnical
2. <input type="checkbox"/> Irrigation 3. <input type="checkbox"/> Feedlot 4. <input type="checkbox"/> Industrial	9. Environmental Remediation: well ID <input type="checkbox"/> Air Sparge <input type="checkbox"/> Soil Vapor Extraction <input type="checkbox"/> Recovery <input type="checkbox"/> Injection	12. Geothermal: how many bores? a) Closed Loop <input type="checkbox"/> Horizontal <input type="checkbox"/> Vertical b) Open Loop <input type="checkbox"/> Surface Discharge <input type="checkbox"/> Inj. of Water 13. <input type="checkbox"/> Other (specify):

Was a chemical/bacteriological sample submitted to KDHE? Yes No If yes, date sample was submitted:

Water well disinfected? Yes No

8 TYPE OF CASING USED: Steel PVC Other **CASING JOINTS:** Glued Clamped Welded Threaded

Casing diameter 2 in. to 70 ft., Diameter in. to ft., Diameter in. to ft.
Casing height above land surface in. Weight lbs./ft. Wall thickness or gauge No. Sch 40

TYPE OF SCREEN OR PERFORATION MATERIAL:
 Steel Stainless Steel Fiberglass PVC Other (Specify)

Brass Galvanized Steel Concrete tile None used (open hole)

SCREEN OR PERFORATION OPENINGS ARE:
 Continuous Slot Mill Slot Gauze Wrapped Torch Cut Drilled Holes Other (Specify)

Louvered Shutter Key Punched Wire Wrapped Saw Cut None (Open Hole)

SCREEN-PERFORATED INTERVALS: From 50 ft. to 70 ft., From ft. to ft., From ft. to ft.
GRAVEL PACK INTERVALS: From 48 ft. to 70 ft., From ft. to ft., From ft. to ft.

9 GROUT MATERIAL: Neat cement Cement grout Bentonite Other Concrete Surface Completion 0-1

Grout Intervals: From 0 ft. to 1 ft., From 1 ft. to 46 ft., From 46 ft. to 48 ft.

Nearest source of possible contamination:
 Septic Tank Lateral Lines Pit Privy Livestock Pens Insecticide Storage
 Sewer Lines Cess Pool Sewage Lagoon Fuel Storage Abandoned Water Well
 Watertight Sewer Lines Seepage Pit Feedyard Fertilizer Storage Oil Well/Gas Well
 Other (Specify)

Direction from well? Distance from well? ft.

10 FROM	TO	LITHOLOGIC LOG	FROM	TO	LITHO. LOG (cont.) or PLUGGING INTERVALS
0	0.5	Topsoil			
0.5	18	Silty Sand (SM), light brown			
18	56	Silty Clay (CL) light brown			
56	62	Clayey Sand(SC) brown			
62	70	Sand (SW) brown			
Notes:					

11 CONTRACTOR'S OR LANDOWNER'S CERTIFICATION: This water well was constructed, reconstructed, or plugged under my jurisdiction and was completed on (mo-day-year) 5/22/18 and this record is true to the best of my knowledge and belief. Kansas Water Well Contractor's License No. 585 This Water Well Record was completed on (mo-day-year) 6/20/18 under the business name of Associated Environmental, Inc. Signature *[Signature]*

Grant
34-28-37

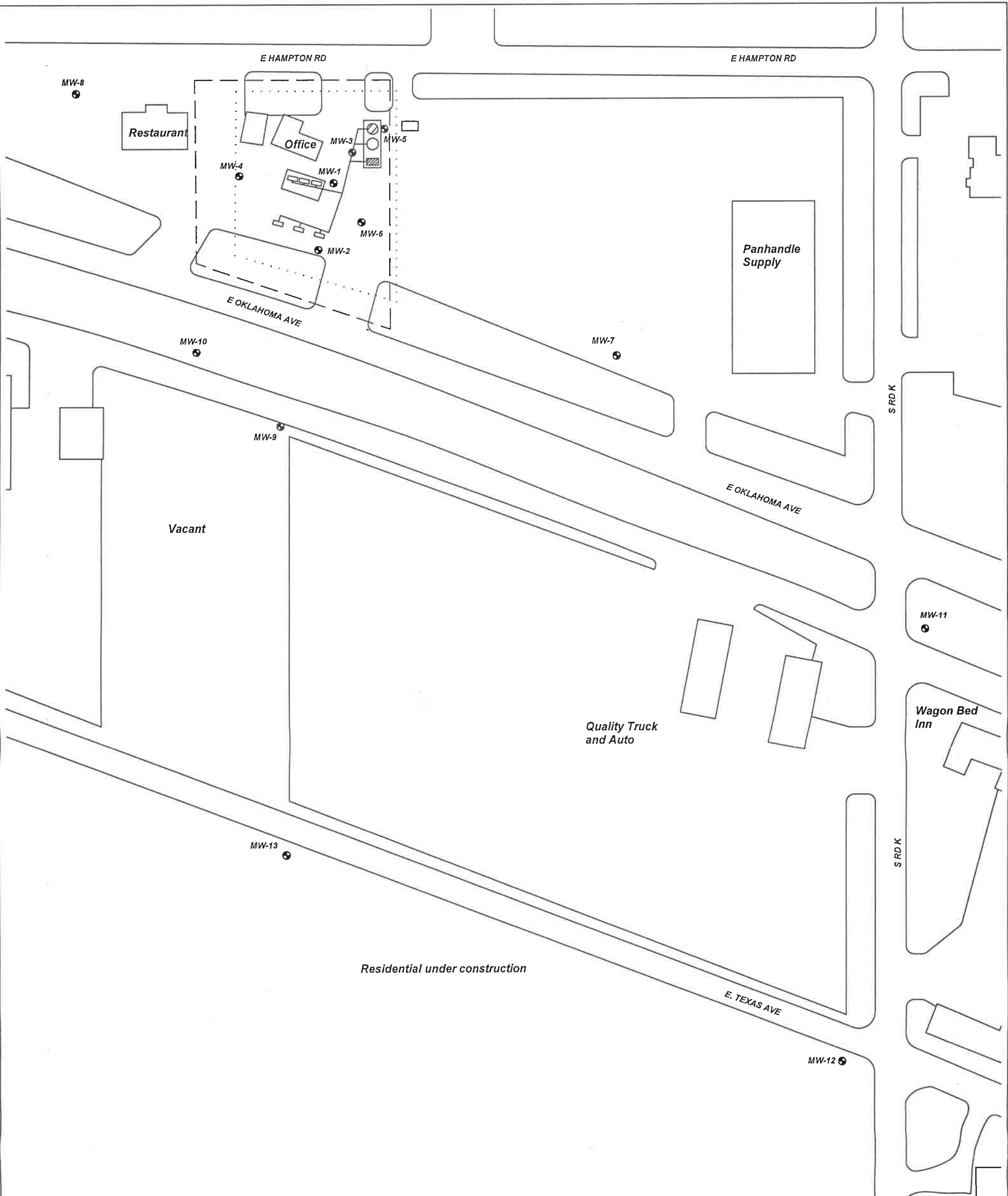

PROJECT: J-J OIL COMPANY
ADDRESS: 820 E. OKLAHOMA AVE.
LOCATION: ULYSSES, KS
DRAWN BY: B. STALNAKER **DATE:** 6/27/18
REVISED BY: B. Johnson **DATE:** 8/1/18
AEI JOB #: TF221 **KDHE JOB #:** A103440036

TITLE: **FIGURE 2.3**
AREA BASE MAP
500' RADIUS

ASSOCIATED ENVIRONMENTAL INC.

LEGEND:

- = 12,000 GAL GASOLINE AST
- = 10,000 GAL DIESEL AST
- = 4,000 GAL DIESEL AST
- = PUMP ISLANDS AND LINES
- = MONITORING WELL
- = SUBJECT PROPERTY

SCALE: 1" = 100'

NOTES:
 No basements observed within 500'.
 Sample Date: 7/2/18

