

USE TYPEWRITER OR BALL POINT PEN-PRESS FIRMLY, PRINT CLEARLY.

T R EW sec 1/4 1/4 1/4 No.

WATER WELL RECORD
KSA 82a-1201-1215

Kansas State Dept. Of Health
(Water Well Contractors)
Forbes-Bldg. 740
Topeka, Kansas 66620

1 Location of well:	County Stanton	Township name	Fraction Sw1/4Sw1/4Sw1/4	Section number 4	Town number T285	Range number R39W
---------------------	--------------------------	---------------	------------------------------------	----------------------------	----------------------------	-----------------------------

Distance and direction from nearest town or city:
1 North, 2 West and 4 North of Big Bow
Street address of well location if in city:

3 Owner of well:
Roger Hurst
Address:
Big Bow, Kansas

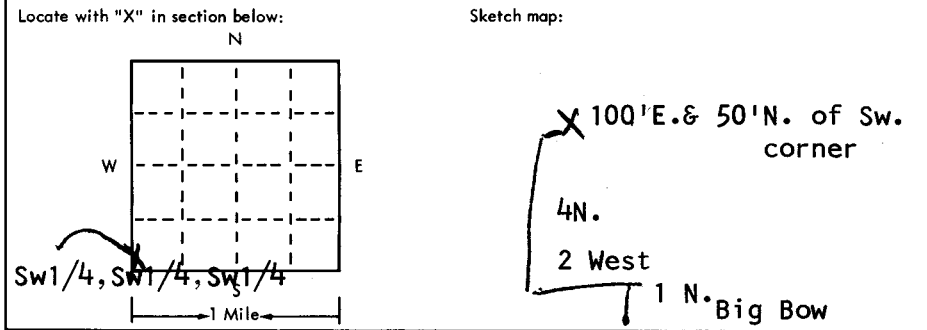

4 Well depth: 626 ft. Date of completion: 5-18-75
Well diameter 26 in.

5 Cable tool Rotary Driven Dug
 Hollow rod Jetted Bored Reverse rotary

6 Use: Domestic Public supply Industry
 Irrigation Air conditioning Commercial
 Test well

7 Casing: Material steel Height: above/below _____
Threaded Welded Surface 12 in.
Diam. _____ Weight 34.25 lbs./ft.
16 in. to 626 ft. depth Drive shoe? Yes No
_____ in. to _____ ft. depth!

2	Type and color of material	From	To
	Surface and Brown Clay	0	30
	Sand-	30	45
	Brown Clay	45	135
	Sand and Brown Sandy Clay	135	195
	Sand: Medium Coarse 195	195	240
	Brown Sandy Clay 30%	240	270
	Brown Clay, Red Clay, Gyp and Yellow Clay	270	325
	Dakota-(loose)	325	330
	Brown clay and some sandstone	330	345
	Blue shale-	345	490
	White Dakota	490	525
	Dakota, Blue and brown shale, some cheyenne	525	540
	White sandstone (loose)	540	615
	White sandstone, Brown dakota-	615	625
	Red Bed-	625	630

8 Screen:
Manufacturer Johnson
Type Galvanized Dia. 16 1/2 inches
Slot/gauze 100x100 Length 40 ft.
Set between 565 ft. and 605 ft.
* Fittings: See remarks
Gravel pack Yes No Size range of material 1/2 down

9 Static water level:
136 ft. below land surface Date 5/6/75

10 Pumping level below land surfaces:
380 ft. after 24 hrs. pumping 800 g.p.m.
_____ ft. after _____ hrs. pumping _____ g.p.m.
Estimated maximum yield 1000 g.p.m.

11 Water sample submitted:
 Yes No Date _____

12 Well head completion:
 Pitless adapter 12 Inches above grade

13 Well grouted? Yes No
 Neat cement Bentonite
Depth: From 0 ft. to 10 ft.

14 Nearest source of possible contamination: 1 1/2 Field
ft. _____ Direction None Type _____
Well disinfected upon completion? Yes No

15 Pump: Not installed
Manufacturer's name Goulds
Model number 121 HP 150 Volts _____
Length of drop pipe 500 ft. capacity 800 g.p.m.
Type:
 Submersible Turbine
 Jet Reciprocating
 Centrifugal Other

16 Remarks: elevation **Drilling Sub contracted to Minter Wilson**
Drilling Inc. Garden City, Kansas License no 208
Topography:
 Hill Slope Upland Valley
***Lake Wood Per F- Slot-.125x66**
Set between 325&565 ft & 605&626 ft.

17 Water well contractor's certification:
This well was drilled under my jurisdiction and this report is true to the best of my knowledge and belief.
K.I. Drilling 263
Business name License No.
Address Ulysses, Kansas 67880
Signed Bob Fisher Date 6/4/75
Authorized representative