

USE TYPEWRITER OR BALL POINT PEN-PRESS FIRMLY, PRINT CLEARLY.

T R EW sec 1/4 1/4 1/4 No.

WATER WELL RECORD  
KSA 82a-1201-1215

Kansas State Dept. Of Health  
(Water Well Contractors)  
Forbes-Bldg. 740  
Topeka, Kansas 66620

1 Location of well:	County <b>Stanton</b>	Township name	Fraction <b>NE<sup>1</sup>/<sub>4</sub> NW<sup>1</sup>/<sub>4</sub> NE<sup>1</sup>/<sub>4</sub></b>	Section number <b>20</b>	Town number <b>T28S</b>	Range number <b>R39W</b>
---------------------	--------------------------	---------------	--	-----------------------------	----------------------------	-----------------------------

Distance and direction from nearest town or city: <b>1 mi. N., 2 mi. W., 2 mi. N., 1/2 mi. W. of Big Bow, Kansas</b>	3 Owner of well: <b>Maxine Barber</b> Address: <b>Route 2 Johnson, Kansas 67855</b>
---	--

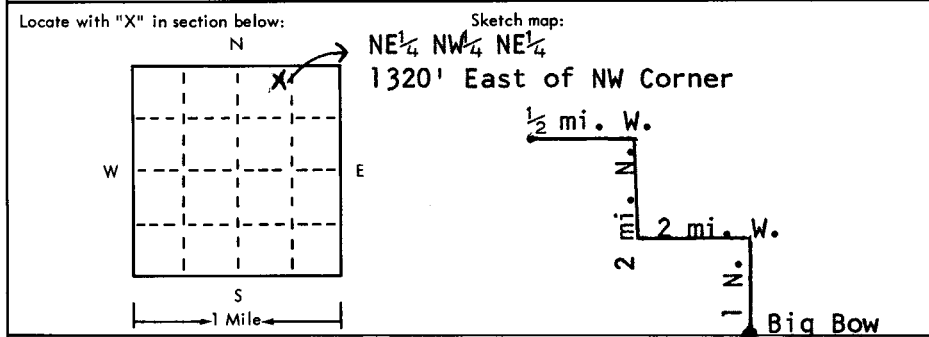

4 Well depth: <b>600</b> ft. Date of completion <b>2-14-75</b> Well diameter <b>26</b> in.
5 <input type="checkbox"/> Cable tool <input type="checkbox"/> Rotary <input type="checkbox"/> Driven <input type="checkbox"/> Dug <input type="checkbox"/> Hollow rod <input type="checkbox"/> Jetted <input type="checkbox"/> Bored <input checked="" type="checkbox"/> Reverse rotary
6 Use: <input type="checkbox"/> Domestic <input type="checkbox"/> Public supply <input type="checkbox"/> Industry <input checked="" type="checkbox"/> Irrigation <input type="checkbox"/> Air conditioning <input type="checkbox"/> Commercial <input type="checkbox"/> Test well <input type="checkbox"/> _____
7 Casing: Material <b>Steel</b> Height: above/below Threaded <input type="checkbox"/> Welded <input checked="" type="checkbox"/> Surface <b>12</b> in. Diam. _____ Weight <b>34 1/2</b> lbs./ft. _____ <b>16</b> in. to <b>600</b> ft. depth Drive shoe? <input type="checkbox"/> Yes <input checked="" type="checkbox"/> No _____ in. to _____ ft. depth

2 Type and color of material	From	To
Surface, Brown Clay & Brown Sandy Clay	0	30
Sand	30	75
Brown Sandy Clay	75	120
Sand	120	135
Brown Clay	135	195
Sand	195	210
Brown Sandy Clay & Gyp	210	240
Sand	240	260
Yellow Chalk & Red Clay	260	290
Blue Shale & Gray Clay	290	435
Blue Shale, Red Clay & Cheyenne - 40%	435	465
Red Clay, Blue Shale & Cheyenne - 30%	465	495
Cheyenne	495	550
Blue Shale - 550 to 555, Brown Sandstone	555	585
(use a second sheet if needed)		

8 Screen: Manufacturer <b>Cook</b> Type <b>Steel</b> Dia. <b>16 inches</b> Slot/gauze <b>100x100</b> Length <b>40 ft.</b> Set between <b>240</b> ft. and <b>260</b> ft. <b>20'</b> *Fittings: <b>500</b> & <b>520</b> <b>20'</b> Gravel pack <input checked="" type="checkbox"/> Yes <input type="checkbox"/> No Size range of material <b>1/2</b> down
9 Static water level: <b>128</b> ft. below land surface Date <b>2-15-75</b>
10 Pumping level below land surfaces: <b>320</b> ft. after <b>8</b> hrs. pumping <b>800</b> g.p.m. _____ ft. after _____ hrs. pumping _____ g.p.m. Estimated maximum yield <b>800</b> g.p.m.
11 Water sample submitted: <input type="checkbox"/> Yes <input checked="" type="checkbox"/> No Date _____
12 Well head completion: <b>12"</b> <input type="checkbox"/> Pitless adapter <input checked="" type="checkbox"/> Inches above grade
13 Well grouted? <input checked="" type="checkbox"/> Yes <input type="checkbox"/> No *Customer ran <input checked="" type="checkbox"/> Neat cement <input type="checkbox"/> Bentonite <input type="checkbox"/> foundation Depth: From <b>0</b> ft. to <b>10</b> ft.
14 Nearest source of possible contamination: in field ft. _____ Direction <b>none</b> Type _____ Well disinfected upon completion? <input type="checkbox"/> Yes <input checked="" type="checkbox"/> No
15 Pump: <input type="checkbox"/> Not installed Manufacturer's name <b>Peerless</b> Model number <b>used</b> HP <b>150</b> Volts _____ Length of drop pipe <b>490</b> ft. capacity <b>000</b> g.m.p. Type: <input type="checkbox"/> Submersible <input checked="" type="checkbox"/> Turbine <input type="checkbox"/> Jet <input type="checkbox"/> Reciprocating <input type="checkbox"/> Centrifugal <input type="checkbox"/> Other

16 Remarks: elevation  
**Drilling Sub-contracted to:  
Jones Drilling Co. License #257  
Liberal, Kansas 67901**

Topography:  
 Hill  Slope  Upland  Valley

\* Brown Perf. - Slot - .125 X 100  
Set between 260' & 500' and 520' & 600'  
Leveled good for flood irrigation.

17 Water well contractor's certification:  
This well was drilled under my jurisdiction and this report is true to the best of my knowledge and belief.

**K. T. Drilling Co. 263**  
Business name License No.  
Address **Box 669, Ulysses, Kan.**  
Signed **Bob Tucker** Date **2-15-75**  
Authorized representative