

1 LOCATION OF WATER WELL: County: Sedgwick	Fraction NW ¼ NW ¼ NE ¼	Section Number 26	Township Number 29S	Range Number 2W
---	-----------------------------------	-----------------------------	-------------------------------	---------------------------

Distance and direction from nearest town or city street address of well if located within city?

101 W. Ross, Clearwater KS

2 WATER WELL OWNER: KDHE RR#, St. Address, Box #: 1000 SW Jackson City, State, ZIP Code: Topeka KS 66612	Global Positioning System (decimal degrees, min. of 4 digits) Latitude: <u>NA</u> Longitude: <u>NA</u> Elevation: <u>NA</u> Datum: <u>NA</u> Data Collection Method: <u>NA</u>
---	--

3 MARK WELL'S LOCATON WITH AN "X" IN SECTION BOX:

4 DEPTH OF WELL 20.1 ft. MW2

WELL'S STATIC WATER LEVEL NA ft.

WELL WAS USED AS:

1 Domestic	5 Public Water Supply	9 Dewatering
2 Irrigation	6 Oil Field Water Supply	<input checked="" type="radio"/> 10 Monitoring
3 Feedlot	7 Domestic (Lawn & Garden)	11 Injection Well
4 Industrial	8 Air Conditioning	12 Other _____

Was a chemical/bacteriological sample submitted to Department? Yes ___ No X

5 TYPE OF BLANK CASING USED:

<input type="radio"/> 1 Steel	<input type="radio"/> 3 RMP (SR)	<input type="radio"/> 5 Wrought	<input type="radio"/> 7 Fiberglass	<input type="radio"/> 9 Other (specify below) _____
<input checked="" type="radio"/> 2 PVC	<input type="radio"/> 4 ABS	<input type="radio"/> 6 Asbestos-Cement	<input type="radio"/> 8 Concrete Tile	

Blank casing diameter 2 in. Was casing pulled? Yes X No ___ If yes, how much 3'
 Casing height above or below land surface _____ in.

6 GROUT PLUG MATERIAL: 1 Neat cement 2 Cement grout 3 Bentonite 4 Other Soil: 0-3'

Grout Plug Intervals: From 3 ft. to 20.1 ft., From _____ ft. to _____ ft., From _____ ft. to _____ ft.

What is the nearest source of possible contamination:

<input type="radio"/> 1 Septic tank	<input type="radio"/> 6 Seepage pit	<input type="radio"/> 11 Fuel storage	<input type="radio"/> 16 Other (specify below) _____
<input type="radio"/> 2 Sewer lines	<input type="radio"/> 7 Pit privy	<input type="radio"/> 12 Fertilizer storage	
<input type="radio"/> 3 Watertight sewer lines	<input type="radio"/> 8 Sewage lagoon	<input type="radio"/> 13 Insecticide storage	
<input type="radio"/> 4 Lateral lines	<input type="radio"/> 9 Feedyard	<input type="radio"/> 14 Abandoned water well	Direction from well? _____
<input type="radio"/> 5 Cess pool	<input type="radio"/> 10 Livestock pens	<input type="radio"/> 15 Oil well/Gas well	How many feet? _____

FROM	TO	PLUGGING MATERIALS	FROM	TO	PLUGGING MATERIALS
0	3	Soil			
3	20.1	Bentonite			

7 CONTRACTOR'S OR LANDOWNER'S CERTIFICATION: This water well was plugged under my jurisdiction and was completed on (mo/day/year) 4/22/14 and this record is true to the best of my knowledge and belief. Kansas Water Well Contractor's License No. 757. This Water Well Record was completed on (mo/day/year) 4/28/14 under the business name of Larsen and Associates, Inc. by (signature)

INSTRUCTIONS: Please fill in blanks or circle the correct answers. Send top three copies to Kansas Department of Health and Environment, Bureau of Water, Geology Section, 1000 SW Jackson St., Ste. 420, Topeka, Kansas 66612-1367. Telephone: 785/296-5522. Send one to Water Well Owner and retain one for your records. Visit us at <http://www.kdheks.gov/waterwell>.

NOTE: Figures exhibited within this report are only to be used within the context of this report. Placement of property lines, wells, structures, and roads is based on the available information from county appraiser maps, surveys, site visits, and/or previous vendor reports and should be considered approximate.

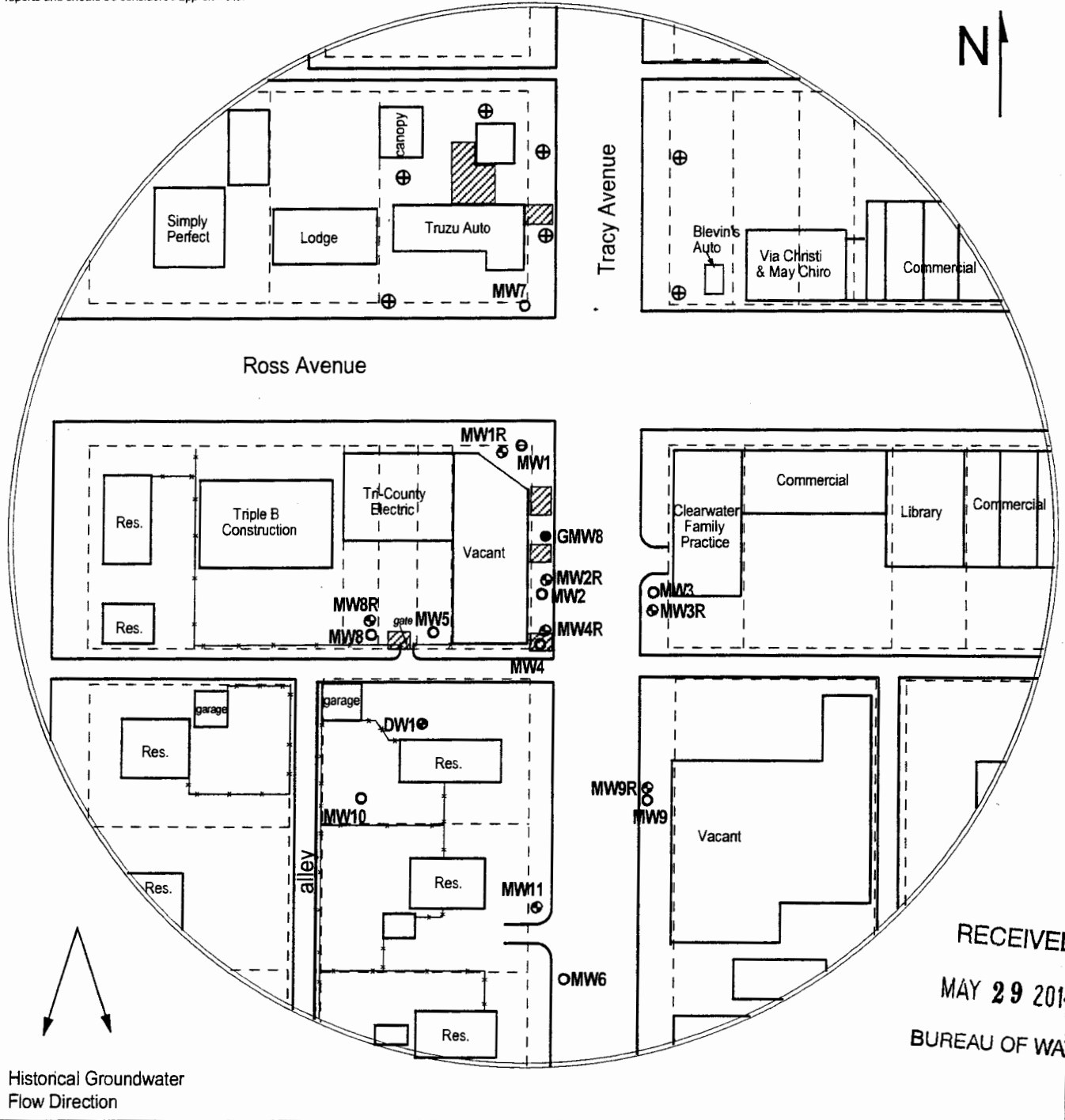

RECEIVED
MAY 29 2014
BUREAU OF WATER

FIGURE 1 - 350 FT SITE BASE MAP



PROJECT:
Seward Estate
101 W. Ross
Clearwater, KS
KDHE ID: U2-087-13479
Date: 4/23/14

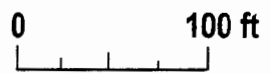

- LEGEND:**
- Approximate Location of UST Basins
 - Monitoring Well
 - Gary's Auto Monitoring Well
 - Domestic Well
 - Plugged/Destroyed Monitoring Well
 - Monitoring Well (Installed 4/22-23/14)
 - Approximate Location of Property Line

1311 E 25th St., Suite B (785) 841-8707 office
Lawrence, KS 66046 (785) 865-4282 fax

NOTE: Location of product lines is unknown.