

**WATER WELL PLUGGING RECORD Form WWC-5P**

**KSA 82a-1212**

**ID NO.**

\_\_\_\_\_

<b>1 LOCATION OF WATER WELL:</b> County: <b>Sedgwick</b>	Fraction <b>NE ¼ NE ¼ NW ¼</b>	Section Number <b>26</b>	Township Number <b>29S</b>	Range Number <b>2W</b>
---	-----------------------------------	-----------------------------	-------------------------------	---------------------------

Distance and direction from nearest town or city street address of well if located within city?

101 W. Ross, Clearwater KS

<b>2 WATER WELL OWNER: KDHE</b>  RR#, St. Address, Box #: 1000 SW Jackson  City, State, ZIP Code: Topeka KS 66612	<b>Global Positioning System</b> (decimal degrees, min. of 4 digits) Latitude: <u>NA</u> Longitude: <u>NA</u> Elevation: <u>NA</u> Datum: <u>NA</u> Data Collection Method: <u>NA</u>
---	--

**3 MARK WELL'S LOCATON WITH AN "X" IN SECTION BOX:**

**4 DEPTH OF WELL** 20.01 ft. MW8

WELL'S STATIC WATER LEVEL NA ft.

WELL WAS USED AS:

1 Domestic	5 Public Water Supply	9 Dewatering
2 Irrigation	6 Oil Field Water Supply	10 Monitoring
3 Feedlot	7 Domestic (Lawn & Garden)	11 Injection Well
4 Industrial	8 Air Conditioning	12 Other _____

Was a chemical/bacteriological sample submitted to Department? Yes \_\_\_ No X

**5 TYPE OF BLANK CASING USED:**

1 Steel	3 RMP (SR)	5 Wrought	7 Fiberglass	9 Other (specify below)
<u>2</u> PVC	4 ABS	6 Asbestos-Cement	8 Concrete Tile	_____

Blank casing diameter 2 in. Was casing pulled? Yes X No \_\_\_ If yes, how much 3'  
Casing height above or below land surface \_\_\_\_\_ in.

**6 GROUT PLUG MATERIAL:** 1 Neat cement 2 Cement grout 3 Bentonite 4 Other Gravel:0-0.2'; Soil: 0.2-3'

Grout Plug Intervals: From 3 ft. to 20.01 ft., From \_\_\_\_\_ ft. to \_\_\_\_\_ ft., From \_\_\_\_\_ ft. to \_\_\_\_\_ ft.

What is the nearest source of possible contamination:

- |                          |                   |                         |                          |
|--------------------------|-------------------|-------------------------|--------------------------|
| 1 Septic tank            | 6 Seepage pit     | 11 Fuel storage         | 16 Other (specify below) |
| 2 Sewer lines            | 7 Pit privy       | 12 Fertilizer storage   | _____                    |
| 3 Watertight sewer lines | 8 Sewage lagoon   | 13 Insecticide storage  | _____                    |
| 4 Lateral lines          | 9 Feedyard        | 14 Abandoned water well | Direction from well?     |
| 5 Cess pool              | 10 Livestock pens | 15 Oil well/Gas well    | How many feet?           |

FROM	TO	PLUGGING MATERIALS	FROM	TO	PLUGGING MATERIALS
<u>0</u>	<u>0.2</u>	<b>Gravel</b>			
<u>0.2</u>	<u>3</u>	<b>Soil</b>			
<u>3</u>	<u>20.01</u>	<b>Bentonite</b>			

**7 CONTRACTOR'S OR LANDOWNER'S CERTIFICATION:** This water well was plugged under my jurisdiction and was completed on (mo/day/year) 4/22/14 and this record is true to the best of my knowledge and belief. Kansas Water Well Contractor's License No. 757. This Water Well Record was completed on (mo/day/year) 4/28/14 under the business name of Larsen and Associates, Inc. by (signature) \_\_\_\_\_

**INSTRUCTIONS:** Please fill in blanks or circle the correct answers. Send top three copies to Kansas Department of Health and Environment, Bureau of Water, Geology Section, 1000 SW Jackson St., Ste. 420, Topeka, Kansas 66612-3667. Telephone: 785/296-5522. Send one to Water Well Owner and retain one for your records. Visit us at <http://www.kdheks.gov/waterwell>.

NOTE: Figures exhibited within this report are only to be used within the context of this report. Placement of property lines, wells, structures, and roads is based on the available information from county appraiser maps, surveys, site visits, and/or previous vendor reports and should be considered approximate.

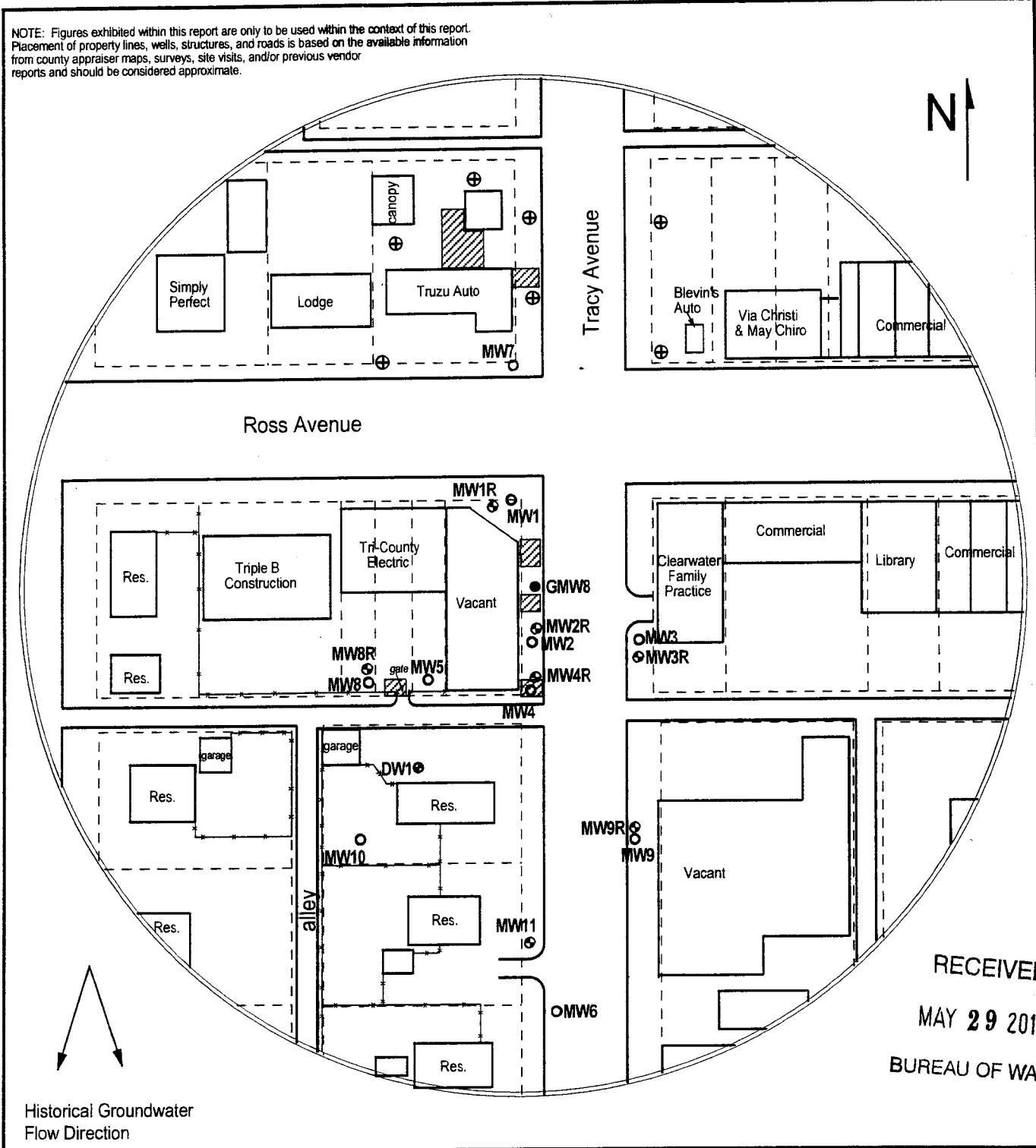

RECEIVED  
MAY 29 2014  
BUREAU OF WATER

FIGURE 1 - 350 FT SITE BASE MAP



**PROJECT:**  
Seward Estate  
101 W. Ross  
Clearwater, KS  
KDHE ID: U2-087-13479  
Date: 4/23/14

**LEGEND:**

- Approximate Location of UST Basins
- Monitoring Well
- Gary's Auto Monitoring Well
- Domestic Well
- Plugged/Destroyed Monitoring Well
- Monitoring Well (Installed 4/22-23/14)
- Approximate Location of Property Line

1311 E 25th St., Suite B (785) 841-8707 office  
Lawrence, KS 66046 (785) 865-4282 fax

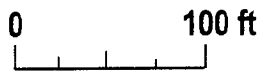

NOTE: Location of product lines is unknown.