

WATER WELL RECORD

Form WWC-5

Division of Water Resources; App. No.

1 LOCATION OF WATER WELL: Sedgwick County, NE 1/4 NE 1/4 NW 1/4, Section Number 26, Township Number T 29 S, Range Number R 2 W. Global Positioning System: Latitude: N 37.50453°, Longitude: W 97.50620°, Elevation: RIM: 1278.35; TOC: 1278.13, Datum: WGS84, Data Collection Method: legal survey

2 WATER WELL OWNER: KDHE, RR#, St. Address, Box #: 1000 Jackson Blvd, City, State, ZIP Code: Topeka KS 66612. 3 LOCATE WELL'S LOCATION WITH AN 'X' IN SECTION BOX: [Diagram showing NW, NE, SW, SE sections with 'X' in NE]. 4 DEPTH OF COMPLETED WELL: 30.07 ft. MW1R. Depth(s) Groundwater Encountered 1 ft. 2 ft. 3 ft. WELL'S STATIC WATER LEVEL: 19.60 ft. below land surface measured on 4/23/14. Pump test data: Well water was ... ft. after ... hours pumping ... gpm. Est. Yield ... gpm: Well water was ... ft. after ... hours pumping ... gpm. WELL WATER TO BE USED AS: 5 Public water supply, 8 Air conditioning, 11 Injection well, 1 Domestic, 3 Feed lot, 6 Oil field water supply, 9 Dewatering, 12 Other (Specify below), 2 Irrigation, 4 Industrial, 7 Domestic (lawn & garden), 10 Monitoring well.

5 TYPE OF CASING USED: 2 PVC, 5 Wrought Iron, 8 Concrete tile, 1 Steel, 3 RMP (SR), 6 Asbestos-Cement, 9 Other (specify below), 7 Fiberglass, 11 Other (specify), 12 None used (open hole). Blank casing diameter: 2 in. to 15.07 ft., Dia in. to ... ft., Dia in. to ... ft. Casing height below land surface: 0.22 ft., Weight lbs./ft. Wall thickness or gauge No. TYPE OF SCREEN OR PERFORATION MATERIAL: 7 PVC, 9 ABS, 11 Other (specify), 12 None used (open hole). SCREEN OR PERFORATION OPENINGS ARE: 3 Mill slot, 5 Gauze wrapped, 7 Torch cut, 9 Drilled holes, 11 None (open hole), 2 Louvered shutter, 4 Key punched, 6 Wire wrapped, 8 Saw Cut, 10 Other (specify). SCREEN-PERFORATED INTERVALS: From 15.07 ft. to 30.07 ft. GRAVEL PACK INTERVALS: From 13 ft. to 30.34 ft.

6 GROUT MATERIAL: 3 Bentonite, 4 Other Concrete: 0-1'. Grout Intervals From 1 ft. to 13 ft. From ... ft. to ... ft. From ... ft. to ... ft. What is the nearest source of possible contamination: 11 Fuel storage, 13 Insecticide Storage, 16 Other (specify below), 2 Sewer lines, 5 Cess pool, 8 Sewage lagoon, 12 Fertilizer storage, 15 Oil well/ gas well, 3 Watertight sewer lines, 6 Seepage pit, 9 Feedyard, 10 Livestock pens, 14 Abandoned water well. Direction from well? SE. How many feet? ~30'

Table with columns: FROM, TO, LITHOLOGIC LOG, FROM, TO, PLUGGING INTERVALS. Rows: 0 to 0.3 Concrete; 0.3 to 5 Brown silty clay; 5 to 15 Brown medium sandy clay; 15 to 30.34 Tan medium sand. Includes 'Flushmount waiver from BOW'.

7 CONTRACTOR'S OR LANDOWNER'S CERTIFICATION: This water well was (1) constructed, (2) reconstructed, or (3) plugged under my jurisdiction and was completed on (mo/day/year) 4/22/14 and this record is true to the best of my knowledge and belief. Kansas Water Well Contractor's License No. 757. This Water Well Record was completed on (mo/day/year) 4/28/14 under the business name of Larsen & Associates, Inc. by (signature)

INSTRUCTIONS: Please fill in blanks or circle the correct answers. Send top three copies to Kansas Department of Health and Environment, Bureau of Water, Geology Section, 1000 SW Jackson St., Suite 420, Topeka, Kansas 66612-1367. Telephone 785-296-5522. Send one to WATER WELL OWNER and retain one for your records. Fee of \$5.00 for each constructed well. Visit us at http://www.kdheks.gov/waterwell.

NOTE: Figures exhibited within this report are only to be used within the context of this report. Placement of property lines, wells, structures, and roads is based on the available information from county appraiser maps, surveys, site visits, and/or previous vendor reports and should be considered approximate.

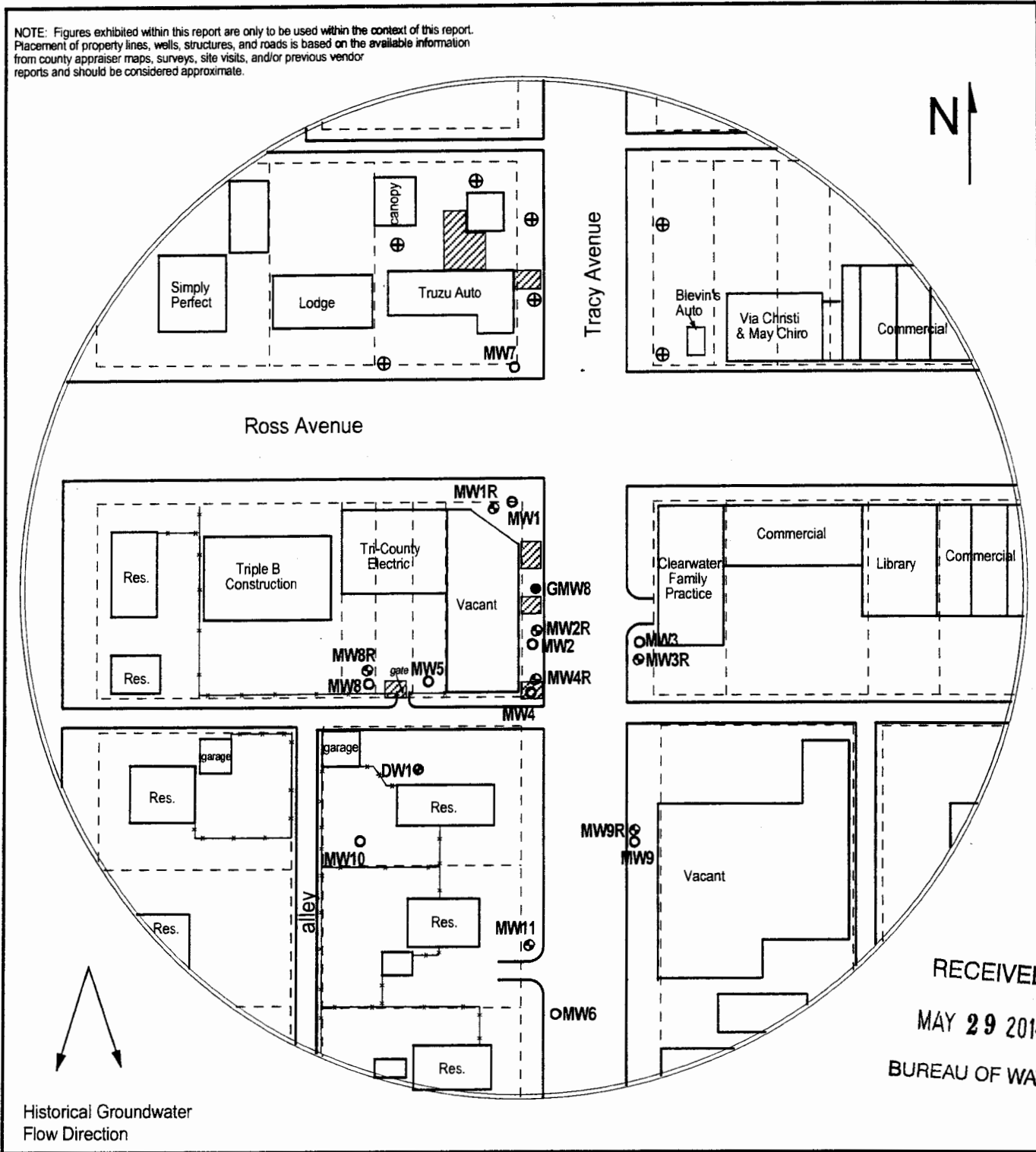

RECEIVED
MAY 29 2014
BUREAU OF WATER

FIGURE 1 - 350 FT SITE BASE MAP



PROJECT:
Seward Estate
101 W. Ross
Clearwater, KS
KDHE ID: U2-087-13479
Date: 4/23/14

- LEGEND:**
- Approximate Location of UST Basins
 - Monitoring Well
 - Gary's Auto Monitoring Well
 - Domestic Well
 - Plugged/Destroyed Monitoring Well
 - Monitoring Well (Installed 4/22-23/14)
 - Approximate Location of Property Line

1311 E 25th St., Suite B (785) 841-8707 office
Lawrence, KS 66046 (785) 865-4282 fax

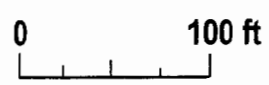

NOTE: Location of product lines is unknown.

TRITERRA LAND SERVICES

P.O. Box 546
Clearwater, Kansas 67026
Office (620) 584-2313 Cell (316) 648-3617
Fax (620) 584-4371
e-mail: watfam@sktc.net

SURVEYING FOR MONITORING WELLS SEWARD ESTATE CLEARWATER, KANSAS

The above site is in Section 26, Township 29 South, Range 2 West of the Sixth Principal Meridian, Sedgwick County, Kansas. The Southeast corner of Section 26 was assigned coordinates of 00.00 North and 00.00 West.

The vertical control was the previously established control point described as the 'M' in Mueller on top of the fire hydrant at the northeast corner of the site. Elevation is 1280.13' MSL. A new control point was established as a chiseled 'X' on the southwest corner of the concrete pad beneath the street sign on the northeast corner of the site.

The Latitude and Longitude were scaled from a 7.5' quad map titled "Clearwater".

ID	NORTH	WEST	LATITUDE	LONGITUDE	ELEVATION
SE CORNER 26-29S-2W	00.00	00.00			
Control Point	5242.69	2630.88	37.50454	97.50616	1278.73
MW-1R NE NE NE NW	5237.70	2642.01	37.50453	97.50620	RIM 1278.35 TOC 1278.13
MW-2R NW NW NW NE	5141.33	2634.55	37.50426	97.50616	RIM 1279.99 TOC 1279.65
MW-3R NW NW NW NE	5133.87	2556.62	37.50423	97.50591	RIM 1279.84 TOC 1279.63
MW-4R NW NW NW NE	5098.12	2634.63	37.50417	97.50616	RIM 1279.40 TOC 1279.00
MW-8R NE NE NE NW	5106.74	2742.81	37.50416	97.50655	RIM 1279.03 TOC 1278.69
MW-9R NW NW NW NE	4991.75	2557.66	37.50385	97.50587	RIM 1279.22 TOC 1278.88
MW-11 SW NW NW NE	4926.13	2630.01	37.50369	97.50616	RIM 1280.68 TOC 1280.34



State of Kansas
KDHE/BER Well Tag Form

Seward Estate

KDHE Project Code:

U	2	0	8	7	1	3	4	7	9
----------	----------	----------	----------	----------	----------	----------	----------	----------	----------

Well Tag Number	Well Number
0050134	MW1R
0050131	MW2R
0050129	MW3R
0050130	MW4R
0050133	MW8R
0050135	MW9R
0050132	MW11

After completing this form, photocopy it and keep the copy for your files.
Send the original to the address below.

Kansas Department of Health & Environment
Bureau of Environmental Remediation
1000 SW Jackson, Suite 410
Topeka, KS 66612-1367