

WATER WELL RECORD

Form WWC-5

Division of Water Resources; App. No.

1 LOCATION OF WATER WELL: Fraction NW 1/4 NW 1/4 NE 1/4 Section Number 26 Township Number T 29 S Range Number R 2 W
Distance and direction from nearest town or city street address of well if located within city? 101 E. Ross, Clearwater KS Global Positioning System (decimal degrees, min. of 4 digits) Latitude: N 37.50423° Longitude: W 97.50591° Elevation: RIM: 1279.84; TOC: 1279.63 Datum: WGS84 Data Collection Method: legal survey

2 WATER WELL OWNER: KDHE RR#, St. Address, Box #: 1000 Jackson Blvd City, State, ZIP Code: Topeka KS 66612

3 LOCATE WELL'S LOCATION WITH AN 'X' IN SECTION BOX: [Diagram showing a 3x3 grid with 'X' in the center] 4 DEPTH OF COMPLETED WELL 29.69 ft. MW3R Depth(s) Groundwater Encountered 1 ft. 2 ft. 3 ft. WELL'S STATIC WATER LEVEL 21.35 ft. below land surface measured on mo/day/yr 4/23/14 Pump test data: Well water was ... ft. after ... hours pumping ... gpm Est. Yield gpm: Well water was ... ft. after ... hours pumping ... gpm WELL WATER TO BE USED AS: 5 Public water supply 8 Air conditioning 11 Injection well 1 Domestic 3 Feed lot 6 Oil field water supply 9 Dewatering 12 Other (Specify below) 2 Irrigation 4 Industrial 7 Domestic (lawn & garden) 10 Monitoring well Was a chemical/bacteriological sample submitted to Department? Yes No X; If yes, mo/day/yr Sample was submitted Water Well Disinfected? Yes No X

5 TYPE OF CASING USED: 1 Steel 3 RMP (SR) 6 Asbestos-Cement 9 Other (specify below) 2 PVC 4 ABS 7 Fiberglass CASING JOINTS: Glued Clamped Welded Threaded X Blank casing diameter 2 in. to 14.69 ft., Dia in. to ft., Dia in. to ft. Casing height below land surface 0.21 ft., Weight lbs./ft. Wall thickness or gauge No. TYPE OF SCREEN OR PERFORATION MATERIAL: 1 Steel 3 Stainless steel 5 Fiberglass 7 PVC 9 ABS 11 Other (specify) 2 Brass 4 Galvanized steel 6 Concrete tile 8 RM (SR) 10 Asbestos-Cement 12 None used (open hole) SCREEN OR PERFORATION OPENINGS ARE: 1 Continuous slot 3 Mill slot 5 Gauze wrapped 7 Torch cut 9 Drilled holes 11 None (open hole) 2 Louvered shutter 4 Key punched 6 Wire wrapped 8 Saw Cut 10 Other (specify) SCREEN-PERFORATED INTERVALS: From 14.69 ft. to 29.69 ft. From ft. to ft. From ft. to ft. GRAVEL PACK INTERVALS: From 13 ft. to 29.94 ft. From ft. to ft. From ft. to ft.

6 GROUT MATERIAL: 1 Neat cement 2 Cement grout 3 Bentonite 4 Other Concrete: 0-1' Grout Intervals From 1 ft. to 13 ft. From ft. to ft. From ft. to ft. What is the nearest source of possible contamination: 1 Septic tank 4 Lateral lines 7 Pit privy 10 Livestock pens 13 Insecticide Storage 16 Other (specify below) 2 Sewer lines 5 Cess pool 8 Sewage lagoon 11 Fuel storage 14 Abandoned water well 3 Watertight sewer lines 6 Seepage pit 9 Feedyard 12 Fertilizer storage 15 Oil well/ gas well Direction from well? SW How many feet? ~70'

Table with columns: FROM, TO, LITHOLOGIC LOG, FROM, TO, PLUGGING INTERVALS. Rows: 0-10 Grass on top; Brown silty clay, 10-19 Brown medium sandy clay, 19-29.94 Tan medium sand, Flushmount waiver from BOW

7 CONTRACTOR'S OR LANDOWNER'S CERTIFICATION: This water well was (1) constructed, (2) reconstructed, or (3) plugged under my jurisdiction and was completed on (mo/day/year) 4/22/14 and this record is true to the best of my knowledge and belief. Kansas Water Well Contractor's License No. 757. This Water Well Record was completed on (mo/day/year) 4/28/14 under the business name of Larsen & Associates, Inc. by (signature)

INSTRUCTIONS: Please fill in blanks or circle the correct answers. Send top three copies to Kansas Department of Health and Environment, Bureau of Water, Geology Section, 1000 SW Jackson St., Suite 420, Topeka, Kansas 66612-1367. Telephone 785-296-5522. Send one to WATER WELL OWNER and retain one for your records. Fee of \$5.00 for each constructed well. Visit us at http://www.kdheks.gov/waterwell.

NOTE: Figures exhibited within this report are only to be used within the context of this report. Placement of property lines, wells, structures, and roads is based on the available information from county appraiser maps, surveys, site visits, and/or previous vendor reports and should be considered approximate.

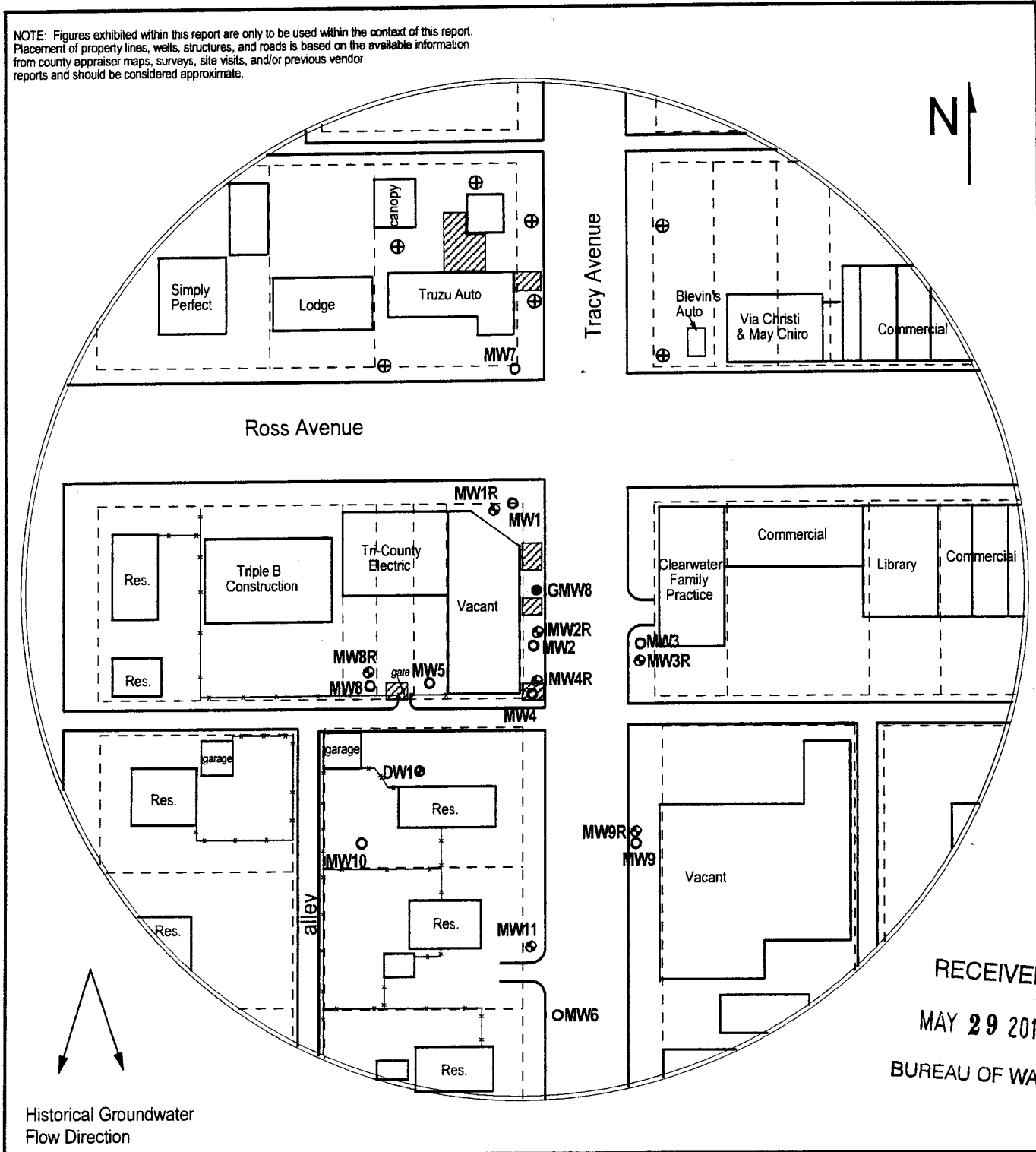

RECEIVED  
MAY 29 2014  
BUREAU OF WATER

FIGURE 1 - 350 FT SITE BASE MAP



**PROJECT:**  
Seward Estate  
101 W. Ross  
Clearwater, KS  
KDHE ID: U2-087-13479  
Date: 4/23/14

**LEGEND:**

- Approximate Location of UST Basins
- Monitoring Well
- Gary's Auto Monitoring Well
- Domestic Well
- Plugged/Destroyed Monitoring Well
- Monitoring Well (Installed 4/22-23/14)
- Approximate Location of Property Line

1311 E 25th St., Suite B (785) 841-8707 office  
Lawrence, KS 66046 (785) 865-4282 fax

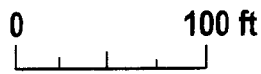

NOTE: Location of product lines is unknown.

# TRITERRA

## LAND SERVICES

P.O. Box 546  
Clearwater, Kansas 67026  
Office (620) 584-2313 Cell (316) 648-3617  
Fax (620) 584-4371  
e-mail: watfam@sktc.net

### SURVEYING FOR MONITORING WELLS SEWARD ESTATE CLEARWATER, KANSAS

The above site is in Section 26, Township 29 South, Range 2 West of the Sixth Principal Meridian, Sedgwick County, Kansas. The Southeast corner of Section 26 was assigned coordinates of 00.00 North and 00.00 West.

The vertical control was the previously established control point described as the 'M' in Mueller on top of the fire hydrant at the northeast corner of the site. Elevation is 1280.13' MSL. A new control point was established as a chiseled 'X' on the southwest corner of the concrete pad beneath the street sign on the northeast corner of the site.

The Latitude and Longitude were scaled from a 7.5' quad map titled "Clearwater".

ID	NORTH	WEST	LATITUDE	LONGITUDE	ELEVATION
SE CORNER 26-29S-2W	00.00	00.00			
Control Point	5242.69	2630.88	37.50454	97.50616	1278.73
MW-1R NE NE NE NW	5237.70	2642.01	37.50453	97.50620	RIM 1278.35 TOC 1278.13
MW-2R NW NW NW NE	5141.33	2634.55	37.50426	97.50616	RIM 1279.99 TOC 1279.65
MW-3R NW NW NW NE	5133.87	2556.62	37.50423	97.50591	RIM 1279.84 TOC 1279.63
MW-4R NW NW NW NE	5098.12	2634.63	37.50417	97.50616	RIM 1279.40 TOC 1279.00
MW-8R NE NE NE NW	5106.74	2742.81	37.50416	97.50655	RIM 1279.03 TOC 1278.69
MW-9R NW NW NW NE	4991.75	2557.66	37.50385	97.50587	RIM 1279.22 TOC 1278.88
MW-11 SW NW NW NE	4926.13	2630.01	37.50369	97.50616	RIM 1280.68 TOC 1280.34



**State of Kansas**  
**KDHE/BER Well Tag Form**

Seward Estate

KDHE Project Code:

<b>U</b>	<b>2</b>	<b>0</b>	<b>8</b>	<b>7</b>	<b>1</b>	<b>3</b>	<b>4</b>	<b>7</b>	<b>9</b>
----------	----------	----------	----------	----------	----------	----------	----------	----------	----------

Well Tag Number	Well Number
<b>0050134</b>	<b>MW1R</b>
<b>0050131</b>	<b>MW2R</b>
<b>0050129</b>	<b>MW3R</b>
<b>0050130</b>	<b>MW4R</b>
<b>0050133</b>	<b>MW8R</b>
<b>0050135</b>	<b>MW9R</b>
<b>0050132</b>	<b>MW11</b>

After completing this form, photocopy it and keep the copy for your files.  
Send the original to the address below.

Kansas Department of Health & Environment  
Bureau of Environmental Remediation  
1000 SW Jackson, Suite 410  
Topeka, KS 66612-1367