

NOTE: Figures exhibited within this report are only to be used within the context of this report. Placement of property lines, wells, structures, and roads is based on the available information from county appraiser maps, surveys, site visits, and/or previous vendor reports and should be considered approximate.

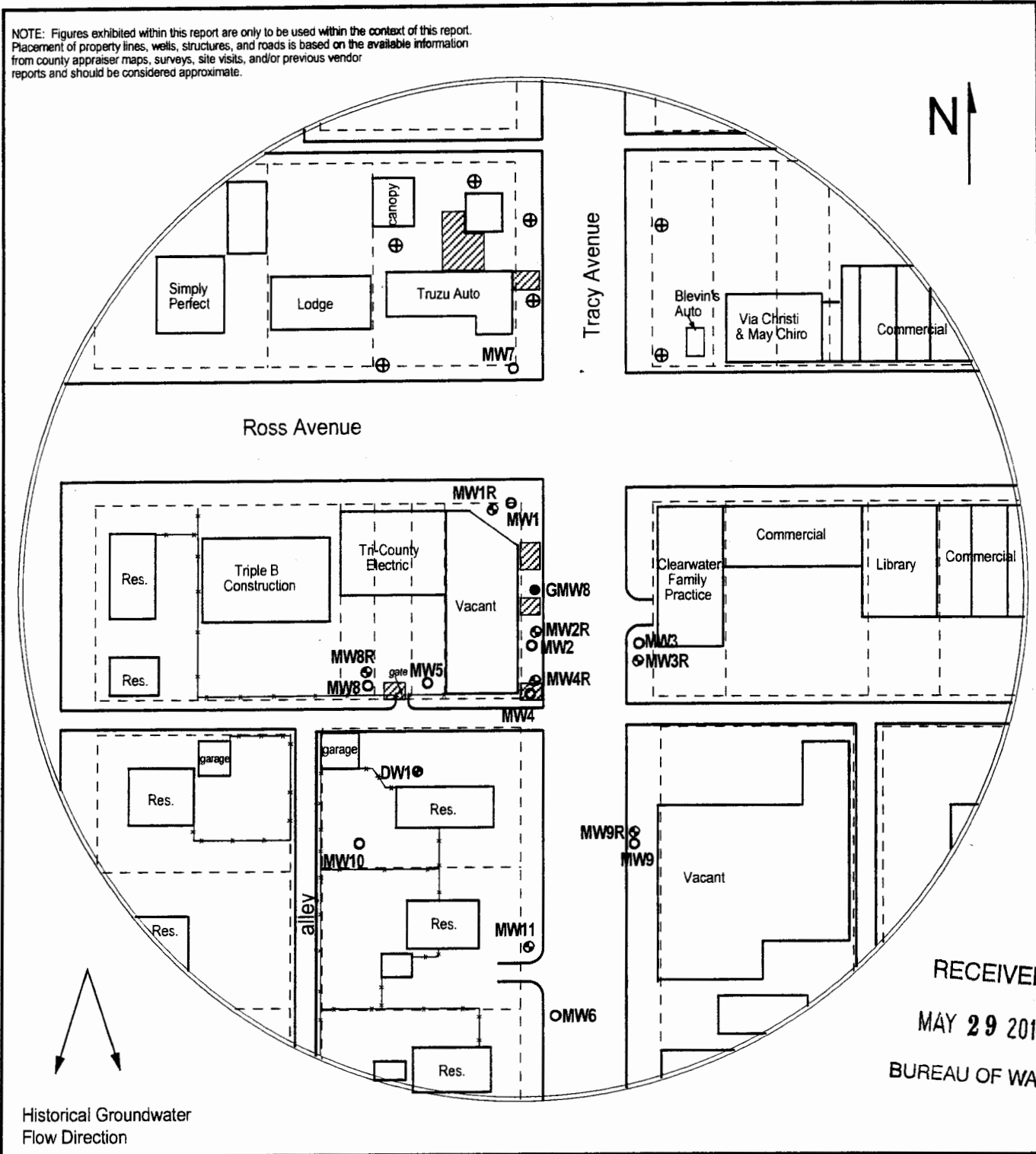

RECEIVED
MAY 29 2014
BUREAU OF WATER

FIGURE 1 - 350 FT SITE BASE MAP



PROJECT:
Seward Estate
101 W. Ross
Clearwater, KS
KDHE ID: U2-087-13479
Date: 4/23/14

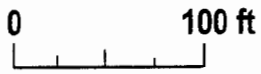

LEGEND:

- Approximate Location of UST Basins
- Monitoring Well
- Gary's Auto Monitoring Well
- Domestic Well
- Plugged/Destroyed Monitoring Well
- Monitoring Well (Installed 4/22-23/14)
- Approximate Location of Property Line

NOTE: Location of product lines is unknown.

1311 E 25th St., Suite B (785) 841-8707 office
Lawrence, KS 66046 (785) 865-4282 fax

TRITERRA

LAND SERVICES

P.O. Box 546
Clearwater, Kansas 67026
Office (620) 584-2313 Cell (316) 648-3617
Fax (620) 584-4371
e-mail: watfam@sktc.net

SURVEYING FOR MONITORING WELLS SEWARD ESTATE CLEARWATER, KANSAS

The above site is in Section 26, Township 29 South, Range 2 West of the Sixth Principal Meridian, Sedgwick County, Kansas. The Southeast corner of Section 26 was assigned coordinates of 00.00 North and 00.00 West.

The vertical control was the previously established control point described as the 'M' in Mueller on top of the fire hydrant at the northeast corner of the site. Elevation is 1280.13' MSL. A new control point was established as a chiseled 'X' on the southwest corner of the concrete pad beneath the street sign on the northeast corner of the site.

The Latitude and Longitude were scaled from a 7.5' quad map titled "Clearwater".

ID	NORTH	WEST	LATITUDE	LONGITUDE	ELEVATION
SE CORNER 26-29S-2W	00.00	00.00			
Control Point	5242.69	2630.88	37.50454	97.50616	1278.73
MW-1R NE NE NE NW	5237.70	2642.01	37.50453	97.50620	RIM 1278.35 TOC 1278.13
MW-2R NW NW NW NE	5141.33	2634.55	37.50426	97.50616	RIM 1279.99 TOC 1279.65
MW-3R NW NW NW NE	5133.87	2556.62	37.50423	97.50591	RIM 1279.84 TOC 1279.63
MW-4R NW NW NW NE	5098.12	2634.63	37.50417	97.50616	RIM 1279.40 TOC 1279.00
MW-8R NE NE NE NW	5106.74	2742.81	37.50416	97.50655	RIM 1279.03 TOC 1278.69
MW-9R NW NW NW NE	4991.75	2557.66	37.50385	97.50587	RIM 1279.22 TOC 1278.88
MW-11 SW NW NW NE	4926.13	2630.01	37.50369	97.50616	RIM 1280.68 TOC 1280.34



