

**WATER WELL RECORD**

**Form WWC-5**

Division of Water Resources App. No.

22,619

<b>1 LOCATION OF WATER WELL:</b> County: FORD	Fraction ¼ SW ¼ NW ¼ SE ¼	Section Number 33	Township No. T 29 S	Range Number R 26 <input type="checkbox"/> E <input checked="" type="checkbox"/> W
--	------------------------------	----------------------	------------------------	---

Street/Rural Address of Well Location; if unknown, distance & direction from nearest town or intersection: If at owner's address, check here .  
S SIDE OF DODGE CITY-12.5 M S, 6 M W, 5 M S TO COUNTY LINE, 2 M W, 1372' N. & 2639' W.

**Global Positioning System (GPS) information:**  
 Latitude: ..... (in decimal degrees)  
 Longitude: ..... (in decimal degrees)  
 Elevation: .....  
 Datum:  WGS 84,  NAD 83,  NAD 27  
 Collection Method:  
 GPS unit (Make/Model: .....)  
 Digital Map/Photo,  Topographic Map,  Land Survey  
 Est. Accuracy:  <3 m,  3-5 m,  5-15 m,  >15 m

**2 WATER WELL OWNER:** DOUBLE H FARMS INC & OTHERS\*  
 RR#, Street Address, Box #: 10905 WILDFIRE ROAD  
 City, State, ZIP Code : MINNEOLA, KANSAS 67865

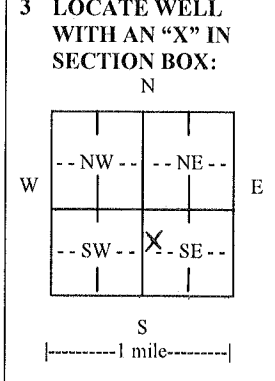

**4 DEPTH OF COMPLETED WELL** 290 ..... ft.

Depth(s) Groundwater Encountered (1)..... ft. (2)..... ft. (3)..... ft.  
 WELL'S STATIC WATER LEVEL... 132..... ft. below land surface measured on mo/day/yr. 10-3-14.....  
 Pump test data: Well water was..... ft. after..... hours pumping..... gpm  
 EST. YIELD.....gpm. Well water was.....ft. after..... hours pumping..... gpm  
 Bore Hole Diameter .30.....in. to .290.....ft., and .....in. to .....ft.  
 WELL WATER TO BE USED AS:  Public water supply  Geothermal  Injection well  
 Domestic  Feedlot  Oil field water supply  Dewatering  Other (Specify below)  
 Irrigation  Industrial  Domestic-lawn & garden  Monitoring well .....  
 Was a chemical/bacteriological sample submitted to Department?  Yes  No  
 If yes, mo/day/yr sample was submitted.....  
 Water well disinfected?  Yes  No

**5 TYPE OF CASING USED:**  Steel  PVC  Other .....  
 CASING JOINTS:  Glued  Clamped  Welded  Threaded  
 Casing diameter ...16..... in. to .140..... ft., Diameter ..... in. to ..... ft., Diameter ..... in. to ..... ft.  
 Casing height above land surface...12..... in., Weight ..42.05.....lbs./ft., Wall thickness or gauge No. ....250.....  
 TYPE OF SCREEN OR PERFORATION MATERIAL:  
 Steel  Stainless Steel  PVC  Other (Specify) .....  
 Brass  Galvanized Steel  None used (open hole)  
 SCREEN OR PERFORATION OPENINGS ARE:  
 Continuous slot  Mill slot  Gauze wrapped  Torch cut  Drilled holes  None (open hole)  
 Louvered shutter  Key punched  Wire wrapped  Saw cut  Other (specify) .....  
 SCREEN-PERFORATED INTERVALS: From....140..... ft. to ....290..... ft., From ..... ft. to ..... ft.  
 From..... ft. to ..... ft., From ..... ft. to ..... ft.  
 GRAVEL PACK INTERVALS: From....20..... ft. to ....65..... ft., From ...125..... ft. to ...290..... ft.  
 From..... ft. to ..... ft., From ..... ft. to ..... ft.

**6 GROUT MATERIAL:**  Neat cement  Cement grout  Bentonite  Other .....  
 Grout Intervals: From ...0..... ft. to ...20..... ft., From ...65..... ft. to ...125..... ft., From ..... ft. to .....ft.  
 What is the nearest source of possible contamination:  
 Septic tank  Lateral lines  Pit privy  Livestock pens  Insecticide storage  Other (specify below)  
 Sewer lines  Cesspool  Sewage lagoon  Fuel storage  Abandoned water well  
 Watertight sewer lines  Seepage pit  Feedyard  Fertilizer storage  Oil well/gas well N/A  
 Direction from well ..... Distance from well .....

FROM	TO	LITHOLOGIC LOG	FROM	TO	LITHO. LOG (cont.) or PLUGGING INTERVALS
*		HARSHBERGER LAND LLC		10905	WILDFIRE RD, MINNEOLA, KS 67865
*		LARRY J & ELIZABETH M STURGEN	TRUST	10320	WRANGLER RD, FOWLER, KS 67844-8707
0	20	TOP SOIL, CLAY	200	220	WHITE CLAY, WHITE ROCK, FINE SAND
20	100	TAN CLAY	220	240	WHITE ROCK, FINE SAND
100	120	TAN CLAY, GRAY & GREEN CLAY	240	260	FINE SAND, WHITE ROCK, BROWN ROCK
120	130	TAN CLAY	260	270	BROWN ROCK
130	140	FINE SAND	270	280	CLAY, THIN ROCK LAYERS
140	160	FINE SAND, THIN CLAY LAYERS	280	285	CLAY, ROCK LAYERS
160	190	FINE SAND	285	298	BLUE CLAY, ROCK LAYERS
190	200	CLAY, WHITE ROCK	298		ROCK

**7 CONTRACTOR'S OR LANDOWNER'S CERTIFICATION:** This water well was  constructed,  reconstructed, or  plugged under my jurisdiction and was completed on (mo/day/year) 9-29-14..... and this record is true to the best of my knowledge and belief. Kansas Water Well Contractor's License No. ...208..... This Water Well Record was completed on (mo/day/year) 9-30-14..... under the business name of MINTER-WILSON DRILLING CO., INC..... by (signature) Nora Keller.....

**INSTRUCTIONS:** Use typewriter or ball point pen. PLEASE PRESS FIRMLY and PRINT clearly. Please fill in blanks and check the correct answers. Send one copy to Kansas Department of Health and Environment, Bureau of Water, Geology Section, 1000 SW Jackson St., Suite 420, Topeka, Kansas 66612-1367. Telephone 785-296-5524. Send one copy to WATER WELL OWNER and retain one for your records. Include fee of \$5.00 for each constructed well. Visit us at <http://www.kdheks.gov/waterwell/index.html>