

USE TYPEWRITER OR BALL POINT PEN—PRESS FIRMLY, PRINT CLEARLY.

WATER WELL RECORD
KSA 82a-1201-1215

Kansas Department of Health and Environment—Division of Environment (Water well Contractors)
Topeka, Kansas 66620

BCD

1. Location of well: County Norton Fraction SE 1/4 SW 1/4 NW 1/4 Section number 10 Township number T 2 S R 21 E/W Range number

2. Distance and direction from nearest town or city: 1 1/2 miles east of ALMENA. 3. Owner of well: DARNELL PORGE
Street address of well location if in city: R.R. or street:
City, state, zip code: ALMENA KS 67622

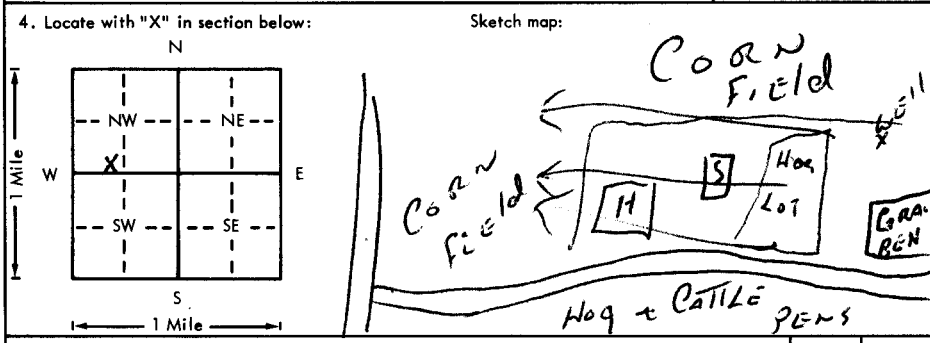

6. Bore hole dia. 9 in. Completion date 9/12/76
Well depth 75 ft.
7. Cable tool Rotary Driven Dug
 Hollow rod Jetted Bored Reverse rotary
8. Use: Domestic Public supply Industry
 Irrigation Air conditioning Stock
 Lawn Oil field water Other
9. Casing: Material PLST Height Above or below
Threaded Welded Surface 12 in.
RMP PVC Weight 275 lbs./ft.
Dia. 5 in. to 55 ft. depth Wall Thickness: inches or
Dia. 5/16 in. to 5 ft. depth gage No. 5/16

5. Type and color of material	From	To
CLAY, YELLOW	0	32
CLAY, BLUE	32	52
SAND	52	74
CLAY, S. SHALE.	74	80
BROCK 74'		
74		
50		
24' sand thick		
in Og		

10. Screen: Manufacturer's name M. P. J.
Type PVC Dia. 5
Slot/gauze .032 Length 20'
Set between 55 ft. and 25 ft.
ft. and 25 ft.
Gravel pack? YES Size range of material 4x14
11. Static water level: 50 ft. below land surface Date 9/12/76 mo./day/yr.
12. Pumping level below land surfaces:
50 ft. after 12 hrs. pumping 40 g.p.m.
50 ft. after 12 hrs. pumping 40 g.p.m.
Estimated maximum yield 40 g.p.m.
13. Water sample submitted: X Yes X No Date
14. Well head completion: X Pitless adapter 12 Inches above grade
15. Well grouted? YES
With: X Neat cement Bentonite Concrete
Depth: From 5 ft. to 15 ft.
16. Nearest source of possible contamination: 150' Direction N Type HOUSE
Well disinfected upon completion? X Yes No
17. Pump: Not installed
Manufacturer's name AERMATOR
Model number SDA-50 HP 1/2 Volts 230
Length of drop pipe 70' ft. capacity 12 g.p.m.
Type: X Submersible Turbine
 Jet Reciprocating
 Centrifugal Other

18. Elevation: 2130
Topography: Hill Slope Upland Valley
19. Remarks: 2130
20. Water well contractor's certification: This well was drilled under my jurisdiction and this report is true to the best of my knowledge and belief.
Fawcett & Son 167
Business name License No.
Address Norton KS
Signed Blaine Fawcett Date 9/13/76
Authorized representative