

USE TYPEWRITER OR BALL POINT PEN-PRESS FIRMLY, PRINT CLEARLY.

WATER WELL RECORD
KSA 82a-1201-1215

Kansas Department of Health and Environment-Division of Environment (Water well Contractors) Topeka, Kansas 66620

CBC

Almena

1. Location of well: County Norton Fraction SW 1/4 NW 1/4 SW 1/4 Section number 18 Township number T 2 S R 21 W Range number E/W

2. Distance and direction from nearest town or city: 1 west 1 South 3. Owner of well: David VanPatten
Street address of well location if in city: of Almena Kans R.R. or street:
City, state, zip code: Almena Kansas 67622

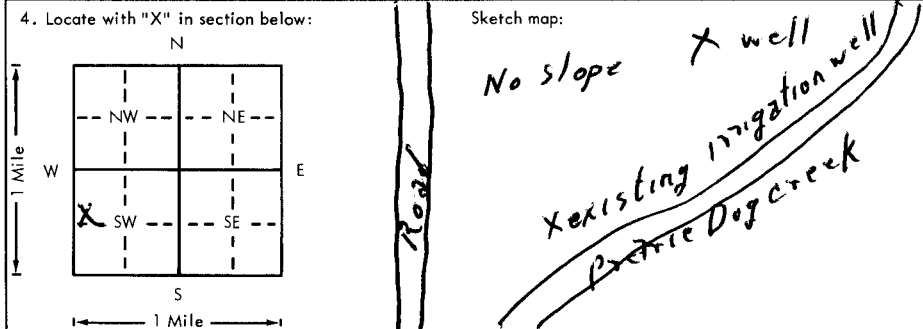

6. Bore hole dia. 9 in. Completion date 9/4/79
Well depth 50 ft.

7. Cable tool Rotary Driven Dug
 Hollow rod Jetted Bored Reverse rotary

8. Use: Domestic Public supply Industry
 Irrigation Air conditioning Stock
 Lawn Oil field water Other

9. Casing: Material PLS Height: Above _____
Threaded Welded Surface 12 in.
RMP PVC Weight 275 lbs./ft.
Dia. 40 in. to 40 ft. depth Wall Thickness: inches or
Dia. _____ in. to _____ ft. depth gage No. 258

5. Type and color of material	From	To
<u>clay</u>	<u>0</u>	<u>31</u>
<u>Sand (medium coarse)</u>	<u>31</u>	<u>46</u>
<u>Shale (blue)</u>	<u>46</u>	<u>50</u>
<u>BROCK DG</u>		
<u>16</u>		
<u>30' south</u>		
<u>in Alluvium</u>		
<u>2152</u>		

10. Screen: Manufacturer's name Modern Pipe Inc.
Type PVC Dia. 5"
Slot 0.022 Length 40'
Set between 40 ft. and 50 ft.
_____ ft. and _____ ft.
Gravel pack? yes Size range of material: 1/4 to 1/2"

11. Static water level: 16 ft. below land surface mo./day/yr. Date 9/4/79

12. Pumping level below land surfaces:
_____ ft. after _____ hrs. pumping _____ g.p.m.
_____ ft. after _____ hrs. pumping _____ g.p.m.
Estimated maximum yield 40 g.p.m.

13. Water sample submitted: _____ mo./day/yr.
 Yes No Date _____

14. Well head completion: CAPPED
 Pitless adapter 16 Inches above grade

15. Well grouted? yes
With: Neat cement Bentonite Concrete
Depth: From 0 ft. to 12 ft.

16. Nearest source of possible contamination: None
ft. _____ Direction _____ Type _____
Well disinfected upon completion? Yes No

17. Pump: Not installed
Manufacturer's name _____
Model number _____ HP _____ Volts _____
Length of drop pipe _____ ft. capacity _____ g.p.m.
Type:
 Submersible Turbine
 Jet Reciprocating
 Centrifugal Other

18. Elevation:
Topography:
 Hill
 Slope
 Upland
 Valley

19. Remarks:
customer will build cement platform

20. Water well contractor's certification:
This well was drilled under my jurisdiction and this report is true to the best of my knowledge and belief.
Edwcelta son Delg 167
Business name _____ License No. _____
Address Norton Kansas
Signed John A. Jewett Date 9/25/79
Authorized representative

T 20
R 21 W
E/W
18
Sec