

USE TYPEWRITER OR BALL POINT PEN-PRESS FIRMLY, PRINT CLEARLY.

WATER WELL RECORD
KSA 82a-1201-1215

Kansas Department of Health and Environment-Division of Environment (Water well Contractors) Topeka, Kansas 66620

BCC

Weld

1. Location of well: County Norton Fraction SW 1/4 SW 1/4 NW 1/4 Section number 32 Township number T 2 S Range number R 22 W E/W

2. Distance and direction from nearest town or city: 3 Mi. East of Norton Kans 3. Owner of well: Rolland Washburn
Street address of well location if in city: Norton Kansas 67654 R.R. or street:
City, state, zip code: Norton Kansas 67654

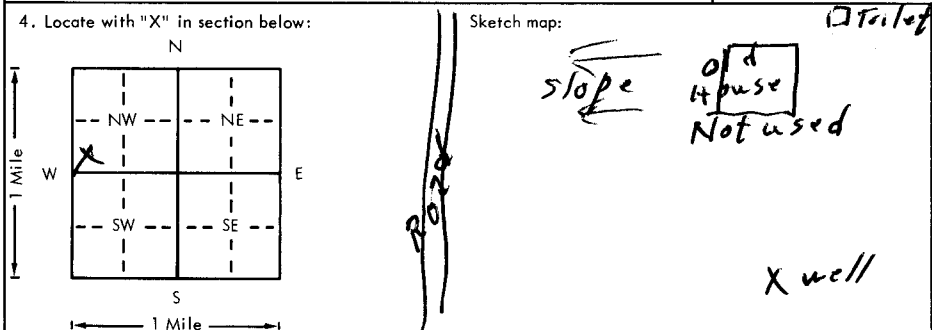

6. Bore hole dia. 9 in. Completion date 8/4/79
Well depth 80 ft.
7. Cable tool Rotary Driven Dug
 Hollow rod Jetted Bored Reverse rotary
8. Use: Domestic Public supply Industry
 Irrigation Air conditioning Stock
 Lawn Oil field water Other
9. Casing: Material Plas Height: Above or below
Threaded Welded Surface 12 in.
RMP PVC Weight 2.75 lbs./ft.
Dia. 5 in. to 70 ft. depth Wall Thickness: inches or
Dia. 5 in. to 70 ft. depth gage No. 250

5. Type and color of material

	From	To
<u>Clay</u>	<u>0</u>	<u>40</u>
<u>Clay & Lime</u>	<u>40</u>	<u>67</u>
<u>Sand (Fine)</u>	<u>67</u>	<u>79</u>
<u>Shale (Blue)</u>	<u>79</u>	<u>81</u>
<u>BROCK 79' ?</u>		
<u>49</u>		
<u>30' set thick</u>		
<u>in Og</u>		

10. Screen: Manufacturer's name Modern Pipe Inc.
Type PVC Dia. 5"
Slope 0 Length 10'
Set between 70 ft. and 80' ft.
ft. and 80' ft.
Gravel pack? Yes Size range of material 1/4 x 1/2
11. Static water level: 49 ft. below land surface Date 5/29/79 mo./day/yr.
12. Pumping level below land surfaces:
49 ft. after 18 hrs. pumping 18 g.p.m.
18 ft. after 18 hrs. pumping 18 g.p.m.
Estimated maximum yield 18 g.p.m.
13. Water sample submitted: Yes No Date 5/29/79 mo./day/yr.
14. Well head completion: Sanitary well cap
12 Pitless adapter 12 inches above grade
15. Well grouted? Yes
With: Neat cement Bentonite Concrete
Depth: From 5 ft. to 15 ft.
16. Nearest source of possible contamination: out Door
ft. 200 Direction North Type Toilet
Well disinfected upon completion? Yes No
17. Pump: Not installed
Manufacturer's name Aermotor
Model number SD12-50HP 1/2 Volts 230
Length of drop pipe 74 ft. capacity 12 g.p.m.
Type:
 Submersible Turbine
 Jet Reciprocating
 Centrifugal Other

18. Elevation: Topography: Hill Slope Upland Valley
19. Remarks: New House may be built in future
2265
21-79
20. Water well contractor's certification: This well was drilled under my jurisdiction and this report is true to the best of my knowledge and belief.
Fawcett & Son Drilling Business name License No. 1/4 1/4 1/4
Address Norton Kansas
Signed John A. Fawcett Authorized representative Date 8/27/79

T
R
E
S
E
C
1/4
1/4
1/4