

USE TYPEWRITER OR BALL
POINT PEN—PRESS FIRMLY,
PRINT CLEARLY.

WATER WELL RECORD
KSA 82a-1201-1215

Kansas Department of Health and
Environment—Division of Environment
(Water well Contractors)
Topeka, Kansas 66620

BCC

1. Location of well:	County <u>Norton</u>	Fraction <u>SW 1/4 SW 1/4 NW 1/4</u>	Section number <u>36</u>	Township number <u>T 2</u>	Range number <u>S R 22</u>
----------------------	-------------------------	---	-----------------------------	-------------------------------	-------------------------------

2. Distance and direction from nearest town or city: <u>7 miles East of Norton Ks.</u> Street address of well location if in city:	3. Owner of well: <u>GORDAL SHERLEY</u> R.R. or street: <u>RR #1</u> City, state, zip code: <u>Abmengo - Ks. 67622.</u>
--	---

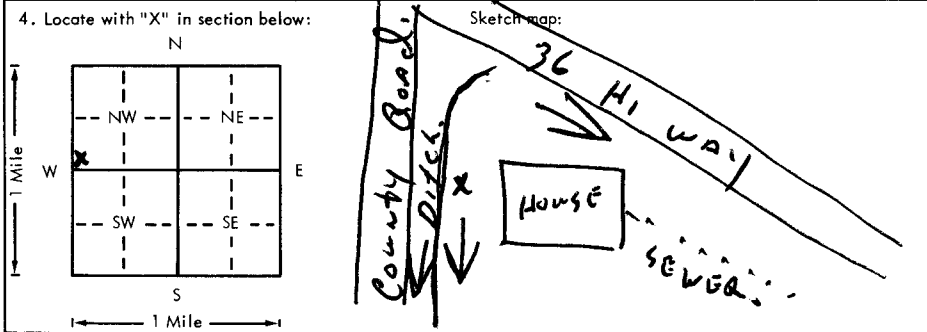

6. Bore hole dia. <u>9</u> in. Completion date <u>9-22-77</u> Well depth <u>142</u> ft.
7. <u>X</u> Cable tool <u>X</u> Rotary <u> </u> Driven <u> </u> Dug <u> </u> Hollow rod <u> </u> Jetted <u> </u> Bored <u> </u> Reverse rotary
8. Use: <u>X</u> Domestic <u> </u> Public supply <u> </u> Industry <u> </u> Irrigation <u> </u> Air conditioning <u> </u> Stock <u> </u> Lawn <u> </u> Oil field water <u> </u> Other
9. Casing: Material <u> </u> Height: <u>Above</u> or <u>Below</u> Threaded <u> </u> Welded <u> </u> Surface <u>78</u> in. RMP <u> </u> PVC <u>X</u> Weight <u>275</u> lbs./ft. Dia. <u>5</u> in. to <u>122</u> ft. depth Wall Thickness: inches or Dia. <u> </u> in. to <u> </u> ft. depth gage No. <u>25P</u>

5. Type and color of material	From	To
<u>CLAY TAN</u>	<u>0</u>	<u>20</u>
<u>SANDSTONE & FINE SAND.</u>	<u>20</u>	<u>140</u>
<u>WHITE ROCK.</u>	<u>140</u>	<u>149</u>
<u>FLINT ROCK.</u>	<u>149</u>	<u> </u>
<u>BROCK ?</u>	<u> </u>	<u> </u>

10. Screen: Manufacturer's name <u>MODERN PIPES INC.</u> Type <u>PVC</u> Dia. <u>5"</u> Slot/size <u>022</u> Length <u>30'</u> Set between <u>122</u> ft. and <u>142</u> ft. <u> </u> ft. and <u> </u> ft. Gravel pack? <u>YES</u> Size range of material <u>1/8-1/4</u>
11. Static water level: <u>110</u> ft. below land surface Date <u>9-23-77</u> mo./day/yr.
12. Pumping level below land surfaces: <u> </u> ft. after <u> </u> hrs. pumping <u> </u> g.p.m. <u> </u> ft. after <u> </u> hrs. pumping <u> </u> g.p.m. Estimated maximum yield <u>25</u> g.p.m.
13. Water sample submitted: <u> </u> mo./day/yr. <u> </u> Yes <u>X</u> No Date <u> </u>
14. Well head completion: <u> </u> Pitless adapter <u>18</u> Inches above grade
15. Well grouted? <u>YES</u> With: <u> </u> Neat cement <u> </u> Bentonite <u>X</u> Concrete Depth: From <u>5</u> ft. to <u>15</u> ft.
16. Nearest source of possible contamination: ft. <u>30</u> Direction <u>WEST</u> Type <u>Run off</u> Well disinfected upon completion? <u>X</u> Yes <u> </u> No
17. Pump: <u>X</u> Not installed Manufacturer's name <u> </u> Model number <u> </u> HP <u> </u> Volts <u> </u> Length of drop pipe <u> </u> ft. capacity <u> </u> g.p.m. Type: <u> </u> Submersible <u> </u> Turbine <u> </u> Jet <u> </u> Reciprocating <u> </u> Centrifugal <u> </u> Other

18. Elevation: Topography: <u>X</u> Hill <u>X</u> Slope <u> </u> Upland <u> </u> Valley	19. Remarks: <u>2278</u>
--	-----------------------------

20. Water well contractor's certification: This well was drilled under my jurisdiction and this report is true to the best of my knowledge and belief. <u>Fawcett & Son</u> <u>167</u> Business name License No. Address <u>Box 149 Norton Ks</u> Signed <u>[Signature]</u> Date <u>9-23-77</u> Authorized representative

T 2 2 2 2 2
 R 36
 Sec 36
 1/4 1/4 1/4 1/4