

USE TYPEWRITER OR BALL POINT PEN-PRESS FIRMLY, PRINT CLEARLY.

WATER WELL RECORD  
KSA 82a-1201-1215

Kansas Department of Health and Environment-Division of Environment (Water well Contractors) Topeka, Kansas 66620

*DDB*

*modern*

1. Location of well: County Norton Action SE of SE Section number 34 Township number T 2 S R 23 Range number 23 (W)

2. Distance and direction from nearest town or city: INSIDE Norton City Limits  
Street address of well location if in city:  
3. Owner of well: ORSEN Kingham  
R.R. or street: 336 W Lincoln  
City, state, zip code: Norton KS 67654

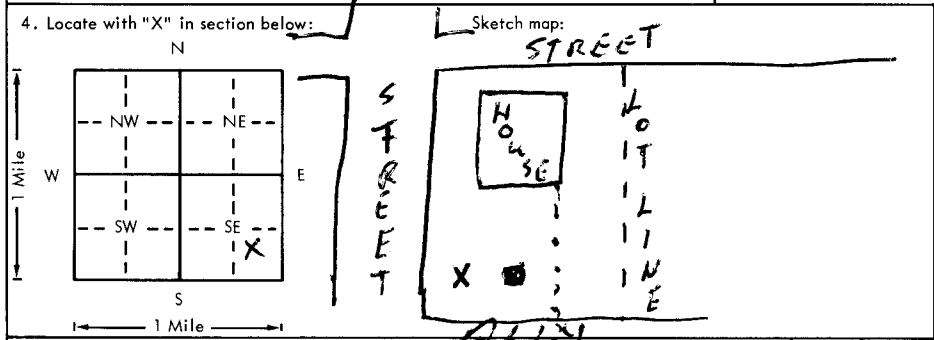

6. Bore hole dia. 9 in. Completion date 8-18-78  
Well depth 53 ft.  
7.  Cable tool  Rotary  Driven  Dug  
 Hollow rod  Jetted  Bored  Reverse rotary  
8. Use:  Domestic  Public supply  Industry  
 Irrigation  Air conditioning  Stock  
 Lawn  Oil field water  Other  
9. Casing: Material            Height Above or below  
Threaded  Welded  Surface 12 in.  
RMP            PVC  Weight 275 lbs./ft.  
Dia. 5 in. to 43 ft. depth Wall Thickness: inches or  
Dia.            in. to            ft. depth gage No. 258

5. Type and color of material	From	To
CLAY TAN	0	39
SAND (M)	39	50
SHALE BLUE	50	53
BROCK 50'		
43'		
7' col. Pass		
in Alluvium		

10. Screen: Manufacturer's name MODERN P. P. CO. INC.  
Type PVC Dia. 5"  
Slot 030 Length 10'  
Set between 43 ft. and 53 ft.  
           ft. and            ft.  
Gravel pack? yes Size range of material 1/8-1/4  
11. Static water level: 43 ft. below land surface Date 8-18-78 mo./day/yr.  
12. Pumping level below land surfaces:  
           ft. after            hrs. pumping            g.p.m.  
           ft. after            hrs. pumping            g.p.m.  
Estimated maximum yield 7 g.p.m.  
13. Water sample submitted:            mo./day/yr.  
 Yes  No Date             
14. Well head completion:  
 Pitless adapter 12 Inches above grade  
15. Well grouted? yes  
With:            Neat cement            Bentonite  Concrete  
Depth: From 5 ft. to 15 ft.  
16. Nearest source of possible contamination: city  
ft. 50 Direction South Type SEWER  
Well disinfected upon completion?  Yes  No  
17. Pump:            Not installed  
Manufacturer's name AERMATOR  
Model number 505 HP 1/2 Volts 220  
Length of drop pipe 40 ft. capacity 5 g.p.m.  
Type:  
 Submersible            Turbine  
           Jet            Reciprocating  
           Centrifugal            Other

18. Elevation: 2275  
Topography:  Hill  Slope  Upland  Valley  
19. Remarks:             
20. Water well contractor's certification:  
This well was drilled under my jurisdiction and this report is true to the best of my knowledge and belief.  
Fawcett Drilling License No. 167  
Business name Box 149 Norton Address  
Signed            Date 8-25-78  
Authorized representative

T 2 23 34 SESE