

WATER WELL RECORD

Form WWC-5

Division of Water Resources App. No.

Well ID

MW8

Original Record Correction Change in Well Use

Revised

1 LOCATION OF WATER WELL: County Norton Fraction SE 1/4 SE 1/4 NW 1/4 NE 1/4 Section Number 34 Township Number T 2 S Range Number R 23 E W

2 WELL OWNER: Last Name: Business: KDHE (McCormack's Service) Address: 1000 SW Jackson City Topeka State: KS ZIP: 66612 Street or Rural Address where well is located (if unknown, distance and direction from nearest town or intersection): ~50' west of 407 W. Holme St, Norton, KS

3 LOCATE WELL WITH "X" IN SECTION BOX: N W E S

4 DEPTH OF COMPLETED WELL: 80 ft Depth(s) Groundwater Encountered: 1) 80 ft 2) ft 3) ft or 4) Dry Well WELL'S STATIC WATER LEVEL: 66.66 ft

5 Latitude: 39.83864 (decimal degrees) Longitude: 99.89413 (decimal degrees) Horizontal Datum: X WGS 84 Source for Latitude/Longitude: X Land Survey

7 WELL WATER TO BE USED AS: 1 Domestic: Household Lawn & Garden Livestock Irrigation Feedlot Industrial 2 Public Water Supply: well ID 3 Dewatering: how many wells? 4 Aquifer Recharge: well ID 5 Monitoring: well ID MW8 6 Environmental Remediation: well ID 7 Air Sparge 8 Soil Vapor Extractor 9 Recovery 10 Injection 11 Oil Field Water Supply: lease 12 Test Hole: well ID 13 Cased 14 Uncased 15 Geotechnical 16 Geothermal: How many bores? 17 a) Closed Loop 18 Horizontal 19 Vertical 20 b) Open Loop 21 Surface Discharge 22 Inj. of Water 23 Other (specify):

Was a chemical/bacteriological sample submitted to KDHE? Yes No Water well disinfected? Yes No If yes, date sample was submitted:

8 TYPE OF CASING USED: Steel PVC Other CASING JOINTS: Glued Clamped Welded Threaded Casing diameter 2 in. to 55 ft. Diameter in. to ft. Diameter in. to ft. Casing height above land surface -0.32 in. Weight lbs./ft. Well thickness or gauge No TYPE OF SCREEN OR PERFORATION MATERIAL: Steel Stainless Steel Fiberglass PVC Other (Specify) Brass Galvanized Steel Concrete tile None used (open hole) SCREEN OR PERFORATION OPENINGS ARE: Continuous Slot Mill Slot Gauze Wrapped Torch Cut Drilled Holes Other (Specify) Louvered Shutter Key Punched Wire Wrapped Saw Cut None (Open Hole) SCREEN-PERFORATED INTERVALS: From 55 ft. to 80 ft. From ft. to ft. From ft. to ft. GRAVEL PACK INTERVALS: From 53 ft. to 80 ft. From ft. to ft. From ft. to ft.

9 GROUT MATERIAL: Neat cement Cement grout Bentonite Other Concrete: 0-0.5' Grout intervals: From 0.5 ft. to 53 ft. From ft. to ft. From ft. to ft.

Nearest source of possible contamination: Septic Tank Lateral Lines Pit Privy Livestock Pens Insecticide Storage Sewer Lines Cess Pool Sewage Lagoon Fuel Storage Abandoned Water Well Watertight Sewer Lines Seepage Pit Feedyard Fertilizer Storage Oil Well / Gas Well Other (Specify) Direction from well? E Distance from well? ~50 ft

Table with columns: FROM, TO, LITHOLOGIC LOG, FROM, TO, LITHO. LOG (cont.) or PLUGGING INTERVALS. Rows: 0-0.5 Concrete, 0.5-39 Silt, 39-76 Sand, 76-80 Weathered limestone. Notes: KDHE ID: McCormack's Service; U6-069-00154

11 CONTRACTOR'S OR LANDOWNER'S CERTIFICATION: This water well was constructed, reconstructed, or plugged under my jurisdiction and was completed on (mo-day-year) 5/26/22 and this record is true to the best of my knowledge and belief. Kansas Water Well Contractor's License No. 757 This Water Well Record was completed on (mo-day-year) 6/15/22 under the business name of Larsen & Associates, Inc. Signature

Mail 1 white copy along with a fee of \$5.00 for each constructed well to: Kansas Department of Health and Environment, Bureau of Water, GW Section, 1000 SW Jackson St., Suite 420, Topeka, Kansas 66612-1367. Mail one to Water Well Owner and retain one for your records. Telephone 785-296-5524.

# DENNIS L HANDKE

1820 NW 59th Terrace  
TOPEKA, KANSAS 66618  
785-286-4047 Home

Jess Chapman  
Larsen & Assoc.  
1311 E. 25<sup>th</sup> St., Suite B  
Topeka, Kansas 66046

June 9, 2022  
Revised September 17, 2022

RE: Monitor Well Elevation Survey  
407 W. Holme St., Norton, Kansas

Proj. 22-00HH  
McCormack's Service  
KDHE ID U6-069-00154

Bench Mark: Chisled sq. on SW corner of concrete sign base near the SE corner of property.  
Elev.: 2335.02    North 3980.84    West 1308.47    (from NE Cor. Sec. 34-2-23W)

MW-1	rim	2335.07	North 4009.41	SE1/4,SE1/4,NW1/4,NE1/4
	top pipe	2334.79	West 1329.08	Lat = 39.83873    Long = 99.89358
MW-2	rim	2335.71	North 3999.15	SE1/4,SE1/4,NW1/4,NE1/4
	top pipe	2335.41	West 1425.20	Lat = 39.83870    Long = 99.89392
MW-3	rim	2335.02	North 3984.59	SE1/4,SE1/4,NW1/4,NE1/4
	top pipe	2334.64	West 1355.96	Lat = 39.83866    Long = 99.89368
MW-4	rim	2336.10	North 4085.79	SE1/4,SE1/4,NW1/4,NE1/4
	top pipe	2335.57	West 1408.08	Lat = 39.83894    Long = 99.89386
MW-5	rim	2336.16	North 3859.12	NE1/4,NE1/4,SW1/4,NE1/4
	top pipe	2335.92	West 1459.46	Lat = 39.83832    Long = 99.89405
MW-6	rim	2332.37	North 3900.95	NW1/4,NW1/4,SE1/4,NE1/4
	top pipe	2332.12	West 1157.21	Lat = 39.83843    Long = 99.89297
MW-7	rim	2334.32	North 3884.83	NW1/4,NW1/4,SE1/4,NE1/4
	top pipe	2333.94	West 1314.99	Lat = 39.83838    Long = 99.89353
MW-8	rim	2336.57	North 3976.78	SE1/4,SE1/4,NW1/4,NE1/4
	top pipe	2336.25	West 1484.43	Lat = 39.83864    Long = 99.89413
MW-9	rim	2334.89	North 3984.94	SW1/4,SW1/4,NE1/4,NE1/4
	top pipe	2334.64	West 1245.94	Lat = 39.83866    Long = 99.89328

Lat & Long derived from Norton 7.5' quad map. WGS84.

Elevation derived from NGS Station Norton. NAVD 88.

RECEIVED

SEP 22 2022

BUREAU OF WATER

If you have any questions, please feel free to call me. Thank you for the opportunity to be

of service to you.

Dennis L. Handke, RLS  
LS-188

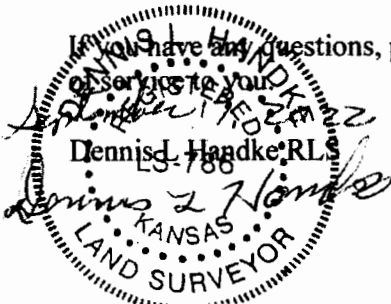

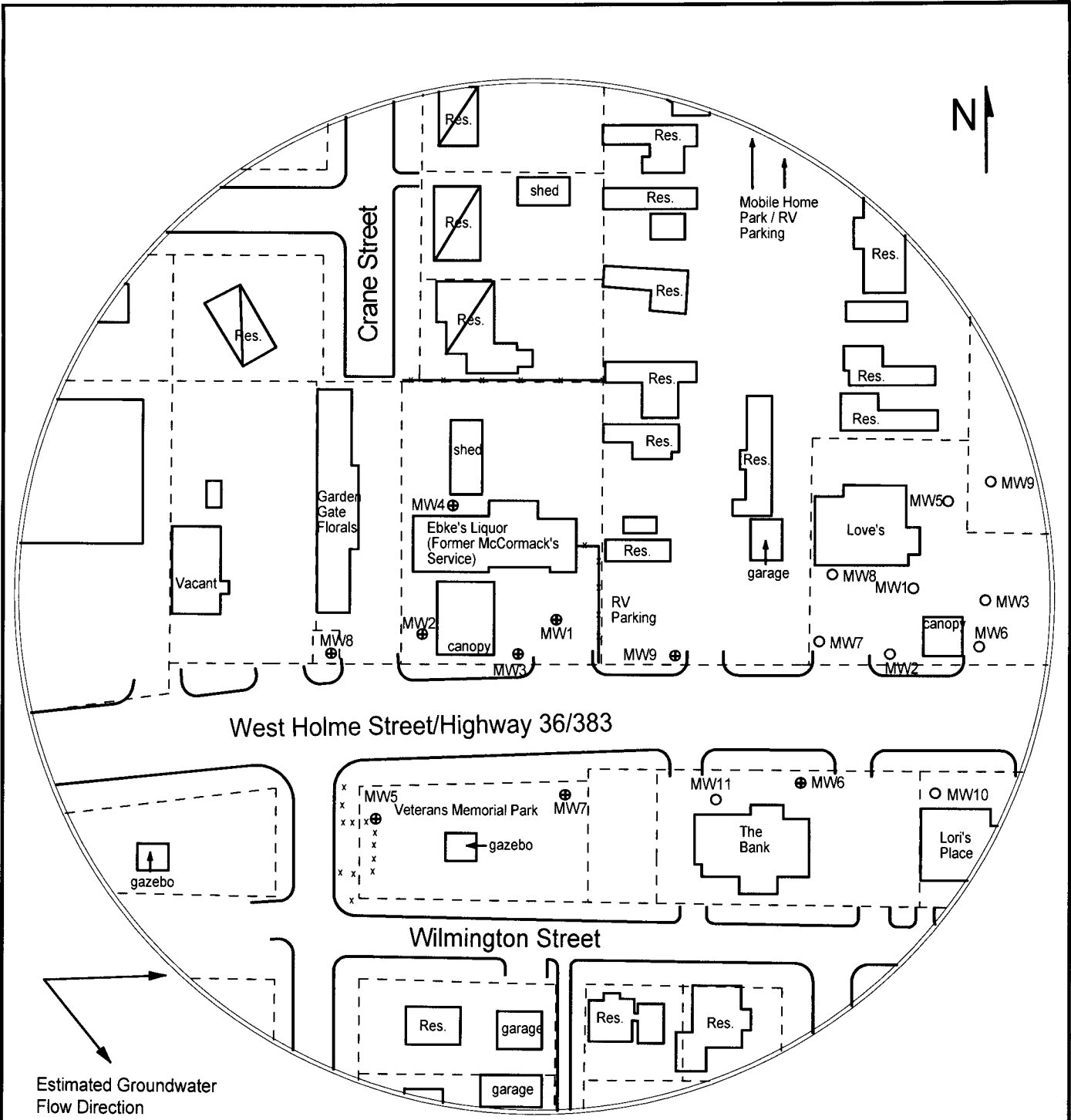

**larsen**  
& ASSOCIATES, INC.

1311 E 25th St. Suite B  
Lawrence, KS 66046

785-841-8707 office  
785-865-4282 fax

**PROJECT:**  
McCormack's Service  
407 W. Holme  
Norton, KS  
KDHE ID: U6-069-00154  
Date: 6/1/22

0 100 ft

**LEGEND:**

- Approximate Location of Former UST Basin & Pump Island
- Approximate Location of Active UST Basin & Pump Island
- Building with Basement
- Approximate Location of Property Line
- Existing Monitoring Well
- New Monitoring Well (installed 5/17, 19, 20, 24-27/22)
- Plugged Monitoring Well (Love's Country Store 60)