

DENNIS L HANDKE

1820 NW 59th Terrace
TOPEKA, KANSAS 66618
785-286-4047 Home

Jess Chapman
Larsen & Assoc.
1311 E. 25th St., Suite B
Topeka, Kansas 66046

June 29, 2023

T. 2 R.23W Sec.34

Norton County

RE: Monitor Well Elevation Survey
407 W. Holme St., Norton, Kansas

Proj. 23-00W
McCormack's Service
KDHE ID U6-069-00154

Bench Mark: Chisled sq. on SW corner of concrete sign base near the SE corner of property.
Elev.: 2335.02 North 3980.84 West 1308.47 (from NE Cor. Sec. 34-2-23W)

MW-15	rim	2333.20	North	3808.65	NW1/4,NW1/4,SE1/4,NE1/4
	top pipe	2332.88	West	1137.38	Lat = 39.83817 Long = 99.89290
MW-16	rim	2333.42	North	3721.50	NW1/4,NW1/4,SE1/4,NE1/4
	top pipe	2333.12	West	1151.56	Lat = 39.83793 Long = 99.89295
MW-17	rim	2337.19	North	3540.41	SE1/4,NE1/4,SW1/4,NE1/4
	top pipe	2336.90	West	1433.90	Lat = 39.83744 Long = 99.89396
MW-18	rim	2336.21	North	3608.66	SE1/4,NE1/4,SW1/4,NE1/4
	top pipe	2335.75	West	1454.94	Lat = 39.83763 Long = 99.89439
MW-19	rim	2339.64	North	3827.37	NW1/4,NE1/4,SW1/4,NE1/4
	top pipe	2338.94	West	1775.53	Lat = 39.83824 Long = 99.89517

Lat & Long derived from Norton 7.5' quad map. WGS84.

Elevation derived from existing project. NAVD 88.

If you have any questions, please feel free to call me. Thank you for the opportunity to be of service to you.

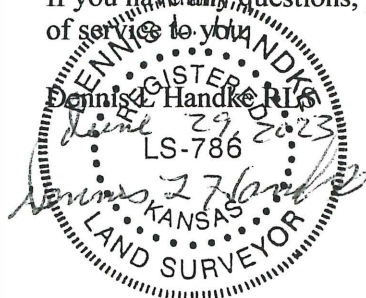

RECEIVED
JUL 14 2023
BUREAU OF WATER

T. 2 R.23W Sec.34
Norton County

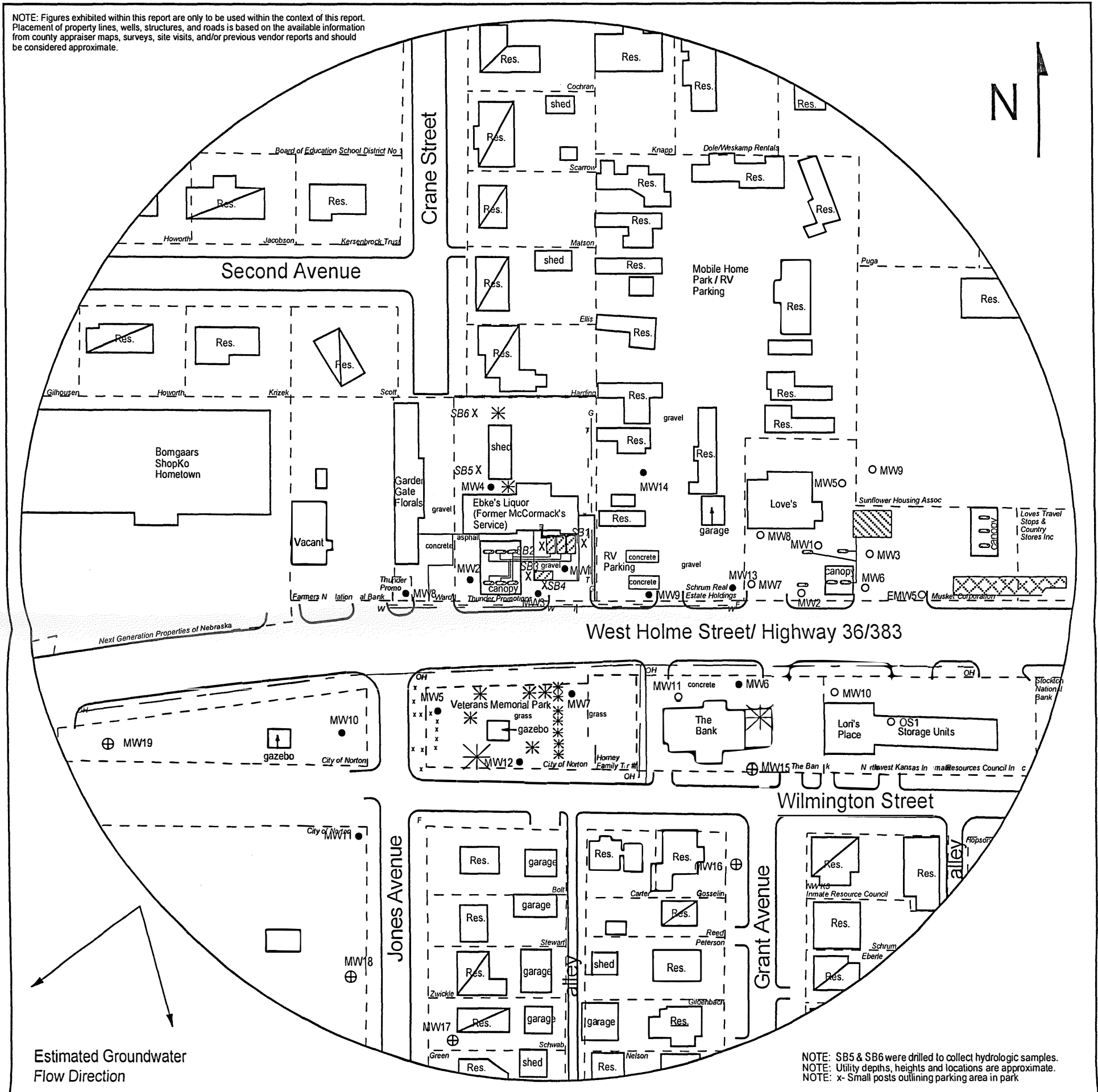
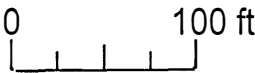

FIGURE 2.1 - 500 FT RADIUS AREA BASE MAP



1311 E 25th St., Suite B 785-841-8707 office
Lawrence, KS 66046 785-865-4282 fax

PROJECT:
McCormack's Service
407 W. Holme
Norton, KS
KDHE ID: U6-069-00154
Date: 6/14-16/23



LEGEND

- Approximate Location of Former UST Basin, Product Lines & Pump Islands
- Approximate Location of Active UST Basin, Pump Islands, and Vents
- Building with Basement
- Approximate Location of Property Line
- Monitoring Well
- New Monitoring Well (installed 6/13-16/23)
- Plugged Monitoring Well (Love's Country Store 60)
- Soil Boring (drilled 5/16-19/22, 5/26/22)
- Fire Hydrant
- Gas Lines (1.5 - 3 ft bgs)
- Overhead Lines (25'-40' high)
- Sewer Lines (2 - 6 ft bgs)
- Telephone Lines (2 - 6 ft bgs)
- Water Lines (2 - 6 ft bgs)