

## WATER WELL RECORD

## Form WWC-5

Division of Water  
Resources App. No.

Well ID

MW17

☒ Original Record ☐ Correction ☐ Change in Well Use

<b>1 LOCATION OF WATER WELL:</b> County Norton		Fraction SE ¼ NE ¼ SW ¼ NE ¼		Section Number 34	Township Number T 2 S	Range Number R 23 <input type="checkbox"/> E <input checked="" type="checkbox"/> W
<b>2 WELL OWNER:</b> Last Name: _____ Business: KDHE (McCormack's Service) Address: 1000 SW Jackson City: Topeka State: KS ZIP: 66612		Street or Rural Address where well is located (if unknown, distance and direction from nearest town or intersection): If at owner's address, check here: <input type="checkbox"/> ~420' south of 407 W. Holme St, Norton, KS				
<b>3 LOCATE WELL WITH "X" IN SECTION BOX:</b> <div style="text-align: center;">N NW ——— X NE W ——— E SW ——— SE S</div> [-----] 1 mile [-----]		<b>4 DEPTH OF COMPLETED WELL:</b> _____ ft Depth(s) Groundwater Encountered: 1) _____ ft 2) _____ ft 3) _____ ft, or 4) <input type="checkbox"/> Dry Well WELL'S STATIC WATER LEVEL: _____ ft. <input checked="" type="checkbox"/> below land surface, measured on (mo-day-yr) 6/14-16/23 <input type="checkbox"/> above land surface, measured on (mo-day-yr) _____ Pump test data: Well water was _____ ft after _____ hours pumping _____ gpm Water well was _____ ft after _____ hours pumping _____ gpm Estimated Yield: _____ gpm Bore Hole Diameter: 7.25 in to _____ ft, and _____ in to _____ ft		<b>5 Latitude:</b> 39.83744 (decimal degrees) <b>Longitude:</b> 99.89396 (decimal degrees) Horizontal Datum: <input checked="" type="checkbox"/> WGS 84 <input type="checkbox"/> NAD 83 <input type="checkbox"/> NAD 27 Source for Latitude/Longitude: <input type="checkbox"/> GPS (unit make/model: _____) (WAAS enabled? <input type="checkbox"/> Yes <input type="checkbox"/> No) <input checked="" type="checkbox"/> Land Survey <input type="checkbox"/> Topographic Map <input type="checkbox"/> Online Mapper		
		<b>6 Elevation:</b> 2336.90 ft <input type="checkbox"/> Ground Level <input checked="" type="checkbox"/> TOC Source: <input checked="" type="checkbox"/> Land Survey <input type="checkbox"/> GPS <input type="checkbox"/> Topographic Map <input type="checkbox"/> Other _____				

<b>7 WELL WATER TO BE USED AS:</b>		<b>10 Oil Field Water Supply:</b> lease _____	
1 Domestic: <input type="checkbox"/> Household <input type="checkbox"/> Lawn & Garden <input type="checkbox"/> Livestock	5 <input type="checkbox"/> Public Water Supply: well ID _____	11 Test Hole: well ID _____	<input type="checkbox"/> Cased <input type="checkbox"/> Uncased <input type="checkbox"/> Geotechnical
2 <input type="checkbox"/> Irrigation	6 <input type="checkbox"/> Dewatering: how many wells? _____	12 Geothermal: How many bores? _____	a) Closed Loop <input type="checkbox"/> Horizontal <input type="checkbox"/> Vertical
3 <input type="checkbox"/> Feedlot	7 <input type="checkbox"/> Aquifer Recharge: well ID _____	b) Open Loop <input type="checkbox"/> Surface Discharge <input type="checkbox"/> Inj. of Water	<input type="checkbox"/> Other (specify): _____
4 <input type="checkbox"/> Industrial	8 <input checked="" type="checkbox"/> Monitoring: well ID MW17		
	9 Environmental Remediation: well ID _____		
	<input type="checkbox"/> Air Sparge <input type="checkbox"/> Soil Vapor Extractor		
	<input type="checkbox"/> Recovery <input type="checkbox"/> Injection		

Was a chemical/bacteriological sample submitted to KDHE? ☐ Yes ☒ No If yes, date sample was submitted: \_\_\_\_\_

Water well disinfected? ☐ Yes ☒ No

<b>8 TYPE OF CASING USED:</b> <input type="checkbox"/> Steel <input checked="" type="checkbox"/> PVC <input type="checkbox"/> Other _____ CASING JOINTS: <input type="checkbox"/> Glued <input type="checkbox"/> Clamped <input type="checkbox"/> Welded <input checked="" type="checkbox"/> Threaded	
Casing diameter 2 in. to 55 ft, Diameter _____ in. to _____ ft, Diameter _____ in. to _____ ft,	Casing height above land surface -0.29 in. Weight _____ lbs./ft. Well thickness or gauge No _____
<b>TYPE OF SCREEN OR PERFORATION MATERIAL:</b> <input type="checkbox"/> Steel <input type="checkbox"/> Stainless Steel <input type="checkbox"/> Fiberglass <input checked="" type="checkbox"/> PVC <input type="checkbox"/> Other (Specify) _____ <input type="checkbox"/> Brass <input type="checkbox"/> Galvanized Steel <input type="checkbox"/> Concrete tile <input type="checkbox"/> None used (open hole)	
<b>SCREEN OR PERFORATION OPENINGS ARE:</b> <input type="checkbox"/> Continuous Slot <input checked="" type="checkbox"/> Mill Slot <input type="checkbox"/> Gauze Wrapped <input type="checkbox"/> Torch Cut <input type="checkbox"/> Drilled Holes <input type="checkbox"/> Other (Specify) _____ <input type="checkbox"/> Louvered Shutter <input type="checkbox"/> Key Punched <input type="checkbox"/> Wire Wrapped <input type="checkbox"/> Saw Cut <input type="checkbox"/> None (Open Hole)	
<b>SCREEN-PERFORATED INTERVALS:</b> From 55 ft. to 80 ft, From _____ ft. to _____ ft, From _____ ft. to _____ ft,	
<b>GRAVEL PACK INTERVALS:</b> From 53 ft. to 80 ft, From _____ ft. to _____ ft, From _____ ft. to _____ ft,	

<b>9 GROUT MATERIAL:</b> <input type="checkbox"/> Neat cement <input type="checkbox"/> Cement grout <input checked="" type="checkbox"/> Bentonite <input checked="" type="checkbox"/> Other Concrete: 0-1'
Grout intervals: From 1 ft. to 53 ft, From _____ ft. to _____ ft, From _____ ft. to _____ ft,

**Nearest source of possible contamination:**

<input type="checkbox"/> Septic Tank	<input type="checkbox"/> Lateral Lines	<input type="checkbox"/> Pit Privy	<input type="checkbox"/> Livestock Pens	<input type="checkbox"/> Insecticide Storage
<input type="checkbox"/> Sewer Lines	<input type="checkbox"/> Cess Pool	<input type="checkbox"/> Sewage Lagoon	<input type="checkbox"/> Fuel Storage	<input type="checkbox"/> Abandoned Water Well
<input type="checkbox"/> Watertight Sewer Lines	<input type="checkbox"/> Seepage Pit	<input type="checkbox"/> Feedyard	<input type="checkbox"/> Fertilizer Storage	<input type="checkbox"/> Oil Well / Gas Well
<input type="checkbox"/> Other (Specify) _____				

Direction from well? N Distance from well? ~435 ft

10 FROM	TO	LITHOLOGIC LOG	FROM	TO	LITHO. LOG (cont.) or PLUGGING INTERVALS
0	1	Concrete			
1	28	Clayey silt			
28	33	Sand			
33	39.5	Clayey sand			
39.5	42	Clay			
42	71	Sand			
71	80	Clay			
Notes: KDHE ID: McCormack's Service; U6-069-00154					

<b>11 CONTRACTOR'S OR LANDOWNER'S CERTIFICATION:</b> This water well was <input checked="" type="checkbox"/> constructed, <input type="checkbox"/> reconstructed, or <input type="checkbox"/> plugged under my jurisdiction and was completed on (mo-day-year) 6/14/23 and this record is true to the best of my knowledge and belief. Kansas Water Well Contractor's License No 757 This Water Well Record was completed on (mo-day-year) 7/5/23 under the business name of Larsen & Associates, Inc. Signature _____	
--	--

Mail 1 white copy along with a fee of \$5.00 for each constructed well to: Kansas Department of Health and Environment, Bureau of Water, GIS Section, 1000 SW Jackson St., Suite 420, Topeka, Kansas 66612-1367. Mail one to Water Well Owner and retain one for your records. Telephone 785-296-5524.

Visit us at <http://www.kdheks.gov/waterwell/index.html>

KSA 82a-1212

Revised 7/10/2015

# DENNIS L HANDKE

1820 NW 59th Terrace  
TOPEKA, KANSAS 66618  
785-286-4047 Home

Jess Chapman  
Larsen & Assoc.  
1311 E. 25<sup>th</sup> St., Suite B  
Topeka, Kansas 66046

June 29, 2023

T. 2 R.23W Sec.34

Norton County

RE: Monitor Well Elevation Survey  
407 W. Holme St., Norton, Kansas

Proj. 23-00W  
McCormack's Service  
KDHE ID U6-069-00154

Bench Mark: Chisled sq. on SW corner of concrete sign base near the SE corner of property.  
Elev.: 2335.02 North 3980.84 West 1308.47 (from NE Cor. Sec. 34-2-23W)

MW-15	rim	2333.20	North 3808.65	NW1/4,NW1/4,SE1/4,NE1/4
	top pipe	2332.88	West 1137.38	Lat = 39.83817 Long = 99.89290
MW-16	rim	2333.42	North 3721.50	NW1/4,NW1/4,SE1/4,NE1/4
	top pipe	2333.12	West 1151.56	Lat = 39.83793 Long = 99.89295
MW-17	rim	2337.19	North 3540.41	SE1/4,NE1/4,SW1/4,NE1/4
	top pipe	2336.90	West 1433.90	Lat = 39.83744 Long = 99.89396
MW-18	rim	2336.21	North 3608.66	SE1/4,NE1/4,SW1/4,NE1/4
	top pipe	2335.75	West 1454.94	Lat = 39.83763 Long = 99.89439
MW-19	rim	2339.64	North 3827.37	NW1/4,NE1/4,SW1/4,NE1/4
	top pipe	2338.94	West 1775.53	Lat = 39.83824 Long = 99.89517

Lat & Long derived from Norton 7.5' quad map. WGS84.

Elevation derived from existing project. NAVD 88.

If you have any questions, please feel free to call me. Thank you for the opportunity to be of service to you.



RECEIVED  
JUL 14 2023  
BUREAU OF WATER

T. 2 R.23W Sec.34  
Norton County

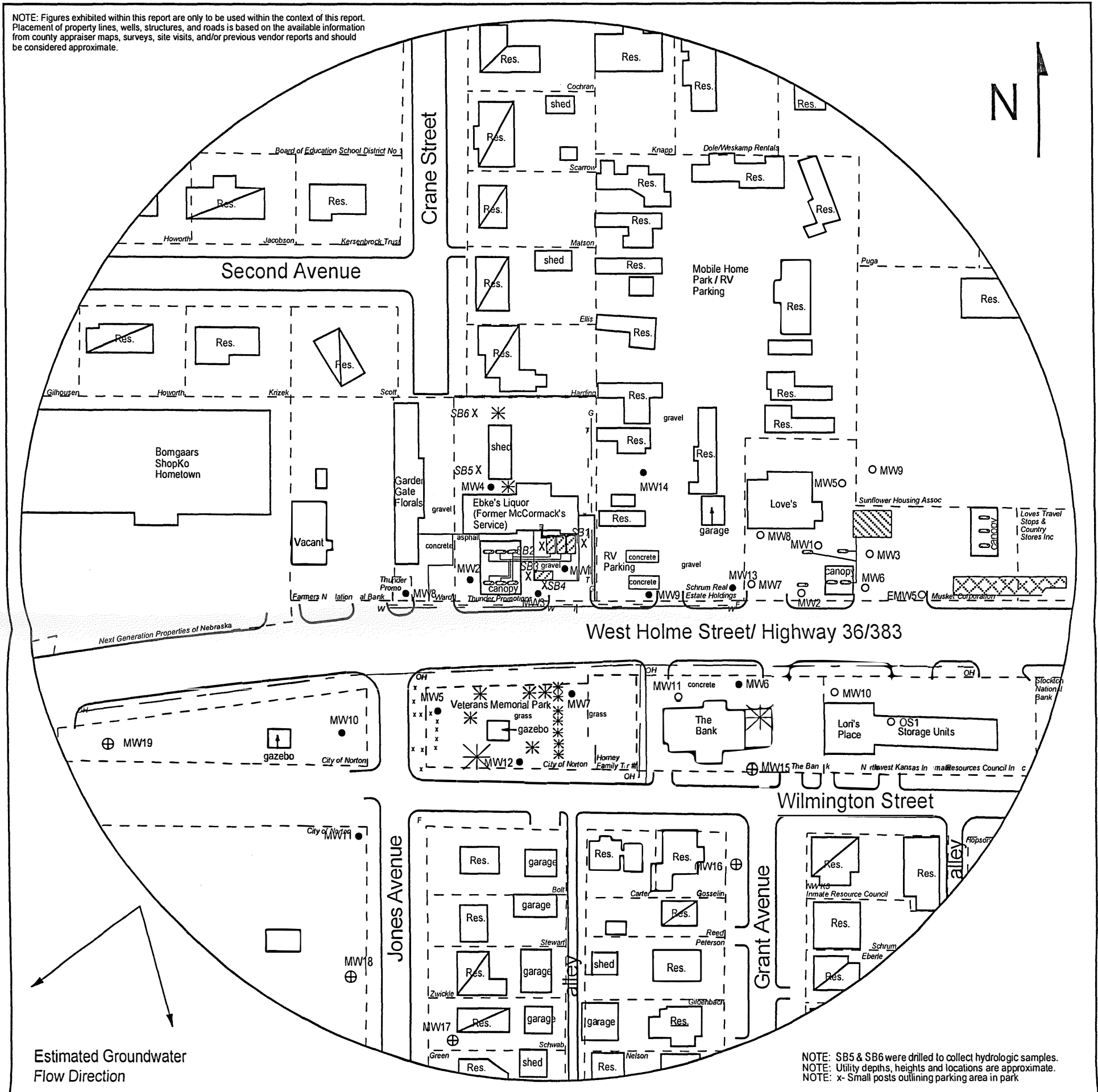

FIGURE 2.1 - 500 FT RADIUS AREA BASE MAP



1311 E 25th St., Suite B 785-841-8707 office  
Lawrence, KS 66046 785-865-4282 fax

PROJECT:  
McCormack's Service  
407 W. Holme  
Norton, KS  
KDHE ID: U6-069-00154  
Date: 6/14-16/23

0 100 ft

LEGEND

- Approximate Location of Former UST Basin, Product Lines & Pump Islands
- Approximate Location of Active UST Basin, Pump Islands, and Vents
- Building with Basement
- Approximate Location of Property Line
- Monitoring Well
- New Monitoring Well (installed 6/13-16/23)
- Plugged Monitoring Well (Love's Country Store 60)
- Soil Boring (drilled 5/16-19/22, 5/26/22)
- Fire Hydrant
- Gas Lines (1.5 - 3 ft bgs)
- Overhead Lines (25'-40' high)
- Sewer Lines (2 - 6 ft bgs)
- Telephone Lines (2 - 6 ft bgs)
- Water Lines (2 - 6 ft bgs)