

County: Rawlins Fraction: W2, SE, SE, NE Sec. 4 T. 2 S R. 33 W

CORRECTION(S) to WATER WELL COMPLETION RECORD Form WWC-5 (to rectify lacking or incorrect information)

Owner: Jane Brubaker plugged well

If location corrected, was listed as:

Section-Township-Range: 3-2S-33W

Location changed to:

4-2S-33W

Fraction (¼ calls): None given

W2, W2, SE, SE, NE

Other changes: Initial statements: County and directions to well not provided.

Changed to: 6 mi N of Atwood on 25 Hwy, E on Rd X to T-intersection, 0.5 mi N on unnamed Rd.

Old well enclosed in large concrete pad inside cattle pen E of house.

Comments: Lat. 39.90847 deg N, Long. 101.02066 deg W (WGS84)

Verification method: Information provided by Michael Prochop, Mi De Connections. Confirmed with Google Earth and KDHE STR Finder.

Initials: PKC Date: 2/8/2022

Submitted by: Kansas Geological Survey, Data Resources Library, 1930 Constant Ave., Lawrence, KS 66047-3724

Kansas Dept. of Health & Environment, Bureau of Water, 1000 SW Jackson, Suite 420, Topeka, KS 66612-1367

WATER WELL PLUGGING RECORD Form WWC-5P KSA 82a-1212 ID NO.

LOCATION OF WATER WELL: County: 10-28-21 Fraction: $\frac{1}{4}$ $\frac{1}{4}$ $\frac{1}{4}$ $\frac{1}{4}$ Section Number: 3 Township Number: T 2 S Range Number: 33 E W

Street/Rural Address of Well Location: if unknown, distance & direction from nearest town or intersection: If at owner's address, check here

Global Positioning Systems (GPS) information:
 Latitude: _____ (in decimal degrees)
 Longitude: _____ (in decimal degrees)
 Elevation: _____
 Horizontal Datum: WGS84, NAD83, NAD27
 Collection Method: _____

2 WATER WELL OWNER: Jane Brubaker
 RR#, St. Address, Box #: 402 W 11th
 City, State ZIP Code: Andover KS 67731

GPS unit (Make/Model: _____)
 Digital Map/Photo, Topographic Map, Land Survey
 Est. Accuracy: < 3 m, 3-5 m, 5-15 m, > 15 m

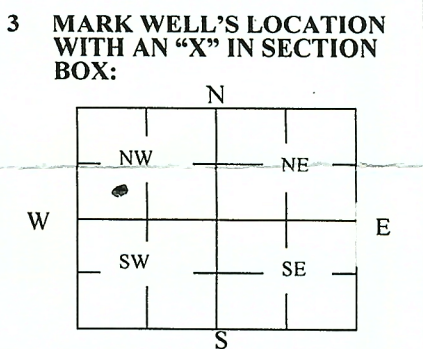

4 DEPTH OF WELL 180 ft.
 WELL'S STATIC WATER LEVEL 30 ft
 WELL WAS USED AS:
 Domestic Public Water Supply Dewatering
 Irrigation Oil Field Water Supply Monitoring
 Feedlot Domestic (Lawn & Garden) Injection Well
 Industrial Air Conditioning Other _____
 Was a chemical/bacteriological sample submitted to Department? Yes No

5 TYPE OF BLANK CASING USED:
 Steel RMP (SR) Wrought Fiberglass Other (Specify below)
 PVC ABS Asbestos-Cement Concrete Tile
 Blank casing diameter 4 in. Was casing pulled? Yes No If yes, how much _____
 Casing height above or below land surface 18 in. flush with top of concrete pad

6 GROUT PLUG MATERIAL: Neat cement Cement grout Bentonite Other _____
 Grout Plug Intervals: From 180 ft. to 150 ft., From 150 ft. to 3 ft., From 3 ft. to 7 ft.
 What is the nearest source of possible contamination:
 Septic tank Seepage pit Fuel storage Other (specify below)
 Sewer lines Pit privy Fertilizer storage
 Watertight sewer lines Sewage lagoon Insecticide storage
 Lateral lines Feedyard Abandoned water well Direction from well? _____
 Cess pool Livestock pens Oil well/Gas well How many feet? _____

FROM	TO	PLUGGING MATERIALS	FROM	TO	PLUGGING MATERIALS
<u>180</u>	<u>150</u>	<u>sand</u>	<u>150</u>	<u>3</u>	<u>bentonite</u>
<u>3</u>	<u>top</u>	<u>of concrete</u>			

7 CONTRACTOR'S OR LANDOWNER'S CERTIFICATION: This water well was plugged under my jurisdiction and was completed on (mo/day/year) 10-28-21 and this record is true to the best of my knowledge and belief. Kansas Water Well Contractor's License No. _____. This Water Well Record was completed on (mo/day/year) 10-28-21 under the business name of Wide Connections by (signature) [Signature]

Send one white copy to Kansas Department of Health & Environment, Geology Section, 1000 SW Jackson Street, Ste. 420, Topeka, KS 66612-1367. Send one copy to WATER WELL OWNER and retain one for your records.
 Visit us at <http://www.kdheks.gov/waterwell/index.html> Telephone 785-296-5524.