

1 LOCATION OF WATER WELL: County: <u>Jewell</u>	Fraction <u>SE 1/4 NE 1/4 NW 1/4</u>	Section Number <u>22</u>	Township Number <u>T 2 S</u>	Range Number <u>R 6 W</u>
--	--------------------------------------	--------------------------	------------------------------	---------------------------

Distance and direction from nearest town or city street address of well if located within city?

Please see attached map

2 WATER WELL OWNER: Burlington Northern Santa Fe Railway Co.
 RR#, St. Address, Box # : 4515 Kansas
 City, State, ZIP Code : Kansas City KS 66106
 Board of Agriculture, Division of Water Resources
 Application Number: _____

3 LOCATE WELL'S LOCATION WITH AN "X" IN SECTION BOX:	4 DEPTH OF COMPLETED WELL <u>17</u> ft. ELEVATION: _____
--	--

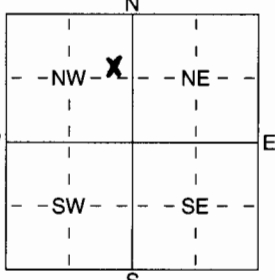

Depth(s) Groundwater Encountered 1 12 ft. 2 _____ ft. 3 _____ ft.

WELL'S STATIC WATER LEVEL 9 ft. below land surface measured on mo/day/yr 6/14/05

Pump test data: Well water was _____ ft. after _____ hours pumping _____ gpm

Est. Yield _____ gpm: Well water was _____ ft. after _____ hours pumping _____ gpm

WELL WATER TO BE USED AS:

5 Public water supply	8 Air conditioning	11 Injection well
1 Domestic	3 Feedlot	6 Oil field water supply
2 Irrigation	4 Industrial	7 Domestic (lawn & garden)
		9 Dewatering
		10 Monitoring well
		12 Other (Specify below)

Was a chemical/bacteriological sample submitted to Department? Yes _____ No X; If yes, mo/day/yr sample was submitted

Water Well Disinfected? Yes _____ No X

5 TYPE OF BLANK CASING USED:

1 Steel	3 RMP (SR)	5 Wrought iron	8 Concrete tile	CASING JOINTS: Glued _____ Clamped _____ Welded _____ Threaded <u>X</u>
<u>2</u> PVC	4 ABS	6 Asbestos-Cement	9 Other (specify below)	
		7 Fiberglass		

Blank casing diameter 2 in. to 5 ft., Dia _____ in. to _____ ft., Dia _____ in. to _____ ft.

Casing height above land surface 36 in., weight 5.4 lbs./ft. Wall thickness or gauge No. _____

TYPE OF SCREEN OR PERFORATION MATERIAL:

1 Steel	3 Stainless Steel	5 Fiberglass	8 RMP (SR)	10 Asbestos-Cement
2 Brass	4 Galvanized Steel	6 Concrete tile	9 ABS	11 Other (Specify) _____
				12 None used (open hole)

SCREEN OR PERFORATION OPENINGS ARE:

1 Continuous slot	<u>3</u> Mill slot	5 Guazed wrapped	8 Saw cut	11 None (open hole)
2 Louvered shutter	4 Key punched	6 Wire wrapped	9 Drilled holes	
		7 Torch cut	10 Other (specify) _____	

SCREEN-PERFORATED INTERVALS: From 7 ft. to 17 ft., From _____ ft. to _____ ft.

GRAVEL PACK INTERVALS: From 5 ft. to 17 ft., From _____ ft. to _____ ft.

6 GROUT MATERIAL: 1 Neat cement 2 Cement grout 3 Bentonite 4 Other _____

Grout Intervals: From 2 ft. to 5 ft., From _____ ft. to _____ ft., From _____ ft. to _____ ft.

What is the nearest source of possible contamination:

1 Septic tank	4 Lateral lines	7 Pit privy	10 Livestock pens	14 Abandoned water well
2 Sewer lines	5 Cess pool	8 Sewage lagoon	<u>11</u> Fuel storage	15 Oil well/Gas well
3 Watertight sewer lines	6 Seepage pit	9 Feedyard	12 Fertilizer storage	16 Other (specify below)
			13 Insecticide storage	

Direction from well? _____ How many feet? _____

FROM	TO	LITHOLOGIC LOG	FROM	TO	PLUGGING INTERVALS
<u>0</u>	<u>17</u>	<u>Silty clay</u>			

7 CONTRACTOR'S OR LANDOWNER'S CERTIFICATION: This water well was (1) constructed, (2) reconstructed, or (3) plugged under my jurisdiction and was completed on (mo/day/year) 6/14/05 and this record is true to the best of my knowledge and belief. Kansas Water Well Contractor's Licence No 710 This Water Well Record was completed on (mo/day/yr) 7/8/05 under the business name of Below Ground Surfaces, Inc. by (signature) [Signature]

INSTRUCTIONS: Use typewriter or ball point pen. PLEASE PRESS FIRMLY and PRINT clearly. Please fill in blanks, underline or circle the correct answers. Send top three copies to Kansas Department of Health and Environment, Bureau of Water, Geology Section, 1000 SW Jackson St., Suite 420, Topeka, Kansas 66612-1367. Telephone 785-296-5522. Send one to WATER WELL OWNER and retain one for your

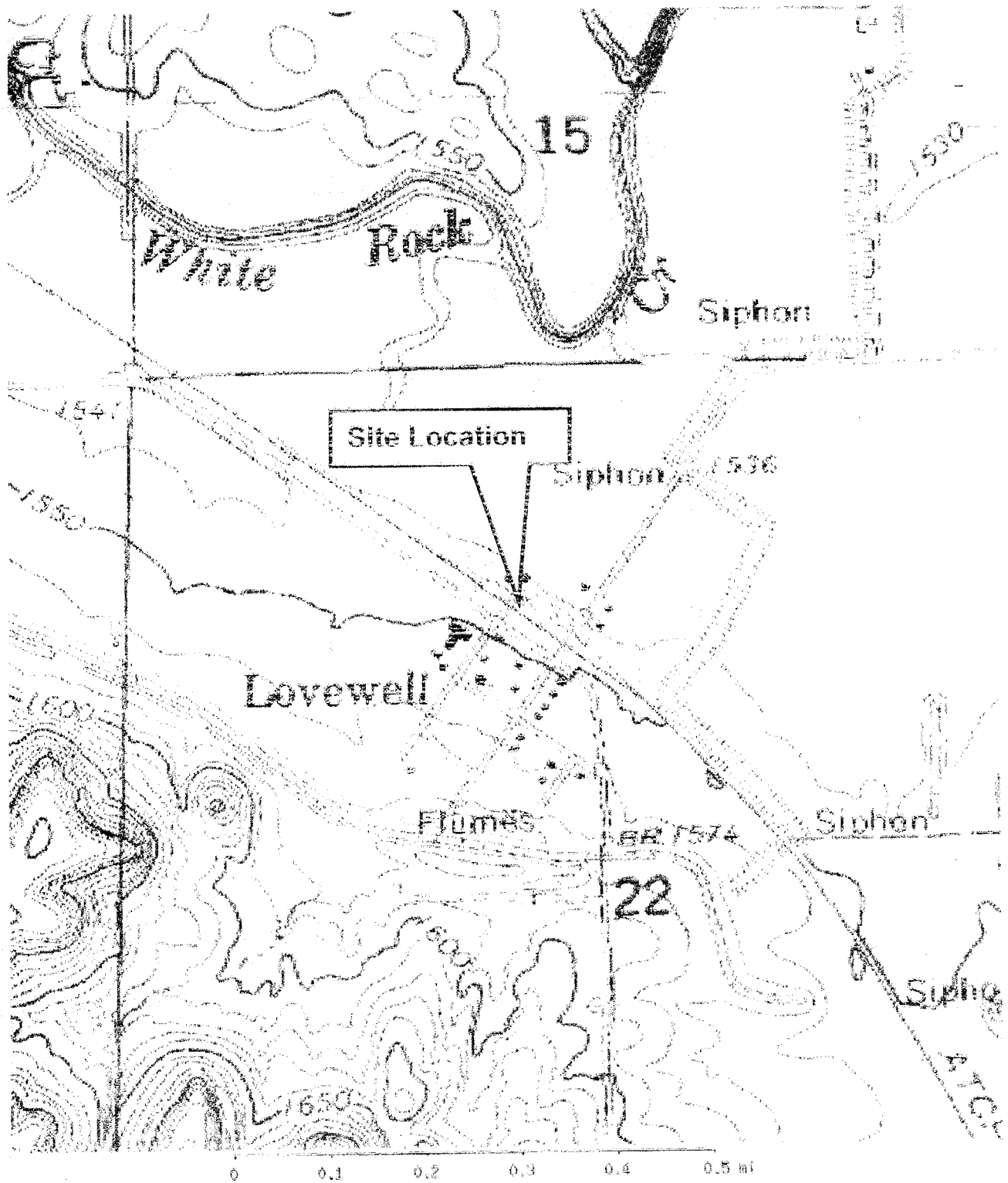

Figure 1



BNSF Leased Property 155411-
 Harlow Watson
 Lovewell, Kansas