

WATER WELL RECORD Form WWC-5

Division of Water Resources App. No.

Well ID

Original Record Correction Change in Well Use

1 LOCATION OF WATER WELL: County: Kingman Fraction: SE SE 1/4 SE Section Number: 18 Township Number: T 30 Range Number: R 10 E W

2 WELL OWNER: Last Name: Westerman First: Earl Street or Rural Address where well is located (if unknown, distance and direction from nearest town or intersection): If at owner's address, check here:
 Business Address: 429 W. Central Ave City: Nashville State: KS ZIP: 67112 151 W. Nashville, KS

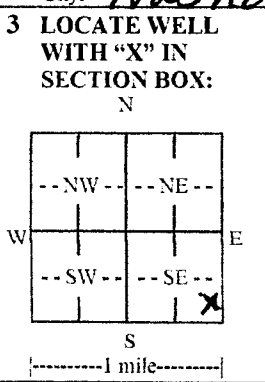

4 DEPTH OF COMPLETED WELL: 142 ft.
 Depth(s) Groundwater Encountered: 1) 49 ft.
 2) ft. 3) ft., or 4) Dry Well
 WELL'S STATIC WATER LEVEL: 49 ft.
 below land surface, measured on (mo-day-yr) 6-20-19
 above land surface, measured on (mo-day-yr).....
 Pump test data: Well water was ft. after hours pumping gpm
 Well water was ft. after hours pumping gpm
 Estimated Yield: 20 gpm
 Bore Hole Diameter: 10 in. to 142 ft. and in. to ft.

5 Latitude: (decimal degrees)
Longitude: (decimal degrees)
 Horizontal Datum: WGS 84 NAD 83 NAD 27
 Source for Latitude/Longitude:
 GPS (unit make/model: (WAAS enabled? Yes No)
 Land Survey Topographic Map
 Online Mapper:
6 Elevation: ft. Ground Level TOC
 Source: Land Survey GPS Topographic Map
 Other

7 WELL WATER TO BE USED AS:

1. Domestic: <input type="checkbox"/> Household <input type="checkbox"/> Lawn & Garden <input checked="" type="checkbox"/> Livestock	2. <input type="checkbox"/> Irrigation	3. <input type="checkbox"/> Feedlot	4. <input type="checkbox"/> Industrial	5. <input type="checkbox"/> Public Water Supply: well ID	6. <input type="checkbox"/> Dewatering: how many wells?	7. <input type="checkbox"/> Aquifer Recharge: well ID	8. <input type="checkbox"/> Monitoring: well ID	9. Environmental Remediation: well ID	10. <input type="checkbox"/> Oil Field Water Supply: lease	11. Test Hole: well ID	12. Geothermal: how many bores?	13. <input type="checkbox"/> Other (specify):
---	--	-------------------------------------	--	--	---	---	---	---	--	------------------------------	---------------------------------------	---

Was a chemical/bacteriological sample submitted to KDHE? Yes No If yes, date sample was submitted:

8 TYPE OF CASING USED: Steel PVC Other CASING JOINTS: Glued Clamped Welded Threaded
 Casing diameter: 5 in. to 142 ft., Diameter in. to ft., Diameter in. to ft.
 Casing height above land surface: 142 in. Weight: 160 lbs./ft. Wall thickness or gauge No.
TYPE OF SCREEN OR PERFORATION MATERIAL:
 Steel Stainless Steel Fiberglass PVC Other (Specify)
 Brass Galvanized Steel Concrete tile None used (open hole)
SCREEN OR PERFORATION OPENINGS ARE:
 Continuous Slot Mill Slot Gauze Wrapped Torch Cut Drilled Holes Other (Specify)
 Louvered Shutter Key Punched Wire Wrapped Saw Cut None (Open Hole)
SCREEN-PERFORATED INTERVALS: From 129 ft. to 142 ft., From ft. to ft., From ft. to ft.
GRAVEL PACK INTERVALS: From 20 ft. to 115 ft., From 120 ft. to 142 ft., From ft. to ft.

9 GROUT MATERIAL: Neat cement Cement grout Bentonite Other
 Grout Intervals: From 0 ft. to 20 ft., From 115 ft. to 120 ft., From 120 ft. to ft.
Nearest source of possible contamination:
 Septic Tank Lateral Lines Pit Privy Livestock Pens Insecticide Storage
 Sewer Lines Cess Pool Sewage Lagoon Fuel Storage Abandoned Water Well
 Watertight Sewer Lines Seepage Pit Feedyard Fertilizer Storage Oil Well/Gas Well
 Other (Specify)
 Direction from well? E Distance from well? 600' ft.

10 FROM	TO	LITHOLOGIC LOG	FROM	TO	LITHO. LOG (cont.) or PLUGGING INTERVALS
0	5	Sandy Soil			
5	13	Brown Clay			
13	21	Sand			
21	42	White Clay			
42	80	Sand			
80	112	Tan Clay			
112	122	Yellow Clay			
122	132	Tan Clay			
132	142	Sand			

11 CONTRACTOR'S OR LANDOWNER'S CERTIFICATION: This water well was constructed, reconstructed, or plugged under my jurisdiction and was completed on (mo-day-yr) 6-21-19 and this record is true to the best of my knowledge and belief. Kansas Water Well Contractor's License No. 140 This Water Well Record was completed on (mo-day-yr) 7-15-19 under the business name of L. J. Mans, Inc. Signature: [Signature]

Mail 1 white conv along with a fee of \$6.00 for each constructed well to: Kansas Department of Health and Environment, Bureau of Water, GWTS Section.