

USE TYPEWRITER OR BALL POINT PEN-PRESS FIRMLY, PRINT CLEARLY.

T R EW sec 1/4 1/4 1/4 No.

WATER WELL RECORD
KSA 82a-1201-1215

Kansas State Dept. Of Health
(Water Well Contractors)
Forbes-Bldg. 740
Topeka, Kansas 66620

1 Location of well: County STANTON Township name MANter Fraction SESESE 1/4 Section number 29 Town number 30s. Range number 43w

Distance and direction from nearest town or city: 5 1/2 M SOUTH
Street address of well location if in city: SAUNDERS-KANS.

3 Owner of well: ARDEN DILLINGER
Address: WALSH-Colo 81090

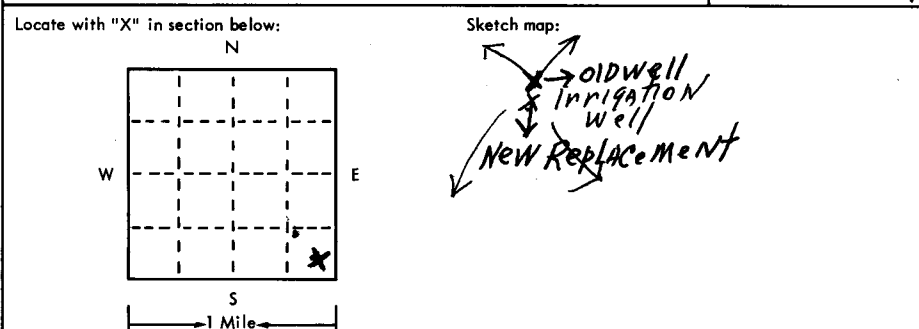

4 Well depth: 90 ft. Date of completion 4-26-76
Well diameter 14 in.
5 Cable tool Rotary Driven Dug
 Hollow rod Jetted Bored Reverse rotary
6 Use: Domestic Public supply Industry
 Irrigation Air conditioning Commercial
 Test well
7 Casing: Material Steel Height: above below
Threaded Welded Surface 14 in.
Diam. 14" Weight 22.66# lbs./ft.
14 in. to 90 ft. depth Drive shoe? Yes No
 in. to ft. depth!

2	Type and color of material	From	To
	<u>Topsoil</u>	<u>0</u>	<u>8</u>
	<u>SAND-BROWN Clay yellow</u>	<u>8</u>	<u>24</u>
	<u>SAND-GRAVEL cemented STKs</u>	<u>24</u>	<u>45</u>
	<u>SAND-GRAVEL Coarse-Clean-Loose</u>	<u>45</u>	<u>70</u>
	<u>Clay-GRAY-yellow</u>	<u>70</u>	<u>77</u>
	<u>SHALE BLACK</u>	<u>77</u>	<u>90</u>

8 Screen:
Manufacturer: JOHNSON
Type: SALVANIZE Dia. 14"
Slot/gauze 100 Length 15
Set between 59 ft. and 74 ft.
Fittings:
Gravel pack Yes No Size range of material 3/4
9 Static water level:
50 ft. below land surface Date 4-26-76
10 Pumping level below land surfaces:
60 ft. after 5 hrs. pumping 600 g.p.m.
60 ft. after 10 hrs. pumping 600 g.p.m.
Estimated maximum yield 600 g.p.m.
11 Water sample submitted:
 Yes No Date _____
12 Well head completion:
 Pitless adapter 24" inches above grade
13 Well grouted? Yes No
 Neat cement Bentonite
Depth: From 0 ft. to 10 ft.
14 Nearest source of possible contamination: None
ft. _____ Direction _____ Type _____
Well disinfected upon completion? Yes No
15 Pump: Yes Not installed.
Manufacturer's name WORTHINGTON Pump Corp
Model number 1105 HP 150 Volts _____
Length of drop pipe 80 ft. capacity 600 g.m.p.
Type:
 Submersible Turbine
 Jet Reciprocating
 Centrifugal Other

16 Remarks: elevation
Topography:
 Hill
 Slope
 Upland
 Valley
Concrete slab to be installed by LAND OWNER 24" ABOVE GROUND
Arden Dillinger by James Dillinger

17 Water well contractor's certification:
This well was drilled under my jurisdiction and this report is true to the best of my knowledge and belief.
Ralph H. Irrigation Drilling & Contrs
Business name _____ License No. _____
Address 1700 So. MAIN _____
Signed Ralph H. Dillinger Date 4-26-76
Authorized representative
Springfield-Colo 81073

30 43w 29 SESESE