

**WATER WELL PLUGGING RECORD Form WWC-5P KSA 82a-1212 ID NO.**

MW2

<b>1 LOCATION OF WATER WELL:</b> County: KINGMAN	Fraction SE ¼ SW¼ SE ¼ ¼	Section Number 3	Township Number T 30 S	Range Number 5 <input type="checkbox"/> E <input checked="" type="checkbox"/> W
---	-----------------------------	---------------------	---------------------------	--

Street/Rural Address of Well Location; if unknown, distance & direction from nearest town or intersection: If at owner's address, check here

**Global Positioning Systems (GPS) information:**  
 Latitude: 37.460098 (in decimal degrees)  
 Longitude: 97.8497963 (in decimal degrees)  
 Elevation: \_\_\_\_\_  
 Horizontal Datum:  WGS84,  NAD83,  NAD27  
 Collection Method: \_\_\_\_\_

**2 WATER WELL OWNER: KYLE'S SERVICE**  
 RR#, St. Address, Box #: 110 W. BURNS  
 City, State ZIP Code: NORWICH, KS 67118

GPS unit (Make/Model: \_\_\_\_\_)  
 Digital Map/Photo,  Topographic Map,  Land Survey  
 Est. Accuracy:  < 3 m,  3-5 m,  5-15 m,  > 15 m

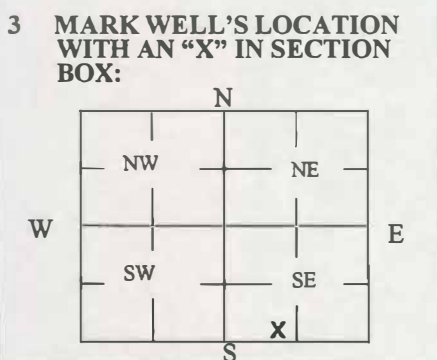

**4 DEPTH OF WELL** 24.35 ft.  
 WELL'S STATIC WATER LEVEL 20.64 ft  
 WELL WAS USED AS:  
 Domestic  Public Water Supply  Dewatering  
 Irrigation  Oil Field Water Supply  Monitoring  
 Feedlot  Domestic (Lawn & Garden)  Injection Well  
 Industrial  Air Conditioning  Other \_\_\_\_\_  
 Was a chemical/bacteriological sample submitted to Department? Yes  No

**5 TYPE OF BLANK CASING USED:**

Steel  RMP (SR)  Wrought  Fiberglass  Other (Specify below) \_\_\_\_\_  
 PVC  ABS  Asbestos-Cement  Concrete Tile

Blank casing diameter 2 in. Was casing pulled? Yes  No  If yes, how much \_\_\_\_\_  
 Casing height above or below land surface 5 in.

**6 GROUT PLUG MATERIAL:**  Neat cement  Cement grout  Bentonite  Other SOIL 0-0.5

Grout Plug Intervals: From 0.5 ft. to 24.35 ft., From \_\_\_\_\_ ft. to \_\_\_\_\_ ft., From \_\_\_\_\_ ft. to \_\_\_\_\_ ft.

What is the nearest source of possible contamination:

<input type="checkbox"/> Septic tank	<input type="checkbox"/> Seepage pit	<input checked="" type="checkbox"/> Fuel storage	<input type="checkbox"/> Other (specify below) _____
<input type="checkbox"/> Sewer lines	<input type="checkbox"/> Pit privy	<input type="checkbox"/> Fertilizer storage	
<input type="checkbox"/> Watertight sewer lines	<input type="checkbox"/> Sewage lagoon	<input type="checkbox"/> Insecticide storage	
<input type="checkbox"/> Lateral lines	<input type="checkbox"/> Feedyard	<input type="checkbox"/> Abandoned water well	Direction from well? <u>SOUTH</u>
<input type="checkbox"/> Cess pool	<input type="checkbox"/> Livestock pens	<input type="checkbox"/> Oil well/Gas well	How many feet? <u>30</u>

FROM	TO	PLUGGING MATERIALS	FROM	TO	PLUGGING MATERIALS
0	0.5	SOIL			
0.5	24.35	BENTONITE			

**7 CONTRACTOR'S OR LANDOWNER'S CERTIFICATION:** This water well was plugged under my jurisdiction and was completed on (mo/day/year) 8/4/22 and this record is true to the best of my knowledge and belief. Kansas Water Well Contractor's License No. 585. This Water Well Record was completed on (mo/day/year) 8/5/22 under the business name of ASSOCIATED ENVIRONMENTAL INC. by (signature)

Send one white copy to Kansas Department of Health & Environment, Geology Section, 1000 SW Jackson Street, Ste. 420, Topeka, KS 66612-1367. Send one copy to WATER WELL OWNER and retain one for your records.  
 Visit us at <http://www.kdheks.gov/waterwell/index.html> Telephone 785-296-5524.

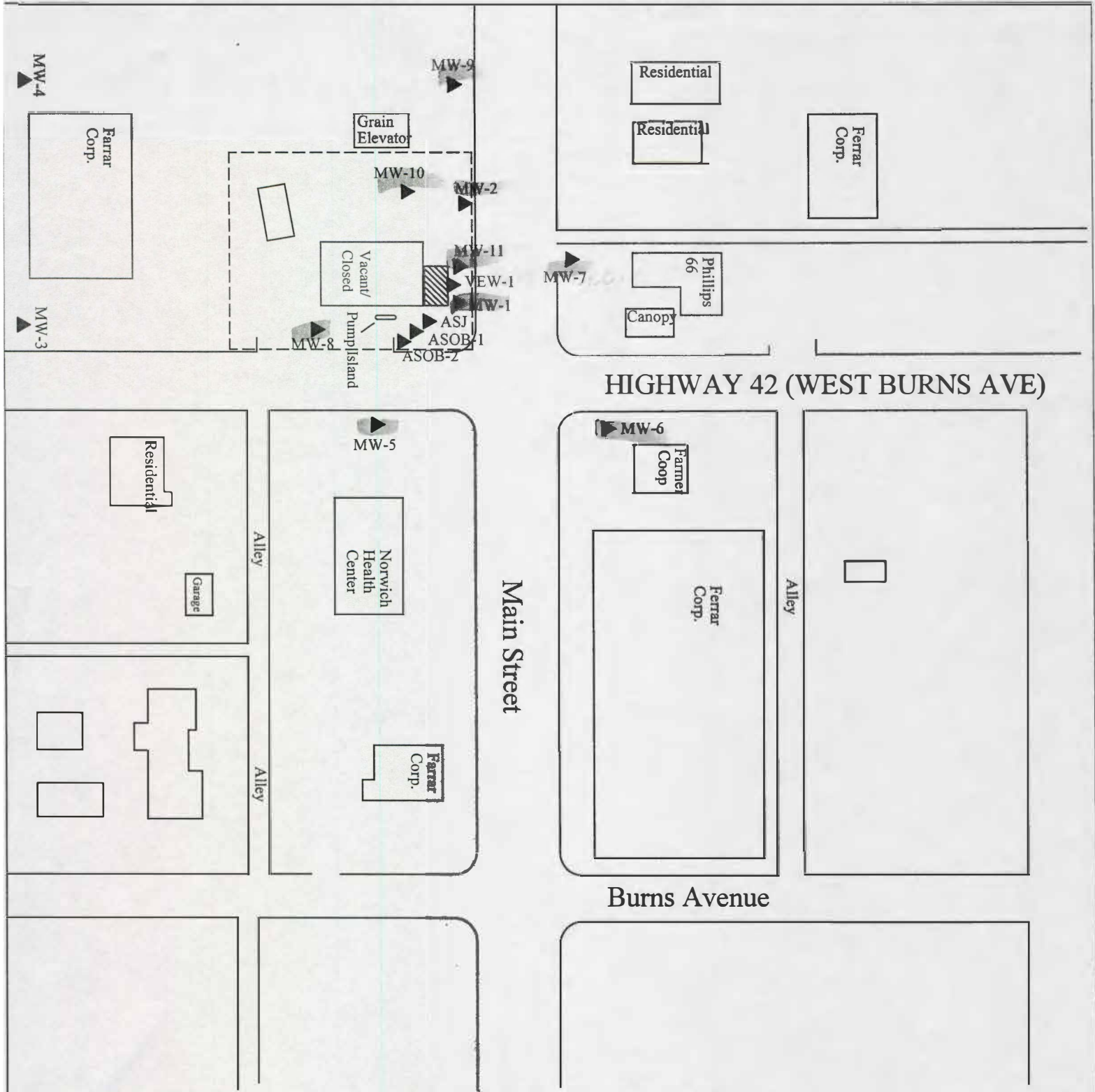

PROJECT: Kyle's Service  
 ADDRESS: 110 W. Burns, W.Hwy 42  
 LOCATION: Norwich, Kansas  
 DRAWN BY: MM DATE: 01/06/96  
 REVISED BY: B.STALNAKER DATE: 8/5/22  
 AEI JOB #: TF296 KDRE JOB #: U2-048-00954  
 SCALE: 1"=100'-0"  
 0 50 100

TITLE:  
 ASSOCIATED ENVIRONMENTAL INC.  
 NOTES: Date Sampled: 9/1/20  
 Former line locations are not known

LEGEND:  
 ⊕ = Monitoring Well  
 ▲ = Plugged Monitoring Well  
 ▨ = Former Underground Fuel Storage Tank  
 --- = Site Property Boundary

