

1 LOCATION OF WATER WELL: Fraction NE 1/4 NW 1/4 NE 1/4 1/4 Section Number 10 Township Number T 30 S Range Number 5 E W
 County: KINGMAN

Street/Rural Address of Well Location; if unknown, distance & direction from nearest town or intersection: If at owner's address, check here
Global Positioning Systems (GPS) information:
 Latitude: 37.458276 (in decimal degrees)
 Longitude: 97.8497761 (in decimal degrees)
 Elevation: _____
 Horizontal Datum: WGS84, NAD83, NAD27
 Collection Method: _____

2 WATER WELL OWNER: KYLE'S SERVICE
 RR#, St. Address, Box #: 110 W. BURNS
 City, State ZIP Code: NORWICH, KS 67118
 GPS unit (Make/Model: _____)
 Digital Map/Photo, Topographic Map, Land Survey
 Est. Accuracy: < 3 m, 3-5 m, 5-15 m, > 15 m

3 MARK WELL'S LOCATION WITH AN "X" IN SECTION BOX:

N	
NW	X NE
SW	SE
S	

4 DEPTH OF WELL 24.65 ft.
WELL'S STATIC WATER LEVEL 20.84 ft.
WELL WAS USED AS:
 Domestic Public Water Supply Dewatering
 Irrigation Oil Field Water Supply Monitoring
 Feedlot Domestic (Lawn & Garden) Injection Well
 Industrial Air Conditioning Other _____
 Was a chemical/bacteriological sample submitted to Department? Yes No

5 TYPE OF BLANK CASING USED:
 Steel RMP (SR) Wrought Fiberglass Other (Specify below)
 PVC ABS Asbestos-Cement Concrete Tile
 Blank casing diameter 2 in. Was casing pulled? Yes No If yes, how much 3'
 Casing height above or below land surface 0 in.

6 GROUT PLUG MATERIAL: Neat cement Cement grout Bentonite Other SOIL 0-0.5
 Grout Plug Intervals: From 0.5 ft. to 24.65 ft., From _____ ft. to _____ ft., From _____ ft. to _____ ft.

What is the nearest source of possible contamination:
 Septic tank Seepage pit Fuel storage Other (specify below)
 Sewer lines Pit privy Fertilizer storage
 Watertight sewer lines Sewage lagoon Insecticide storage
 Lateral lines Feedyard Abandoned water well
 Cess pool Livestock pens Oil well/Gas well
 Direction from well? NORTHWEST
 How many feet? 80

FROM	TO	PLUGGING MATERIALS	FROM	TO	PLUGGING MATERIALS
0	0.5	SOIL			
0.5	24.65	BENTONITE			

7 CONTRACTOR'S OR LANDOWNER'S CERTIFICATION: This water well was plugged under my jurisdiction and was completed on (mo/day/year) 8/4/22 and this record is true to the best of my knowledge and belief. Kansas Water Well Contractor's License No. 585. This Water Well Record was completed on (mo/day/year) 8/3/22 under the business name of ASSOCIATED ENVIRONMENTAL INC. by (signature) [Signature]

Send one white copy to Kansas Department of Health & Environment, Geology Section, 1000 SW Jackson Street, Ste. 420, Topeka, KS 66612-1367. Send one copy to WATER WELL OWNER and retain one for your records.
 Visit us at <http://www.kdheks.gov/waterwell/index.html> Telephone 785-296-5524.

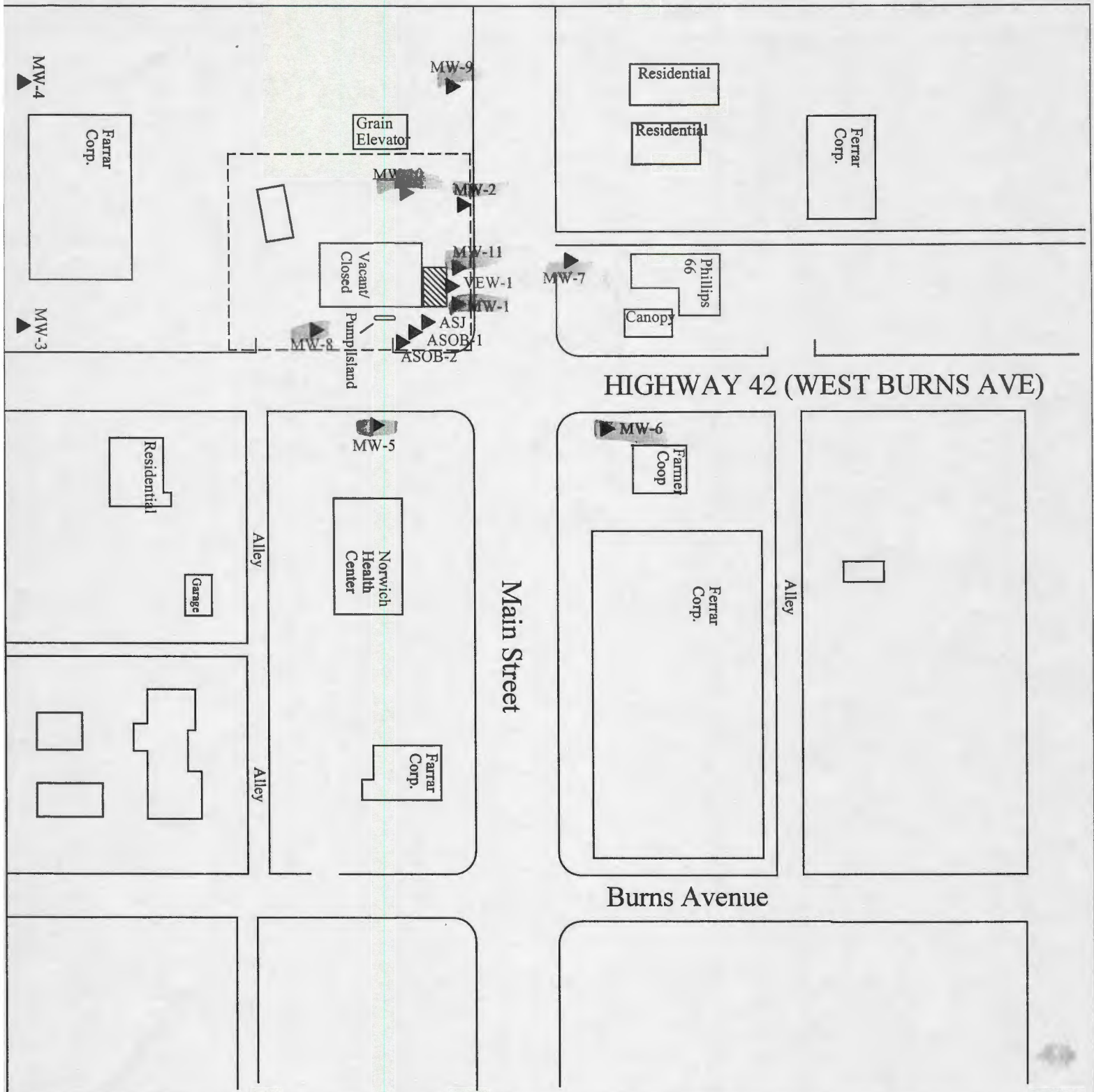

PROJECT: Kyle's Service		TITLE:	LEGEND: = Monitoring Well = Plugged Monitoring Well = Former Underground Fuel Storage Tank = Site Property Boundary	
ADDRESS: 110 W. Burns, W.Hwy 42				
LOCATION: Norwich, Kansas				
DRAWN BY: MM	DATE: 01/06/96	ASSOCIATED ENVIRONMENTAL INC.		
REVISED BY: B.STALNAKER	DATE: 8/5/22			
AEI JOB #: TF296	KDHE JOB #: U2-048-00954			
SCALE: 1"=100'-0"	NOTES: Date Sampled: 9/1/20	Former line locations are not known		

