

WATER WELL PLUGGING RECORD Form WWC-5P KSA 82a-1212 ID NO.

MW7

1 LOCATION OF WATER WELL: Fraction SE 1/4 SW 1/4 SE 1/4 Section Number 3 Township Number T 30 S Range Number 5 E W
 County: KINGMAN

Street/Rural Address of Well Location; if unknown, distance & direction from nearest town or intersection: If at owner's address, check here

Global Positioning Systems (GPS) information:
 Latitude: 37.460098 (in decimal degrees)
 Longitude: 97.8497963 (in decimal degrees)
 Elevation: _____
 Horizontal Datum: WGS84, NAD83, NAD27
 Collection Method: _____

2 WATER WELL OWNER: KYLE'S SERVICE
 RR#, St. Address, Box #: 110 W. BURNS
 City, State ZIP Code: NORWICH, KS 67118

GPS unit (Make/Model: _____)
 Digital Map/Photo, Topographic Map, Land Survey
 Est. Accuracy: < 3 m, 3-5 m, 5-15 m, > 15 m

3 MARK WELL'S LOCATION WITH AN "X" IN SECTION BOX:

4 DEPTH OF WELL 23.96 ft.
 WELL'S STATIC WATER LEVEL 20.66 ft.
 WELL WAS USED AS:
 Domestic Irrigation Public Water Supply Dewatering
 Feedlot Oil Field Water Supply Monitoring
 Industrial Domestic (Lawn & Garden) Injection Well
 Air Conditioning Other _____

Was a chemical/bacteriological sample submitted to Department? Yes No

5 TYPE OF BLANK CASING USED:

Steel RMP (SR) Wrought Fiberglass Other (Specify below)
 PVC ABS Asbestos-Cement Concrete Tile

Blank casing diameter 2 in. Was casing pulled? Yes No If yes, how much 1'
 Casing height above or below land surface 0 in.

6 GROUT PLUG MATERIAL: Neat cement Cement grout Bentonite Other SOIL 0-0.5

Grout Plug Intervals: From 0.5 ft. to 23.96 ft., From _____ ft. to _____ ft., From _____ ft. to _____ ft.

What is the nearest source of possible contamination:

Septic tank Seepage pit Fuel storage Other (specify below)
 Sewer lines Pit privy Fertilizer storage
 Watertight sewer lines Sewage lagoon Insecticide storage
 Lateral lines Feedyard Abandoned water well Oil well/Gas well
 Cess pool Livestock pens

Direction from well? WEST
 How many feet? 40

FROM	TO	PLUGGING MATERIALS	FROM	TO	PLUGGING MATERIALS
0	0.5	SOIL			
0.5	23.96	BENTONITE			

7 CONTRACTOR'S OR LANDOWNER'S CERTIFICATION: This water well was plugged under my jurisdiction and was completed on (mo/day/year) 8/4/22 and this record is true to the best of my knowledge and belief. Kansas Water Well Contractor's License No. 585. This Water Well Record was completed on (mo/day/year) 8/5/22 under the business name of ASSOCIATED ENVIRONMENTAL INC. by (signature) _____

Send one white copy to Kansas Department of Health & Environment, Geology Section, 1000 SW Jackson Street, Ste. 420, Topeka, KS 66612-1367. Send one copy to WATER WELL OWNER and retain one for your records.
 Visit us at <http://www.kdheks.gov/waterwell/index.html> Telephone 785-296-5524.

T30 R5W S00 3;10 KSA829-1212 Kingman

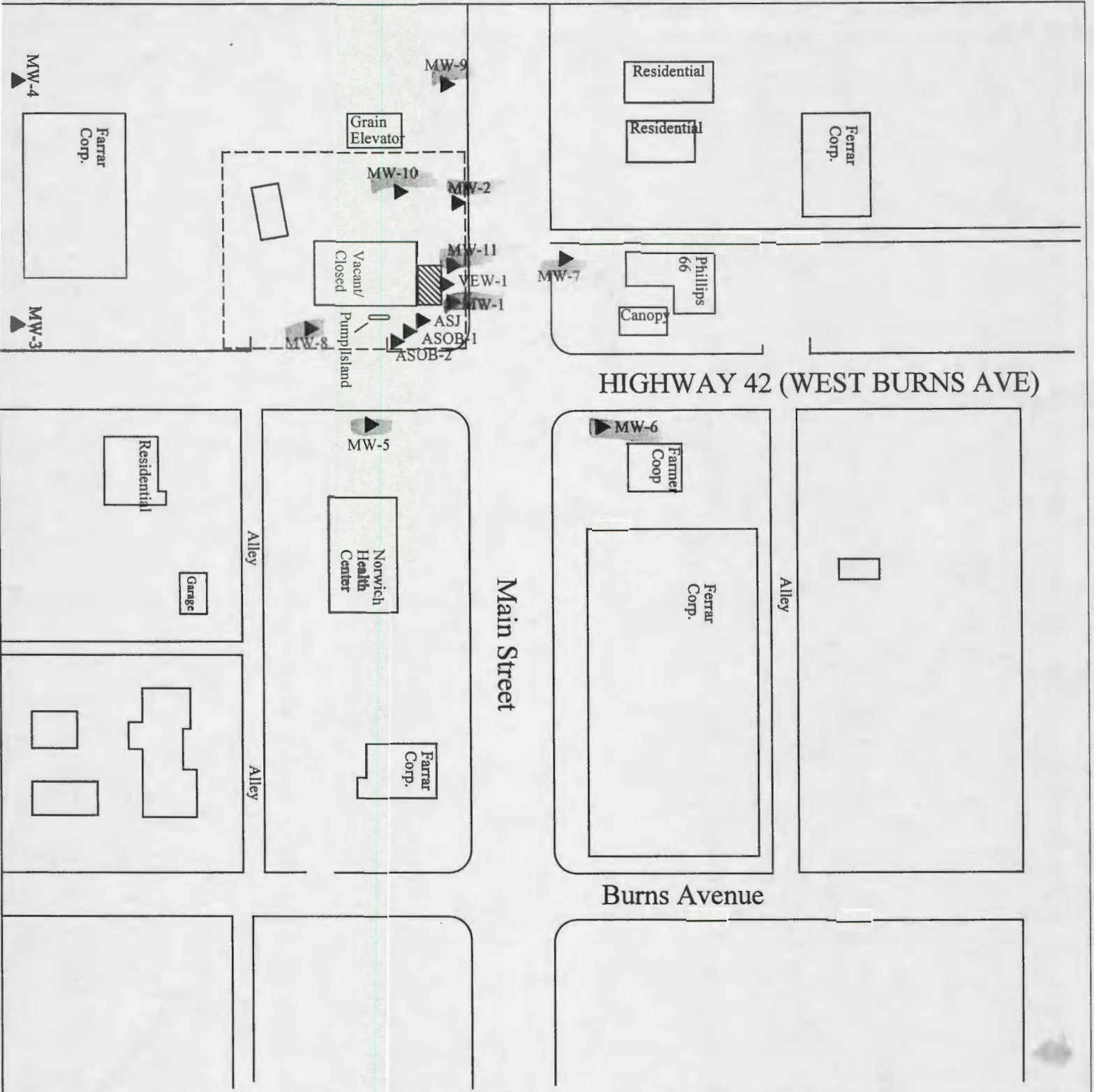

PROJECT: **Kyle's Service**

ADDRESS: **110 W. Burns, W.Hwy 42**

LOCATION: **Norwich, Kansas**

DRAWN BY: **MM** DATE: **01/06/96**

REVISED BY: **B.STALNAKER** DATE: **8/5/22**

AEI JOB #: **TF296** KDHE JOB #: **U2-048-0095.4**

SCALE: **1"=100'-0"**

NOTES: **Date Sampled: 91/2 0**

TITLE:

ASSOCIATED ENVIRONMENTAL INC.

Former line locations are not known

LEGEND:

- = Monitoring Well
- = Plugged Monitoring Well
- = Former Underground Fuel Storage Tank
- = Site Property Boundary