

<b>1 LOCATION OF WATER WELL:</b> County: KINGMAN	Fraction SE ¼ SW ¼ SE ¼ ¼	Section Number 3	Township Number T 30 S	Range Number 5 <input type="checkbox"/> E <input checked="" type="checkbox"/> W
---	------------------------------	---------------------	---------------------------	--

Street/Rural Address of Well Location; if unknown, distance & direction from nearest town or intersection: If at owner's address, check here

**Global Positioning Systems (GPS) information:**  
 Latitude: 37.460098 (in decimal degrees)  
 Longitude: 97.8497963 (in decimal degrees)  
 Elevation: \_\_\_\_\_  
 Horizontal Datum:  WGS84,  NAD83,  NAD27  
 Collection Method: \_\_\_\_\_

**2 WATER WELL OWNER:** KYLE'S SERVICE  
 RR#, St. Address, Box #: 110 W. BURNS  
 City, State ZIP Code: NORWICH, KS 67118

GPS unit (Make/Model: \_\_\_\_\_)  
 Digital Map/Photo,  Topographic Map,  Land Survey  
 Est. Accuracy:  < 3 m,  3-5 m,  5-15 m,  > 15 m

**3 MARK WELL'S LOCATION WITH AN "X" IN SECTION BOX:**

N

NW	NE
SW	SE
	X

S

**4 DEPTH OF WELL** 24.71 ft.  
**WELL'S STATIC WATER LEVEL** 20.76 ft.  
**WELL WAS USED AS:**

<input type="checkbox"/> Domestic	<input type="checkbox"/> Public Water Supply	<input type="checkbox"/> Dewatering
<input type="checkbox"/> Irrigation	<input type="checkbox"/> Oil Field Water Supply	<input checked="" type="checkbox"/> Monitoring
<input type="checkbox"/> Feedlot	<input type="checkbox"/> Domestic (Lawn & Garden)	<input type="checkbox"/> Injection Well
<input type="checkbox"/> Industrial	<input type="checkbox"/> Air Conditioning	<input type="checkbox"/> Other _____

Was a chemical/bacteriological sample submitted to Department? Yes  No

**5 TYPE OF BLANK CASING USED:**

<input checked="" type="checkbox"/> Steel	<input type="checkbox"/> RMP (SR)	<input type="checkbox"/> Wrought	<input type="checkbox"/> Fiberglass	<input type="checkbox"/> Other (Specify below)
<input checked="" type="checkbox"/> PVC	<input type="checkbox"/> ABS	<input type="checkbox"/> Asbestos-Cement	<input type="checkbox"/> Concrete Tile	

Blank casing diameter 2 in. Was casing pulled? Yes  No  If yes, how much \_\_\_\_\_  
 Casing height above or below land surface 5 in.

**6 GROUT PLUG MATERIAL:**  Neat cement  Cement grout  Bentonite  Other CONCRETE 0-0.5

Grout Plug Intervals: From 0.5 ft. to 24.71 ft., From \_\_\_\_\_ ft. to \_\_\_\_\_ ft., From \_\_\_\_\_ ft. to \_\_\_\_\_ ft.

What is the nearest source of possible contamination:

<input type="checkbox"/> Septic tank	<input type="checkbox"/> Seepage pit	<input checked="" type="checkbox"/> Fuel storage	<input type="checkbox"/> Other (specify below)
<input type="checkbox"/> Sewer lines	<input type="checkbox"/> Pit privy	<input type="checkbox"/> Fertilizer storage	
<input type="checkbox"/> Watertight sewer lines	<input type="checkbox"/> Sewage lagoon	<input type="checkbox"/> Insecticide storage	
<input type="checkbox"/> Lateral lines	<input type="checkbox"/> Feedyard	<input type="checkbox"/> Abandoned water well	Direction from well? <u>EAST</u>
<input type="checkbox"/> Cess pool	<input type="checkbox"/> Livestock pens	<input type="checkbox"/> Oil well/Gas well	How many feet? <u>30</u>

FROM	TO	PLUGGING MATERIALS	FROM	TO	PLUGGING MATERIALS
0	0.5	CONCRETE			
0.5	24.71	BENTONITE			

**7 CONTRACTOR'S OR LANDOWNER'S CERTIFICATION:** This water well was plugged under my jurisdiction and was completed on (mo/day/year) 8/4/22 and this record is true to the best of my knowledge and belief. Kansas Water Well Contractor's License No. 585. This Water Well Record was completed on (mo/day/year) 8/5/22 under the business name of ASSOCIATED ENVIRONMENTAL INC. by (signature) \_\_\_\_\_

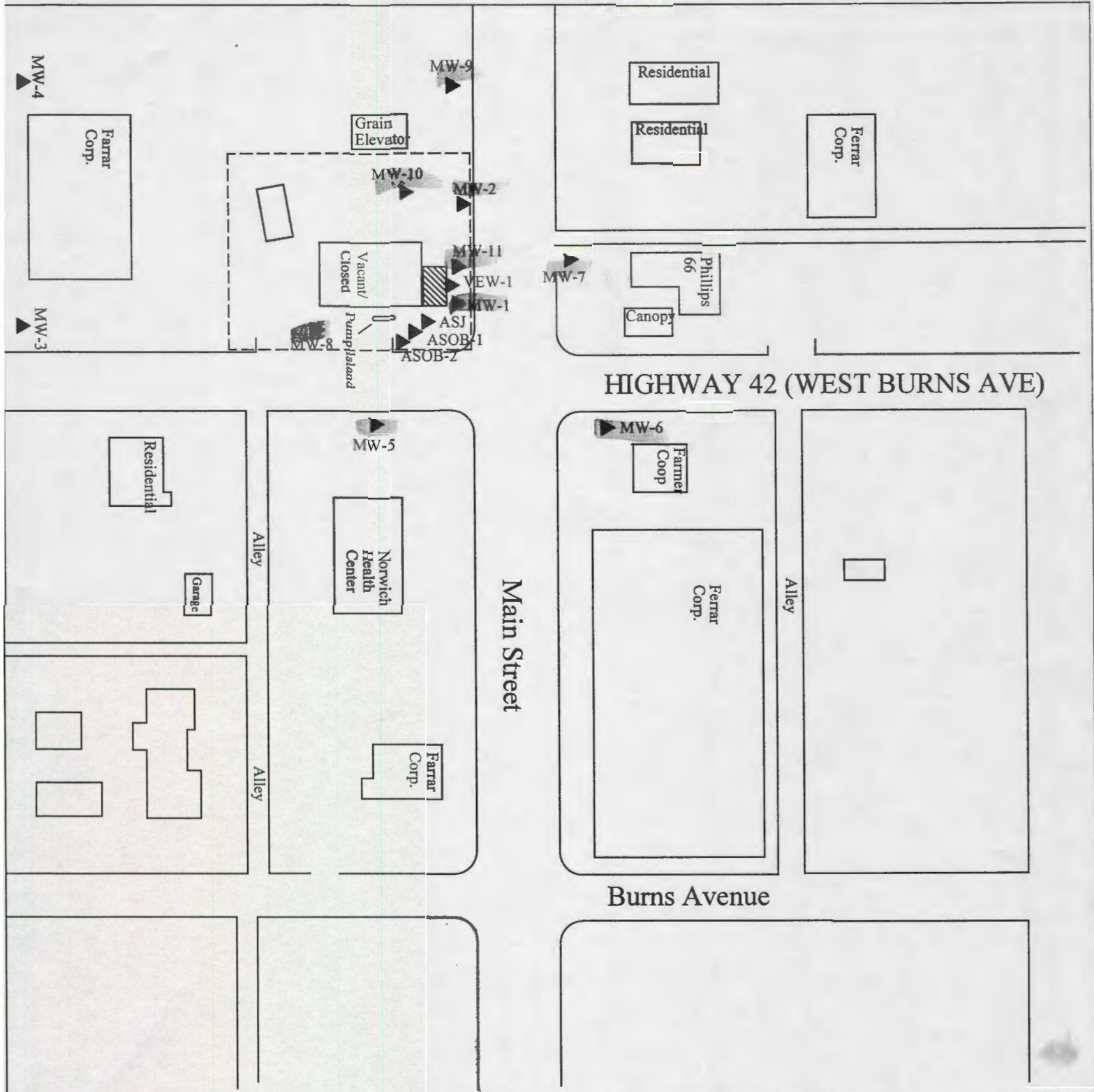

PROJECT: Kyle's Service  
 ADDRESS: 110 W. Burns, W.Hwy 42  
 LOCATION: Norwich, Kansas  
 DRAWN BY: MM DATE: 01/06/96  
 REVISED BY: B.STALNAKER DATE: 8/5/22  
 AEI JOB #: TF296 KDHE JOB #: U2-048-00954  
 SCALE: 1"=100'-0"  
 0 50 100

TITLE:  
 ASSOCIATED ENVIRONMENTAL INC.  
 NOTES: Date Sampled: 9/1/20  
 Former line locations are not known

LEGEND:

- = Monitoring Well
- = Plugged Monitoring Well
- = Former Underground Fuel Storage Tank
- = Site Property Boundary