

1 LOCATION OF WATER WELL: County: KINGMAN	Fraction NE ¼ NW¼ NE ¼ ¼	Section Number 10	Township Number T 30 S	Range Number 5 <input type="checkbox"/> E <input checked="" type="checkbox"/> W
---	-----------------------------	----------------------	---------------------------	--

Street/Rural Address of Well Location; if unknown, distance & direction from nearest town or intersection: If at owner's address, check here

Global Positioning Systems (GPS) information:
 Latitude: 37.458276 (in decimal degrees)
 Longitude: 97.8497761 (in decimal degrees)
 Elevation: _____
 Horizontal Datum: WGS84, NAD83, NAD27
 Collection Method: _____

2 WATER WELL OWNER: KYLE'S SERVICE
 RR#, St. Address, Box #: 110 W. BURNS
 City, State ZIP Code: NORWICH, KS 67118

GPS unit (Make/Model: _____)
 Digital Map/Photo, Topographic Map, Land Survey
 Est. Accuracy: < 3 m, 3-5 m, 5-15 m, > 15 m

<p>3 MARK WELL'S LOCATION WITH AN "X" IN SECTION BOX:</p> <div style="text-align: center;"> <p>N</p> <table border="1" style="margin: auto; border-collapse: collapse;"> <tr> <td style="width: 20px; height: 20px;"></td> <td style="width: 20px; height: 20px; text-align: center;">X</td> <td style="width: 20px; height: 20px;"></td> </tr> <tr> <td style="text-align: center;">NW</td> <td style="text-align: center;">NE</td> <td></td> </tr> <tr> <td style="width: 20px; height: 20px;"></td> <td style="width: 20px; height: 20px;"></td> <td style="width: 20px; height: 20px;"></td> </tr> <tr> <td style="text-align: center;">SW</td> <td style="text-align: center;">SE</td> <td></td> </tr> <tr> <td style="text-align: center;">S</td> <td></td> <td></td> </tr> </table> <p>W E</p> </div>		X		NW	NE					SW	SE		S			<p>4 DEPTH OF WELL <u>28.52</u> ft. WELL'S STATIC WATER LEVEL <u>20.60</u> ft. WELL WAS USED AS:</p> <table style="width: 100%;"> <tr> <td><input type="checkbox"/> Domestic</td> <td><input type="checkbox"/> Public Water Supply</td> <td><input type="checkbox"/> Dewatering</td> </tr> <tr> <td><input type="checkbox"/> Irrigation</td> <td><input type="checkbox"/> Oil Field Water Supply</td> <td><input checked="" type="checkbox"/> Monitoring</td> </tr> <tr> <td><input type="checkbox"/> Feedlot</td> <td><input type="checkbox"/> Domestic (Lawn & Garden)</td> <td><input type="checkbox"/> Injection Well</td> </tr> <tr> <td><input type="checkbox"/> Industrial</td> <td><input type="checkbox"/> Air Conditioning</td> <td><input type="checkbox"/> Other _____</td> </tr> </table> <p>Was a chemical/bacteriological sample submitted to Department? Yes <input type="checkbox"/> No <input checked="" type="checkbox"/></p>	<input type="checkbox"/> Domestic	<input type="checkbox"/> Public Water Supply	<input type="checkbox"/> Dewatering	<input type="checkbox"/> Irrigation	<input type="checkbox"/> Oil Field Water Supply	<input checked="" type="checkbox"/> Monitoring	<input type="checkbox"/> Feedlot	<input type="checkbox"/> Domestic (Lawn & Garden)	<input type="checkbox"/> Injection Well	<input type="checkbox"/> Industrial	<input type="checkbox"/> Air Conditioning	<input type="checkbox"/> Other _____
	X																											
NW	NE																											
SW	SE																											
S																												
<input type="checkbox"/> Domestic	<input type="checkbox"/> Public Water Supply	<input type="checkbox"/> Dewatering																										
<input type="checkbox"/> Irrigation	<input type="checkbox"/> Oil Field Water Supply	<input checked="" type="checkbox"/> Monitoring																										
<input type="checkbox"/> Feedlot	<input type="checkbox"/> Domestic (Lawn & Garden)	<input type="checkbox"/> Injection Well																										
<input type="checkbox"/> Industrial	<input type="checkbox"/> Air Conditioning	<input type="checkbox"/> Other _____																										

5 TYPE OF BLANK CASING USED:

<input type="checkbox"/> Steel	<input type="checkbox"/> RMP (SR)	<input type="checkbox"/> Wrought	<input type="checkbox"/> Fiberglass	<input type="checkbox"/> Other (Specify below) _____
<input checked="" type="checkbox"/> PVC	<input type="checkbox"/> ABS	<input type="checkbox"/> Asbestos-Cement	<input type="checkbox"/> Concrete Tile	

Blank casing diameter 2 in. Was casing pulled? Yes No If yes, how much 3'
 Casing height above or below land surface 0 in.

6 GROUT PLUG MATERIAL: Neat cement Cement grout Bentonite Other GRAVEL 0-0.5

Grout Plug Intervals: From 0.5 ft. to 28.52 ft., From _____ ft. to _____ ft., From _____ ft. to _____ ft.

What is the nearest source of possible contamination:

<input type="checkbox"/> Septic tank	<input type="checkbox"/> Seepage pit	<input checked="" type="checkbox"/> Fuel storage	<input type="checkbox"/> Other (specify below) _____
<input type="checkbox"/> Sewer lines	<input type="checkbox"/> Pit privy	<input type="checkbox"/> Fertilizer storage	
<input type="checkbox"/> Watertight sewer lines	<input type="checkbox"/> Sewage lagoon	<input type="checkbox"/> Insecticide storage	
<input type="checkbox"/> Lateral lines	<input type="checkbox"/> Feedyard	<input type="checkbox"/> Abandoned water well	Direction from well? <u>WEST</u>
<input type="checkbox"/> Cess pool	<input type="checkbox"/> Livestock pens	<input type="checkbox"/> Oil well/Gas well	How many feet? <u>1</u>

FROM	TO	PLUGGING MATERIALS	FROM	TO	PLUGGING MATERIALS
0	0.5	GRAVEL			
0.5	28.52	BENTONITE			

7 CONTRACTOR'S OR LANDOWNER'S CERTIFICATION: This water well was plugged under my jurisdiction and was completed on (mo/day/year) 8/4/22 and this record is true to the best of my knowledge and belief. Kansas Water Well Contractor's License No. 585. This Water Well Record was completed on (mo/day/year) 8/5/22 under the business name of ASSOCIATED ENVIRONMENTAL INC. by (signature)

Send one white copy to Kansas Department of Health & Environment, Geology Section, 1000 SW Jackson Street, Ste. 420, Topeka, KS 66612-1367. Send one copy to WATER WELL OWNER and retain one for your records.
 Visit us at <http://www.kdheks.gov/waterwell/index.html> Telephone 785-296-5524.

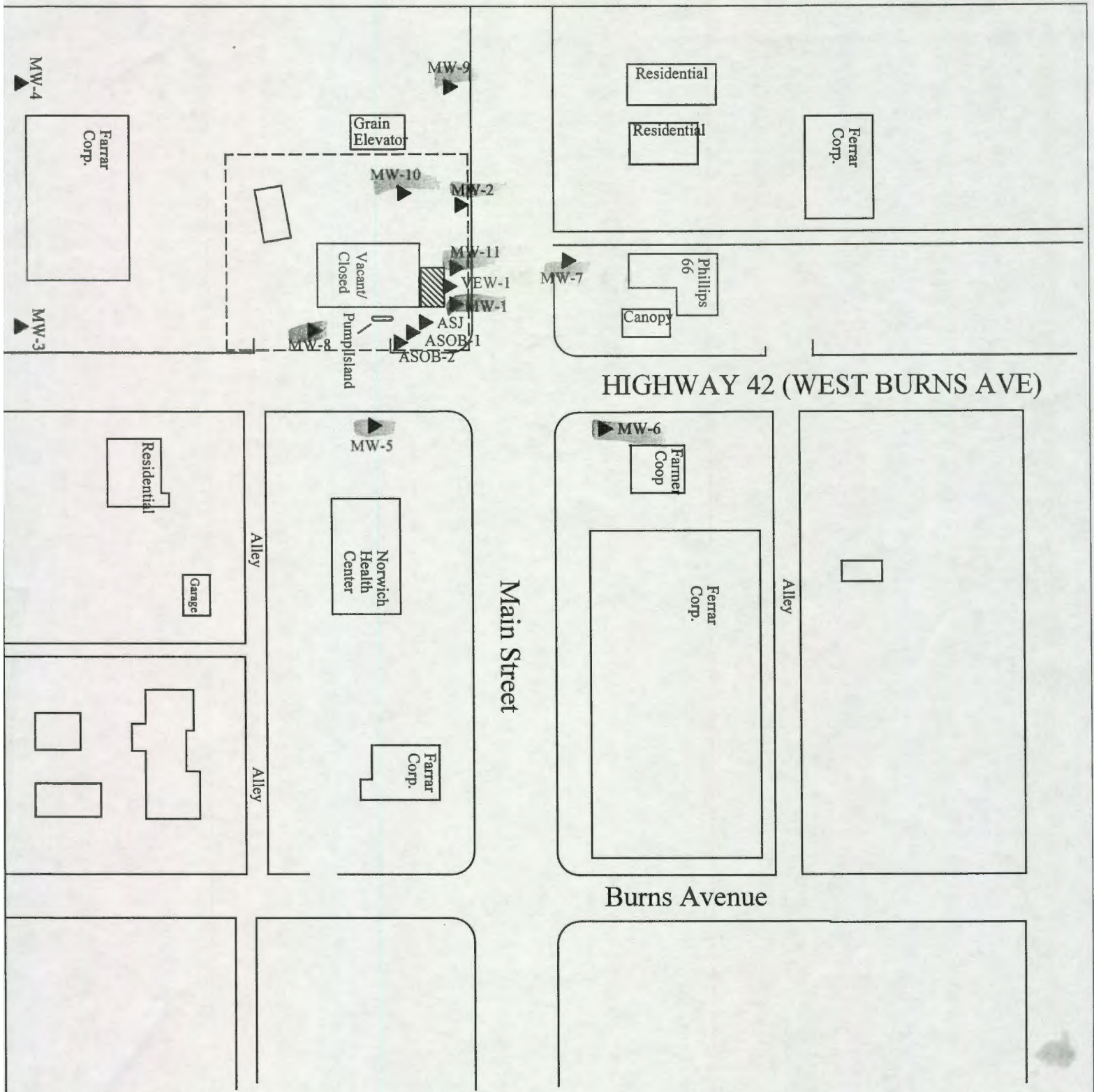

PROJECT: Kyle's Service
 ADDRESS: 110 W. Burns, W.Hwy 42
 LOCATION: Norwich, Kansas
 DRAWN BY: MM DATE: 01/06/96
 REVISED BY: B.STALNAKER DATE: 8/5/22
 AEI JOB #: TF296 KDHE JOB #: U2-048-00954
 SCALE: 1"=100'-0"
 0 50 100

TITLE:
 ASSOCIATED ENVIRONMENTAL INC.
 NOTES: Date Sampled: 9/1/20
 Former line locations are not known

LEGEND:

- = Monitoring Well
- = Plugged Monitoring Well
- = Former Underground Fuel Storage Tank
- = Site Property Boundary