

WATER WELL RECORD

Form WWC-5

Division of Water Resources App. No.

1 LOCATION OF WATER WELL: Fraction $\frac{1}{4}$ SE $\frac{1}{4}$ SE $\frac{1}{4}$ SW $\frac{1}{4}$ Section Number 7 Township No. T 31 S Range Number R 3 E W
 County: Sumner

Street/Rural Address of Well Location; if unknown, distance & direction from nearest town or intersection: If at owner's address, check here
2 miles south of Conway Springs to W 70th Ave N; 2 1/2 miles E

Global Positioning System (GPS) information:
 Latitude: (in decimal degrees)
 Longitude: (in decimal degrees)
 Elevation:
 Datum: WGS 84, NAD 83, NAD 27
 Collection Method:
 GPS unit (Make/Model:)
 Digital Map/Photo, Topographic Map, Land Survey
 Est. Accuracy: <3 m, 3-5 m, 5-15 m, >15 m

2 WATER WELL OWNER: Seimart Farms
 RR#, Street Address, Box #: 1271 W 70th Ave N
 City, State, ZIP Code: Conway Springs, KS 67031

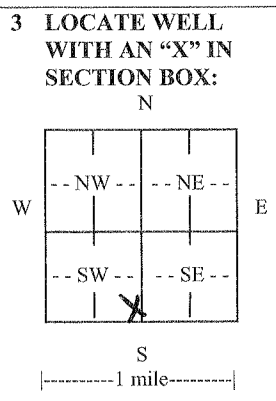

4 DEPTH OF COMPLETED WELL 120 ft.

Depth(s) Groundwater Encountered (1)..... ft. (2)..... ft. (3)..... ft.
 WELL'S STATIC WATER LEVEL 17 ft. below land surface measured on mo/day/yr. 2-9-12
 Pump test data: Well water was.....ft. after..... hours pumping..... gpm
 EST. YIELD 15 gpm. Well water was.....ft. after..... hours pumping..... gpm
 Bore Hole Diameter 12 in. to 120 ft., andin. toft.
 WELL WATER TO BE USED AS: Public water supply Geothermal Injection well
 Domestic Feedlot Oil field water supply Dewatering Other (Specify below)
 Irrigation Industrial Domestic-lawn & garden Monitoring well
 Was a chemical/bacteriological sample submitted to Department? Yes No
 If yes, mo/day/yr sample was submitted.....
 Water well disinfected? Yes No

5 TYPE OF CASING USED: Steel PVC Other

CASING JOINTS: Glued Clamped Welded Threaded
 Casing diameter 5 in. to 20 ft., Diameter in. to ft., Diameter in. to ft.
 Casing height above land surface 20 in., Weightlbs./ft., Wall thickness or gauge No. Sched 40

TYPE OF SCREEN OR PERFORATION MATERIAL:
 Steel Stainless Steel PVC Other (Specify)
 Brass Galvanized Steel None used (open hole)

SCREEN OR PERFORATION OPENINGS ARE:
 Continuous slot Mill slot Gauze wrapped Torch cut Drilled holes None (open hole)
 Louvered shutter Key punched Wire wrapped Saw cut Other (specify)

SCREEN-PERFORATED INTERVALS: From 20 ft. to 120 ft., From ft. to ft.
 From ft. to ft., From ft. to ft.
 GRAVEL PACK INTERVALS: From 20 ft. to 120 ft., From ft. to ft.
 From ft. to ft., From ft. to ft.

6 GROUT MATERIAL: Neat cement Cement grout Bentonite Other

Grout Intervals: From 1 ft. to 20 ft., From ft. to ft., From ft. to ft.

What is the nearest source of possible contamination:
 Septic tank Lateral lines Pit privy Livestock pens Insecticide storage Other (specify below)
 Sewer lines Cesspool Sewage lagoon Fuel storage Abandoned water well
 Watertight sewer lines Seepage pit Feedyard Fertilizer storage Oil well/gas well

Direction from well Open field Distance from well

FROM	TO	LITHOLOGIC LOG	FROM	TO	LITHO. LOG (cont.) or PLUGGING INTERVALS
0	18	Fine Sand.			
18	45	Red shale			
45	49	Blue shale			
49	63	Red shale			
63	66	Blue shale			
66	90	Red shale			
90	94	Blue shale			
94	103	Red shale			
103	107	Blue shale			
107	120	Red shale			

7 CONTRACTOR'S OR LANDOWNER'S CERTIFICATION: This water well was constructed, reconstructed, or plugged under my jurisdiction and was completed on (mo/day/year) 2-9-12 and this record is true to the best of my knowledge and belief.
 Kansas Water Well Contractor's License No. 740 This Water Well Record was completed on (mo/day/year) 2-14-12
 under the business name of Weninger Drilling Inc by (signature) JR Weninger

INSTRUCTIONS: Use typewriter or ball point pen. PLEASE PRESS FIRMLY and PRINT clearly. Please fill in blanks and check the correct answers. Send three copies (white, blue, pink) to Kansas Department of Health and Environment, Bureau of Water, Geology Section, 1000 SW Jackson St., Suite 420, Topeka, Kansas 66612-1367. Telephone 785-296-5524. Send one copy to WATER WELL OWNER and retain one for your records. Include fee of \$5.00 for each constructed well. Visit us at <http://www.kdheks.gov/waterwell/index.html>.