

P

7468

WATER WELL RECORD

Form WWC-5

Division of Water Resources App. No.

1 LOCATION OF WATER WELL: County: Harper Fraction 1/4 1/4 1/4 NW 1/4 Section Number 23 Township No. T 31 S Range Number R 5 [] E [X] W

Street/Rural Address of Well Location; if unknown, distance & direction from nearest town or intersection: Argonia Rd and 60th Ave. Global Positioning System (GPS) information: Latitude: Longitude: Elevation: Datum: [] WGS 84, [] NAD 83, [] NAD 27 Collection Method: [] GPS unit, [] Digital Map/Photo, [] Topographic Map, [] Land Survey Est. Accuracy: [] <3 m, [] 3-5 m, [] 5-15 m, [] >15 m

2 WATER WELL OWNER: Lance Doll RR#, Street Address, Box #: Box 103 City, State, ZIP Code : Clearwater, KS 67026

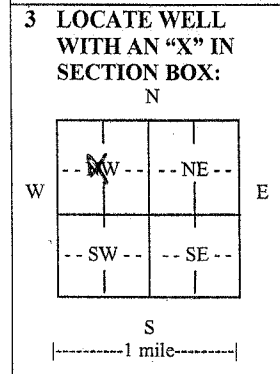

3 LOCATE WELL WITH AN "X" IN SECTION BOX: 4 DEPTH OF COMPLETED WELL 100 ft. Depth(s) Groundwater Encountered (1) 8 ft. (2) ft. (3) ft. WELL'S STATIC WATER LEVEL 8 ft. below land surface measured on mo/day/yr. Pump test data: Well water was ft. after hours pumping gpm EST. YIELD 15 gpm. Well water was ft. after hours pumping gpm Bore Hole Diameter 10 in. to 100 ft. and in. to ft. WELL WATER TO BE USED AS: [] Public water supply [] Geothermal [] Injection well [] Domestic [] Feedlot [] Oil field water supply [] Dewatering [X] Other (Specify below) pasture/livestock [] Irrigation [] Industrial [] Domestic-lawn & garden [] Monitoring well Was a chemical/bacteriological sample submitted to Department? [] Yes [X] No If yes, mo/day/yr sample was submitted. Water well disinfected? [X] Yes [] No

5 TYPE OF CASING USED: [] Steel [X] PVC [] Other CASING JOINTS: [X] Glued [] Clamped [] Welded [] Threaded Casing diameter .5 in. to 100 ft., Diameter in. to ft., Diameter in. to ft. Casing height above land surface 12 in., Weight 2.5 lbs./ft., Wall thickness or gauge No. SDR26 TYPE OF SCREEN OR PERFORATION MATERIAL: [] Steel [] Stainless Steel [X] PVC [] Other (Specify) [] Brass [] Galvanized Steel [] None used (open hole) SCREEN OR PERFORATION OPENINGS ARE: [] Continuous slot [] Mill slot [] Gauze wrapped [] Torch cut [] Drilled holes [] None (open hole) [] Louvered shutter [] Key punched [] Wire wrapped [X] Saw cut [] Other (specify) SCREEN-PERFORATED INTERVALS: From 20 ft. to 100 ft., From ft. to ft., From ft. to ft. GRAVEL PACK INTERVALS: From 20 ft. to 120 ft., From ft. to ft., From ft. to ft.

6 GROUT MATERIAL: [] Neat cement [] Cement grout [X] Bentonite [] Other Grout Intervals: From 3 ft. to 20 ft., From ft. to ft., From ft. to ft. What is the nearest source of possible contamination: [] Septic tank [] Lateral lines [] Pit privy [] Livestock pens [] Insecticide storage [X] Other (specify below) [] Sewer lines [] Cesspool [] Sewage lagoon [] Fuel storage [] Abandoned water well [] Watertight sewer lines [] Seepage pit [] Feedyard [] Fertilizer storage [] Oil well/gas well open field Direction from well Distance from well

Table with 5 columns: FROM, TO, LITHOLOGIC LOG, FROM, TO, LITHO. LOG (cont.) or PLUGGING INTERVALS. Rows: 0' to 3' Topsoil, 3' to 18' Medium Sand, 18' to 100' Shale.

7 CONTRACTOR'S OR LANDOWNER'S CERTIFICATION: This water well was [X] constructed, [] reconstructed, or [] plugged under my jurisdiction and was completed on (mo/day/year) 5-25-13 and this record is true to the best of my knowledge and belief. Kansas Water Well Contractor's License No. 238 This Water Well Record was completed on (mo/day/year) 05/28/2013 under the business name of Premier Pump & Well Service Inc. by (signature) [Signature]

INSTRUCTIONS: Use typewriter or ball point pen. PLEASE PRESS FIRMLY and PRINT clearly. Please fill in blanks and check the correct answers. Send three copies (white, blue, pink) to Kansas Department of Health and Environment, Bureau of Water, Geology Section, 1000 SW Jackson St., Suite 420, Topeka, Kansas 66612-1367. Telephone 785-296-5524. Send one copy to WATER WELL OWNER and retain one for your records. I include fee of \$5.00 for each constructed well. Visit us at http://www.kdheks.gov/waterwell/index.html.