

WATER WELL RECORD Form WWC-5

Original Record Correction Change in Well Use

Division of Water Resources App. No.

Well ID

TMW-9

TMW-9

1 LOCATION OF WATER WELL: County: Sumner Fraction NE 1/4 NE 1/4 NW 1/4 NW 1/4 Section Number 14 Township Number T 32 S Range Number R 1 E W

2 WELL OWNER: Last Name: Shipe First: Carla Street or Rural Address where well is located (if unknown, distance and direction from nearest town or intersection): 124 W. 15th St., Wellington, KS

3 LOCATE WELL WITH 'X' IN SECTION BOX: [Diagram] 4 DEPTH OF COMPLETED WELL: 16 ft. 5 Latitude: 37.27411 Longitude: 97.39981

7 WELL WATER TO BE USED AS: 1. Domestic: 2. Irrigation 3. Feedlot 4. Industrial 5. Public Water Supply 6. Dewatering 7. Aquifer Recharge 8. Monitoring 9. Environmental Remediation 10. Oil Field Water Supply 11. Test Hole 12. Geothermal 13. Other

Was a chemical/bacteriological sample submitted to KDHE? No If yes, date sample was submitted: Water well disinfected? No

8 TYPE OF CASING USED: Steel PVC Other CASING JOINTS: Glued Clamped Welded Threaded Casing diameter 2 in. to 16 ft. Diameter in. to ft. Casing height above land surface -0.5 in. Weight lbs./ft. Wall thickness or gauge No. Sch 40

9 GROUT MATERIAL: Neat cement Cement grout Bentonite Other Grout Intervals: From 1 ft. to 4 ft. From ft. to ft.

Nearest source of possible contamination: Septic Tank Lateral Lines Pit Privy Livestock Pens Insecticide Storage Sewer Lines Cess Pool Sewage Lagoon Fuel Storage Abandoned Water Well Watertight Sewer Lines Seepage Pit Feedyard Fertilizer Storage Oil Well/Gas Well

Table with 5 columns: 10 FROM, TO, LITHOLOGIC LOG, FROM, TO, LITHO. LOG (cont.) or PLUGGING INTERVALS. Rows include Grass/soil, Silt, clayey to sandy, brown to grey, Weathered Shale, chalky, grey, TD 16.

11 CONTRACTOR'S OR LANDOWNER'S CERTIFICATION: This water well was constructed, reconstructed, or plugged under my jurisdiction and was completed on (mo-day-year) 7/15/19 and this record is true to the best of my knowledge and belief.



TMW-6

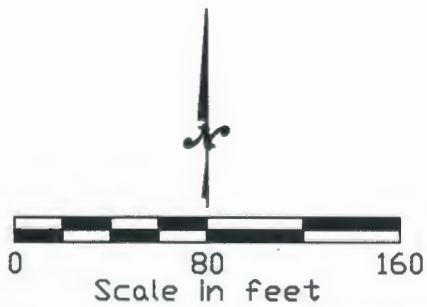

<b>SCS ENGINEERS</b> ENVIRONMENTAL CONSULTANTS AND CONTRACTORS 8575 West 110th Street Overland Park, Kansas 66210					
<b>Figure 1.3A</b> <b>Proposed Monitor Wells</b> Town & Country #12 124 West 15th Street, Wellington, KS					
Project Mgr.	PMG	Date	3/20/19	KDHE Code:	U2-096-00696
Scale:				File Name	Wellington combined TC.dwg
				Proj No.	27218246.00



# FULL SITE SURVEY

Amoco Food Shop  
City of Wellington, Sumner County, Kansas

AMW6 (153' NORTH & 107' WEST)  
AMW7 (226' NORTH & 10' EAST)  
AMW8 (123' NORTH & 389' WEST)

AMW4 (49' NORTH & 93' WEST)

AMW9 (116' SOUTH & 230' WEST)

Point	North Coordinate	East Coordinate	Distance NW Cor. South	From Sec. 14 East	* Elev. Top of Rim or PK Nail	Elev. Top of PVC Pipe	Latitude North	Longitude West
NW Cor. Sec. 14-T32S-R1W	40000	40000						
Well - A.M.W. - 2	39918.41	41041.68	81.59	1041.68	1218.51	1217.97	37.27467	97.39963
Well - A.M.W. - 3	39863.98	41039.41	136.02	1039.41	1218.53	1218.12	37.27452	97.39963
Well - A.M.W. - 4	40022.84	40935.10	22.84 N	935.10	1222.53	1222.18	37.27494	97.40001
Well - A.M.W. - 6	40127.06	40925.22	127.06 N	925.22	1222.68	1222.28	37.27523	97.40006
Well - A.M.W. - 7	40195.01	41044.97	195.01 N	1044.97	1221.08	1220.78	37.27543	97.39966
Well - A.M.W. - 8	40108.14	40642.28	108.14 N	642.28	1212.07	1211.76	37.27514	97.40103
Well - A.M.W. - 9	39863.65	40791.70	136.35	791.70	1319.36	1219.03	37.27449	97.40048
Well - A.M.W. - 10	39905.81	40994.73	94.19	994.73	1219.88	1219.45	37.27463	95.39979
Well - A.M.W. - 12	39951.61	41043.39	48.39	1043.39	1218.35	1217.74	37.27476	97.39964
Well - A.M.W. - 13	39931.38	41112.52	68.62	1112.52	1218.21	1217.38	37.27473	97.39938
Well - A.M.W. - 14	39868.34	41114.02	131.66	1114.02	1217.44	1216.91	37.27456	97.39940
Well - M.W. - 18R	39866.43	41158.47	133.57	1158.47	1217.37	1217.02	37.27454	97.39922
Well - M.W. - S.B.1	39954.37	41077.25	45.63	1077.25	1218.0	GND	37.27477	97.39952
Well - M.W. - S.B.2	39938.91	41070.39	61.09	1070.39	1218.3	GND	37.27473	97.39954
Well - M.W. - S.B.3	39945.87	41058.57	54.13	1058.57	1218.4	GND	37.27474	97.39958
Well - M.W. - S.B.4	39929.47	41056.77	70.53	1056.77	1218.3	GND	37.27470	97.39958
Well - M.W. - S.B.5	39917.85	41075.47	82.15	1075.47	1218.4	GND	37.27467	97.39952
Well - M.W. - S.B.6	39085.74	41068.78	114.26	1068.78	1218.2	GND	37.27458	97.39954
Well - M.W. - S.B.7	39884.88	41105.97	115.12	1105.97	1217.3	GND	37.27458	97.39941
Well - M.W. - S.B.8	39909.63	41105.01	90.37	1105.01	1217.9	GND	37.27465	97.39941
Well - M.W. - S.B.9	39942.18	41115.72	57.82	1115.72	1218.1	GND	37.27475	97.39941
Well - M.W. - S.B.10	39918.84	41146.49	81.16	1146.49	1218.0	GND	37.27459	97.39929
Well - M.W. - S.B.11	39881.54	41143.18	118.46	1143.18	1217.7	GND	37.27459	97.39929
Well - M.W. - S.B.12	39873.99	41062.54	126.01	1062.54	1218.3	GND	37.27455	97.39959
Well - M.W. - S.B.13	39915.75	41066.05	84.25	1066.05	1218.5	GND	37.27465	97.39958
Well - M.W. - E.C.1	39936.63	41093.44	63.37	1093.44			37.27472	97.39946
Well - M.W. - E.C.2	39943.34	41060.99	56.66	1060.99			37.27474	97.39957
Well - M.W. - E.C.3	39937.95	41073.33	62.05	1073.33			37.27472	97.39953
Well - M.W. - E.C.4	39906.43	41092.44	93.57	1092.44			37.27464	97.39946
Well - M.W. - E.C.5	39891.25	41123.18	108.75	1123.18			37.27460	97.39935
Site B.M.	39805.82	41137.41	194.18	1137.41		B.M. Elev. = 1216.47		

Description: " + " cut on northwest corner of curb inlet on south side of West 15th Street.

## LEGEND

- MW1 (triangle in circle) MONITOR WELL LOCATION
- SB1 (circle) GEOPROBE BORING LOCATION
- EC1 (triangle) EC PROBE LOCATION
- (circle with dot) SITE BENCHMARK
- (square with cross) POWER POLE
- (circle with horizontal line) DEADMAN ANCHOR
- (circle with 'S') SANITARY MANHOLE
- (circle with 'D') STORM SEWER MANHOLE
- (plus sign) STREET SIGN
- (arrow) FLOW DIRECTION
- (square with 'T') TELEPHONE PEDESTAL
- (circle with 'M') TELEPHONE MANHOLE
- (square with 'F') FIBER OPTIC VAULT
- (arrow) SITE DRAINAGE DIRECTION
- (line with 'OE') OVERHEAD ELECTRIC LINE
- (line with 'SS') SANITARY SEWER LINE
- (line with 'G') GAS LINE
- (line with 'T') UNDERGROUND TELEPHONE LINE
- (line) CENTERLINE TRAVELWAY
- B/B BACK TO BACK OF CURB
- E/E EDGE TO EDGE OF ROAD

RECEIVED  
AUG 19 2019  
BUREAU OF WATER

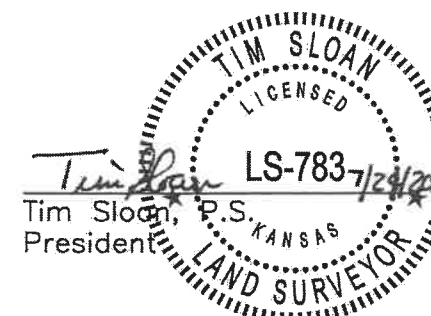

**SMH**  
CONSULTANTS

SCALE: 1"=30'  
0 15' 30'

REVISED 01/10/19  
2017 Vanesta Place, Suite 110 • Manhattan, Kansas 66503  
(785) 776-0541 • FAX 776-9760 • Email: tim@smhconsultants.com  
Project #1907MN1208 DD #116

