

**WATER WELL PLUGGING RECORD Form WWC-5P KSA 82a-1212 ID NO.**

**1 LOCATION OF WATER WELL:** County: Barber Fraction: SE 1/4 1/4 SW 1/4 SW 1/4 Section Number: 12 Township Number: T 32 S Range Number: R 1  E  W

Street/Rural Address of Well Location; if unknown, distance & direction from nearest town or intersection: If at owner's address, check here   
5 E Medicine Lodge

**Global Positioning Systems (GPS) information:**  
Latitude: \_\_\_\_\_ (in decimal degrees)  
Longitude: \_\_\_\_\_ (in decimal degrees)  
Elevation: \_\_\_\_\_  
Horizontal Datum:  WGS84,  NAD83,  NAD27  
Collection Method: \_\_\_\_\_

**2 WATER WELL OWNER:** Kelly Hrencher  
RR#, St. Address, Box #: 3906 Southwest Hwy 100  
City, State ZIP Code: Medicine Lodge, KS 67104

GPS unit (Make/Model): \_\_\_\_\_  
 Digital Map/Photo,  Topographic Map,  Land Survey  
Est. Accuracy:  < 3 m,  3-5 m,  5-15 m,  > 15 m

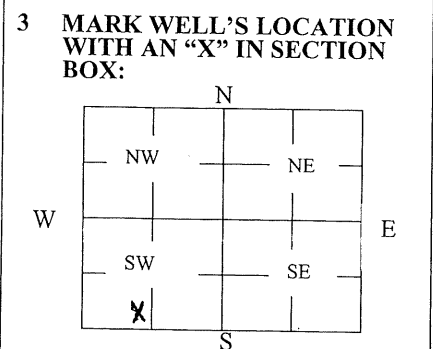

**4 DEPTH OF WELL** 65 ft.  
WELL'S STATIC WATER LEVEL 7 ft.  
WELL WAS USED AS:  
 Domestic  Public Water Supply  Dewatering  
 Irrigation  Oil Field Water Supply  Monitoring  
 Feedlot  Domestic (Lawn & Garden)  Injection Well  
 Industrial  Air Conditioning  Other \_\_\_\_\_  
Was a chemical/bacteriological sample submitted to Department? Yes  No

**5 TYPE OF BLANK CASING USED:**  
 Steel  RMP (SR)  Wrought  Fiberglass  Other (Specify below)  
 PVC  ABS  Asbestos-Cement  Concrete Tile  
Blank casing diameter 16 in. Was casing pulled? Yes  No  If yes, how much \_\_\_\_\_  
Casing height above or below land surface 36 in.

**6 GROUT PLUG MATERIAL:**  Neat cement  Cement grout  Bentonite  Other \_\_\_\_\_  
Grout Plug Intervals: From 3 ft. to 10 ft., From \_\_\_\_\_ ft. to \_\_\_\_\_ ft., From \_\_\_\_\_ ft. to \_\_\_\_\_ ft.  
What is the nearest source of possible contamination:  
 Septic tank  Seepage pit  Fuel storage  Other (specify below)  
 Sewer lines  Pit privy  Fertilizer storage  
 Watertight sewer lines  Sewage lagoon  Insecticide storage  
 Lateral lines  Feedyard  Abandoned water well  
 Cess pool  Livestock pens  Oil well/Gas well  
Direction from well? N  
How many feet? 1320

FROM	TO	PLUGGING MATERIALS	FROM	TO	PLUGGING MATERIALS
-3	10	Bentonite			
10	65	Sand			

*This well had been grouted to 20'*

**7 CONTRACTOR'S OR LANDOWNER'S CERTIFICATION:** This water well was plugged under my jurisdiction and was completed on (mo/day/year) 3-16-24 and this record is true to the best of my knowledge and belief. Kansas Water Well Contractor's License No. \_\_\_\_\_ This Water Well Record was completed on (mo/day/year) 3-13-24 under the business name of Lyman's Inc by (signature) [Signature]

Send one white copy to Kansas Department of Health & Environment, Geology Section, 1000 SW Jackson Street, Ste. 420, Topeka, KS 66612-1367. Send one copy to WATER WELL OWNER and retain one for your records.  
Visit us at <http://www.kdheks.gov/waterwell/index.html> Telephone 785-296-5524.