

WATER WELL PLUGGING RECORD Form WWC-5P KSA 82a-1212 ID NO.

1 LOCATION OF WATER WELL: County: Barber	Fraction SW 1/4 NE 1/4 SE 1/4 NW 1/4	Section Number 12	Township Number T 32 S	Range Number 12 <input type="checkbox"/> E <input checked="" type="checkbox"/> W
--	---	----------------------	---------------------------	---

Street/Rural Address of Well Location; if unknown, distance & direction from nearest town or intersection: If at owner's address, check here 218 S. Main, Medicine Lodge, KS

Global Positioning Systems (GPS) information:
 Latitude: _____ (in decimal degrees)
 Longitude: _____ (in decimal degrees)
 Elevation: _____
 Datum: WGS84, NAD83, NAD27
 Collection Method:
 GPS unit (Make/Model: _____)
 Digital Map/Photo, Topographic Map, Land Survey
 Est. Accuracy: < 3 m, 3-5 m, 5-15 m, > 15 m

2 WATER WELL OWNER: Former FFP #671
 RR#, St. Address, Box #: 218 S. Main Street
 City, State ZIP Code: Medicine Lodge, KS

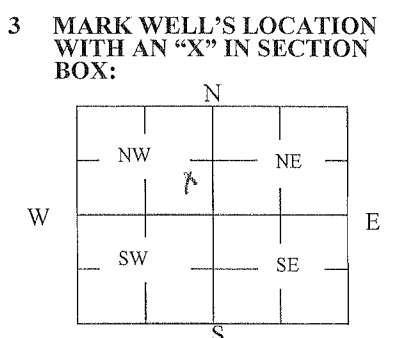

4 DEPTH OF WELL 24.55 ft.
 WELL'S STATIC WATER LEVE 19.51 ft.
 WELL WAS USED AS:
 Domestic Public Water Supply Dewatering
 Irrigation Oil Field Water Supply Monitoring
 Feedlot Domestic (Lawn & Garden) Injection Well
 Industrial Air Conditioning Other MW4
 Was a chemical/bacteriological sample submitted to Department? Yes No

5 TYPE OF BLANK CASING USED:

Steel RMP (SR) Wrought Fiberglass Other (Specify below) _____
 PVC ABS Asbestos-Cement Concrete Tile

Blank casing diameter ² _____ in. Was casing pulled? Yes No If yes, how much ³ 3 Feet
 Casing height above or below land surface _____ in.

6 GROUT PLUG MATERIAL: Neat cement Cement grout Bentonite Other _____

Grout Plug Intervals: From ³ _____ ft. to 24.55 ft., From _____ ft. to _____ ft., From _____ to _____ ft.

What is the nearest source of possible contamination:
 Septic tank Seepage pit Fuel Storage Other (specify below) _____
 Sewer lines Pit privy Fertilizer storage Lust Site
 Watertight sewer lines Sewage lagoon Insecticide storage
 Lateral lines Feedyard Abandoned water well Direction from well? _____
 Cess pool Livestock pens Oil well/Gas well How many feet? _____

FROM	TO	PLUGGING MATERIALS	FROM	TO	PLUGGING MATERIALS
0	1	Rock			
1	3	Native soils			
3	24.55	Bentonite Grout			

7 CONTRACTOR'S OR LANDOWNER'S CERTIFICATION: This water well was plugged under my jurisdiction and was completed on (mo/day/year) 11/16/2011 and this record is true to the best of my knowledge and belief. Kansas Water Well Contractor's License No. 594. This Water Well Record was completed on (mo/day/year) 11/29/2011 under the business name of Coranco Great Plains, Inc. by (signature) [Signature]

INSTRUCTIONS: Use typewriter or ballpoint pen. Please press firmly and print clearly. Please fill in blanks, underline or circle the correct answers. Send top three copies to Kansas Department of Health and Environment, Bureau of Water, Geology Section, 1000 SW Jackson St., Ste. 420, Topeka, Kansas 66612-1367. Telephone: 785/296-5524. Send one to Water Well Owner and retain one for your records. Visit us at <http://www.kdheks.gov/waterwell/index.html>.

Check one: White Copy Blue Copy Pink Copy