

**WATER WELL PLUGGING RECORD Form WWC-5P**

KSA 82a-1212 ID NO.

0041973

<b>1 LOCATION OF WATER WELL:</b> County: <u>Meade</u>	Fraction SW ¼ SE ¼ SW ¼ SE ¼	Section Number <u>3</u>	Township Number T <u>32</u> S	Range Number <u>28</u> <input type="checkbox"/> E <input checked="" type="checkbox"/> W
--	---------------------------------	----------------------------	----------------------------------	--

Street/Rural Address of Well Location; if unknown, distance & direction from nearest town or intersection: If at owner's address, check here

923 W Carthage Ave. Meade, KS 67864

**2 WATER WELL OWNER:** Meade Coop Elevator  
RR#, St. Address, Box #: PO Box 220  
City, State ZIP Code: Meade, KS 67864

**Global Positioning Systems (GPS) information:**  
Latitude: 37.28517114 (in decimal degrees)  
Longitude: 100.3493644 (in decimal degrees)  
Elevation: \_\_\_\_\_  
Datum:  WGS84,  NAD83,  NAD27  
Collection Method: \_\_\_\_\_  
 GPS unit (Make/Model: \_\_\_\_\_)  
 Digital Map/Photo,  Topographic Map,  Land Survey  
Est. Accuracy:  < 3 m,  3-5 m,  5-15 m,  > 15 m

**3 MARK WELL'S LOCATION WITH AN "X" IN SECTION BOX:**

**4 DEPTH OF WELL** 53.00/55.00 ft.  
WELL'S STATIC WATER LEVEL Dry/Dry ft.  
WELL WAS USED AS:  
 Domestic  Public Water Supply  Dewatering  
 Irrigation  Oil Field Water Supply  Monitoring  
 Feedlot  Domestic (Lawn & Garden)  Injection Well  
 Industrial  Air Conditioning  Other SVE  
Was a chemical/bacteriological sample submitted to Department? Yes  No

**5 TYPE OF BLANK CASING USED:**

Steel  RMP (SR)  Wrought  Fiberglass  Other (Specify below) \_\_\_\_\_  
 PVC  ABS  Asbestos-Cement  Concrete Tile

Blank casing diameter 4 in. Was casing pulled? Yes  No  If yes, how much \_\_\_\_\_  
Casing height above or below land surface 36 in.

**6 GROUT PLUG MATERIAL:**  Neat cement  Cement grout  Bentonite  Other \_\_\_\_\_

Grout Plug Intervals: From 3 ft. to 53.00 ft., From 3 ft. to 55.00 ft., From \_\_\_\_\_ to \_\_\_\_\_ ft.

What is the nearest source of possible contamination:  
 Septic tank  Seepage pit  Fuel Storage  Other (specify below) \_\_\_\_\_  
 Sewer lines  Pit privy  Fertilizer storage  Lust Site \_\_\_\_\_  
 Watertight sewer lines  Sewage lagoon  Insecticide storage \_\_\_\_\_  
 Lateral lines  Feedyard  Abandoned water well Direction from well? \_\_\_\_\_  
 Cess pool  Livestock pens  Oil well/Gas well How many feet? \_\_\_\_\_

FROM	TO	PLUGGING MATERIALS	FROM	TO	PLUGGING MATERIALS
0	3	Native Surface	0	3	Native Surface
3	53.00	Bentonite Grout	3	55.00	Bentonite Grout
					SVE/AS 8

**7 CONTRACTOR'S OR LANDOWNER'S CERTIFICATION:** This water well was plugged under my jurisdiction and was completed on (mo/day/year) 4/26/2013 and this record is true to the best of my knowledge and belief. Kansas Water Well Contractor's License No. 594. This Water Well Record was completed on (mo/day/year) 5/10/2013 under the business name of Coranco Great Plains Inc. by (signature) Larry [Signature]

**INSTRUCTIONS:** Use typewriter or ballpoint pen. Please press firmly and print clearly. Please fill in blanks, underline or circle the correct answers. Send top three copies to Kansas Department of Health and Environment, Bureau of Water, Geology Section, 1000 SW Jackson St., Ste. 420, Topeka, Kansas 66612-1367. Telephone: 785/296-5524. Send one to Water Well Owner and retain one for your records. Visit us at <http://www.kdheks.gov/waterwell/index.html>.

Check one:  White Copy  Blue Copy  Pink Copy



**Legend**

- MW5 - Monitoring Well Location
- ⊕ SB3 - Soil Boring Location
- ⊙ ASW1 - Air Sparge Well Location
- VOBW1 - Vapor Observation Well
- ⊠ SVE1 - Soil Vapor Extraction Well
- ⊙ MW11 - Destroyed/Abandoned Well
- Property Line
- OH- Overhead Electric
- FO- Fiber Optic (~ 24" deep)
- BT- Buried Telephone (~ 24" deep)
- W- Water Line (~ 48" deep)
- SA- Sanitary Sewer (~ 60" deep)
- ST- Storm Sewer (~ 12" deep)
- G- Natural Gas (~ 30" deep)
- BE- Buried Electric
- PP - Power Pole
- LP - Light Pole
- BP - Brace Pole
- GM - Gas Meter
- WM - Water Meter
- WV - Water Valve
- WS - Water Spigot
- FH - Fire Hydrant
- - Steel Bollard
- ⊠ - Telephone Pedestal

Scale In Feet  
0 120 240

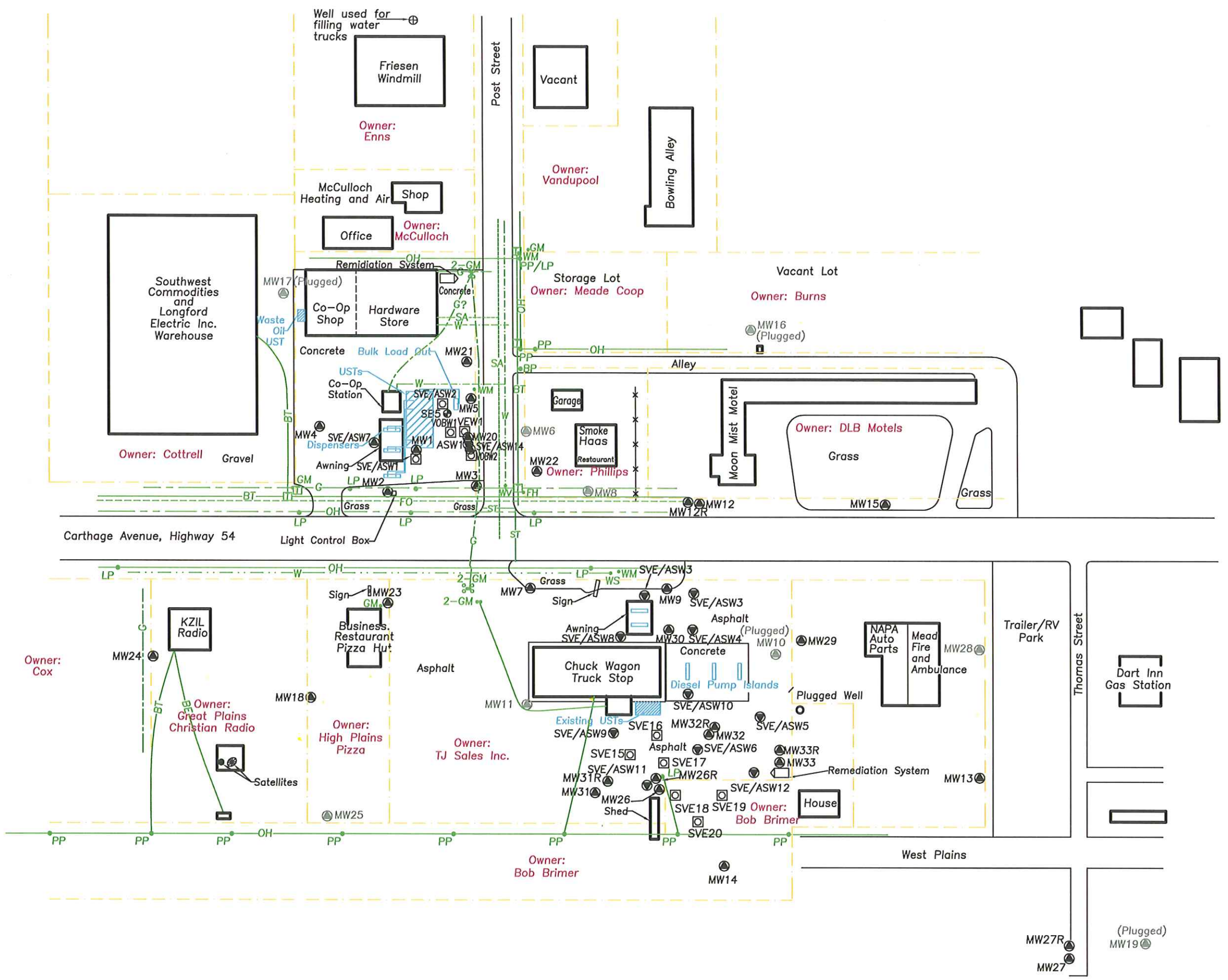

Site Base Map  
 Meade Coop  
 Meade, KS  
 Quarterly Monitoring Report  
 GCP Project #97013  
 Prepared By: RH Date: 06-11-12  
 Reviewed By: LD Date: 06-11-12  
 Figure 1  
 Coranco Great Plains, Inc. PO Box 23, Wahoo, NE 68066