

**WATER WELL PLUGGING RECORD Form WWC-5P KSA 82a-1212 ID NO.**

<b>1 LOCATION OF WATER WELL:</b> County: <u>Meade</u>	Fraction <u>SW 1/4 SE 1/4 SW 1/4 SE 1/4</u>	Section Number <u>3</u>	Township Number <u>T 32 S</u>	Range Number <u>28</u> <input type="checkbox"/> E <input checked="" type="checkbox"/> W
--	--	----------------------------	----------------------------------	--

Street/Rural Address of Well Location; if unknown, distance & direction from nearest town or intersection: If at owner's address, check here

923 W Carthage Ave. Meade, KS 67864

**2 WATER WELL OWNER:** Meade Coop Elevator  
RR#, St. Address, Box #: PO Box 220  
City, State ZIP Code: Meade, KS 67864

**Global Positioning Systems (GPS) information:**  
Latitude: 37.28581966 (in decimal degrees)  
Longitude: 100.3499684 (in decimal degrees)  
Elevation: \_\_\_\_\_  
Datum:  WGS84,  NAD83,  NAD27  
Collection Method: \_\_\_\_\_  
 GPS unit (Make/Model: \_\_\_\_\_)  
 Digital Map/Photo,  Topographic Map,  Land Survey  
Est. Accuracy:  < 3 m,  3-5 m,  5-15 m,  > 15 m

<p><b>3 MARK WELL'S LOCATION WITH AN "X" IN SECTION BOX:</b></p> <div style="text-align: center;"> <p>N</p> <table border="1" style="margin: auto; border-collapse: collapse;"> <tr> <td style="width: 20px;">NW</td> <td style="width: 20px;">NE</td> </tr> <tr> <td style="width: 20px;">SW</td> <td style="width: 20px;">SE</td> </tr> </table> <p style="text-align: center;">S</p> <p style="text-align: center;">X</p> </div>	NW	NE	SW	SE	<p><b>4 DEPTH OF WELL</b> <u>60.71</u> ft. WELL'S STATIC WATER LEVEL <u>53.10</u> ft. WELL WAS USED AS:  <input type="checkbox"/> Domestic      <input type="checkbox"/> Public Water Supply      <input type="checkbox"/> Dewatering  <input type="checkbox"/> Irrigation      <input type="checkbox"/> Oil Field Water Supply      <input type="checkbox"/> Monitoring  <input type="checkbox"/> Feedlot      <input type="checkbox"/> Domestic (Lawn &amp; Garden)      <input checked="" type="checkbox"/> Injection Well  <input type="checkbox"/> Industrial      <input type="checkbox"/> Air Conditioning      <input checked="" type="checkbox"/> Other <u>ASW</u></p> <p>Was a chemical/bacteriological sample submitted to Department? Yes <input type="checkbox"/> No <input checked="" type="checkbox"/></p>
NW	NE				
SW	SE				

**5 TYPE OF BLANK CASING USED:**

Steel     RMP (SR)     Wrought     Fiberglass     Other (Specify below) \_\_\_\_\_  
 PVC     ABS     Asbestos-Cement     Concrete Tile

Blank casing diameter 2 in. Was casing pulled? Yes  No  If yes, how much \_\_\_\_\_  
Casing height above or below land surface 36 in.

**6 GROUT PLUG MATERIAL:**  Neat cement     Cement grout     Bentonite     Other \_\_\_\_\_

Grout Plug Intervals: From 3 ft. to 60.71 ft., From \_\_\_\_\_ ft. to \_\_\_\_\_ ft., From \_\_\_\_\_ to \_\_\_\_\_ ft.

What is the nearest source of possible contamination:  
 Septic tank     Seepage pit     Fuel Storage     Other (specify below) \_\_\_\_\_  
 Sewer lines     Pit privy     Fertilizer storage     Lust Site \_\_\_\_\_  
 Watertight sewer lines     Sewage lagoon     Insecticide storage    \_\_\_\_\_  
 Lateral lines     Feedyard     Abandoned water well    Direction from well? \_\_\_\_\_  
 Cess pool     Livestock pens     Oil well/Gas well    How many feet? \_\_\_\_\_

FROM	TO	PLUGGING MATERIALS	FROM	TO	PLUGGING MATERIALS
0	3	Native Surface			
3	60.71	Bentonite Grout			
					ASW1

**7 CONTRACTOR'S OR LANDOWNER'S CERTIFICATION:** This water well was plugged under my jurisdiction and was completed on (mo/day/year) 4/26/2013 and this record is true to the best of my knowledge and belief. Kansas Water Well Contractor's License No. 594. This Water Well Record was completed on (mo/day/year) 5/10/2013 under the business name of Coranco Great Plains Inc. by (signature) [Signature]

**INSTRUCTIONS:** Use typewriter or ballpoint pen. Please press firmly and print clearly. Please fill in blanks, underline or circle the correct answers. Send top three copies to Kansas Department of Health and Environment, Bureau of Water, Geology Section, 1000 SW Jackson St., Ste. 420, Topeka, Kansas 66612-1367. Telephone: 785/296-5524. Send one to Water Well Owner and retain one for your records. Visit us at <http://www.kdheks.gov/waterwell/index.html>.

Check one:  White Copy     Blue Copy     Pink Copy

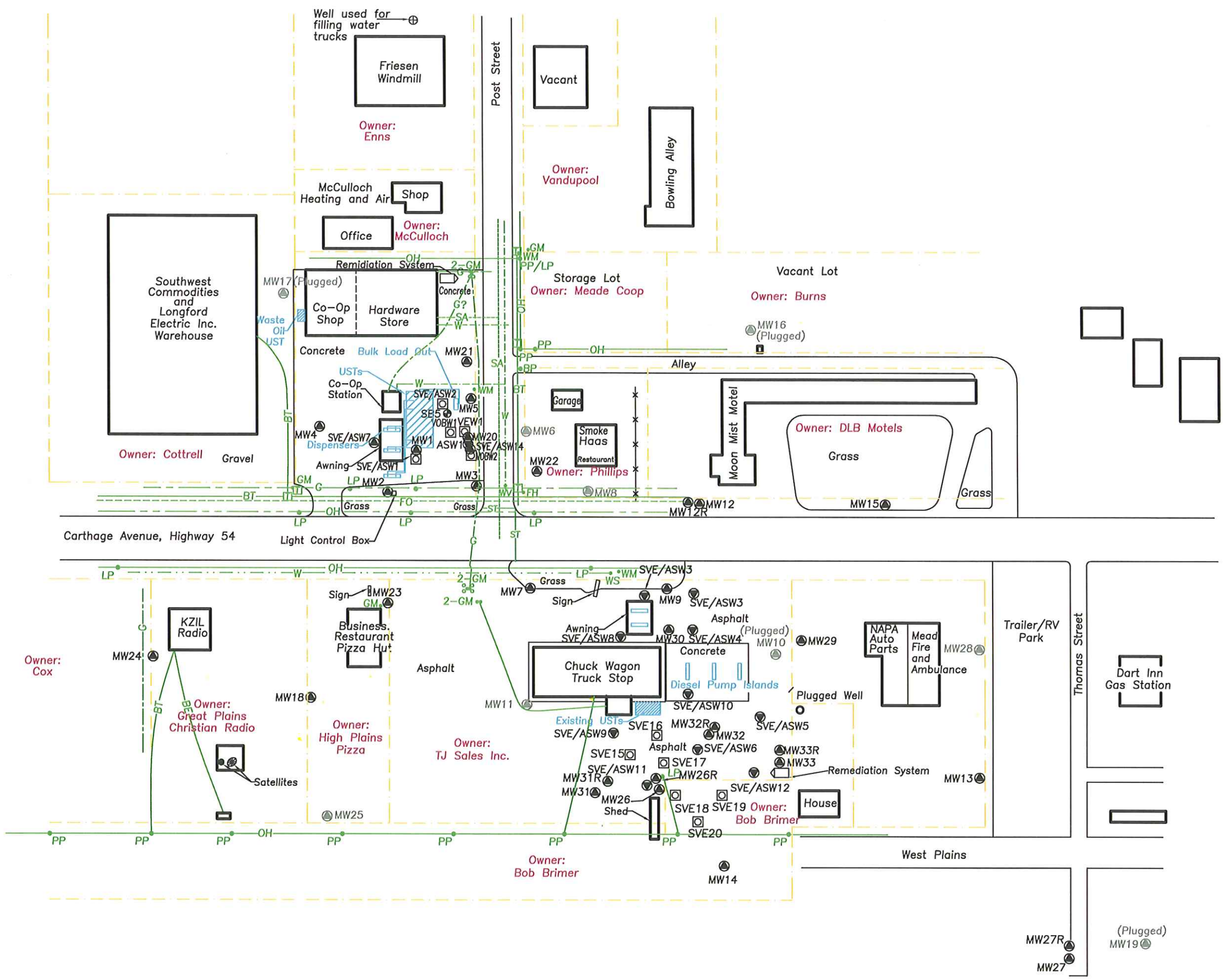

**Legend**

- MW5 - Monitoring Well Location
- ⊕ SB3 - Soil Boring Location
- ⊙ ASW1 - Air Sparge Well Location
- VOBW1 - Vapor Observation Well
- SVE1 - Soil Vapor Extraction Well
- ⊙ MW11 - Destroyed/Abandoned Well
- Property Line
- OH- Overhead Electric
- FO- Fiber Optic (~ 24" deep)
- BT- Buried Telephone (~ 24" deep)
- W- Water Line (~ 48" deep)
- SA- Sanitary Sewer (~ 60" deep)
- ST- Storm Sewer (~ 12" deep)
- G- Natural Gas (~ 30" deep)
- BE- Buried Electric
- PP - Power Pole
- LP - Light Pole
- BP - Brace Pole
- GM - Gas Meter
- WM - Water Meter
- WV - Water Valve
- WS - Water Spigot
- FH - Fire Hydrant
- - Steel Bollard
- - Telephone Pedestal

Scale In Feet  
0 120 240

Site Base Map  
Meade Coop  
Meade, KS  
Quarterly Monitoring Report  
GCP Project #97013  
Prepared By: RH Date: 06-11-12  
Reviewed By: LD Date: 06-11-12  
Figure 1  
Coranco Great Plains, Inc. PO Box 23, Wahoo, NE 68066