

WATER WELL PLUGGING RECORD Form WWC-5P KSA 82a-1212 ID NO.

1 LOCATION OF WATER WELL: County: Meade Fraction SW 1/4 SE 1/4 SW 1/4 SE 1/4 Section Number 3 Township Number T 32 S Range Number 28 [] E [x] W

Street/Rural Address of Well Location; if unknown, distance & direction from nearest town or intersection: If at owner's address, check here [] 923 W Carthage Ave. Meade, KS 67864 Global Positioning Systems (GPS) information: Latitude: 37.28585823 (in decimal degrees) Longitude: 100.3500459 (in decimal degrees) Elevation: Datum: [] WGS84, [x] NAD83, [] NAD27 Collection Method: [] GPS unit (Make/Model: [] Digital Map/Photo, [] Topographic Map, [] Land Survey Est. Accuracy: [] < 3 m, [] 3-5 m, [] 5-15 m, [] > 15 m

2 WATER WELL OWNER: Meade Coop Elevator RR#, St. Address, Box #: PO Box 220 City, State ZIP Code: Meade, KS 67864 3 MARK WELL'S LOCATION WITH AN "X" IN SECTION BOX: [Diagram showing a 3x3 grid with NW, NE, SW, SE, and an 'X' in the SE section] 4 DEPTH OF WELL 54.00 ft. WELL'S STATIC WATER LEVEL Dry ft. WELL WAS USED AS: [] Domestic [] Irrigation [] Feedlot [] Industrial [] Public Water Supply [] Oil Field Water Supply [] Domestic (Lawn & Garden) [] Air Conditioning [] Dewatering [x] Monitoring [] Injection Well [] Other VOBW Was a chemical/bacteriological sample submitted to Department? Yes [] No [x]

5 TYPE OF BLANK CASING USED: [] Steel [x] PVC [] RMP (SR) [] ABS [] Wrought [] Asbestos-Cement [] Fiberglass [] Concrete Tile [] Other (Specify below) Blank casing diameter 4 in. Was casing pulled? Yes [] No [x] If yes, how much Casing height above or below land surface 36 in.

6 GROUT PLUG MATERIAL: [] Neat cement [] Cement grout [x] Bentonite [] Other Grout Plug Intervals: From 3 ft. to 54.00 ft., From ft. to ft., From to ft. What is the nearest source of possible contamination: [] Septic tank [] Sewer lines [] Watertight sewer lines [] Lateral lines [] Cess pool [] Seepage pit [] Pit privy [] Sewage lagoon [] Feedyard [] Livestock pens [] Fuel Storage [] Fertilizer storage [] Insecticide storage [] Abandoned water well [] Oil well/Gas well [x] Other (specify below) Lust Site Direction from well? How many feet?

Table with columns: FROM, TO, PLUGGING MATERIALS. Row 1: 0, 3, Native Surface. Row 2: 3, 54.00, Bentonite Grout. Row 3: (blank), (blank), VOBW1.

7 CONTRACTOR'S OR LANDOWNER'S CERTIFICATION: This water well was plugged under my jurisdiction and was completed on (mo/day/year) 4/26/2013 and this record is true to the best of my knowledge and belief. Kansas Water Well Contractor's License No. 594. This Water Well Record was completed on (mo/day/year) 5/10/2013 under the business name of Coranco Great Plains Inc. by (signature) [Signature]

INSTRUCTIONS: Use typewriter or ballpoint pen. Please press firmly and print clearly. Please fill in blanks, underline or circle the correct answers. Send top three copies to Kansas Department of Health and Environment, Bureau of Water, Geology Section, 1000 SW Jackson St., Ste. 420, Topeka, Kansas 66612-1367. Telephone: 785/296-5524. Send one to Water Well Owner and retain one for your records. Visit us at http://www.kdheks.gov/waterwell/index.html.

Check one: [] White Copy [] Blue Copy [] Pink Copy

RECEIVED SURVEY

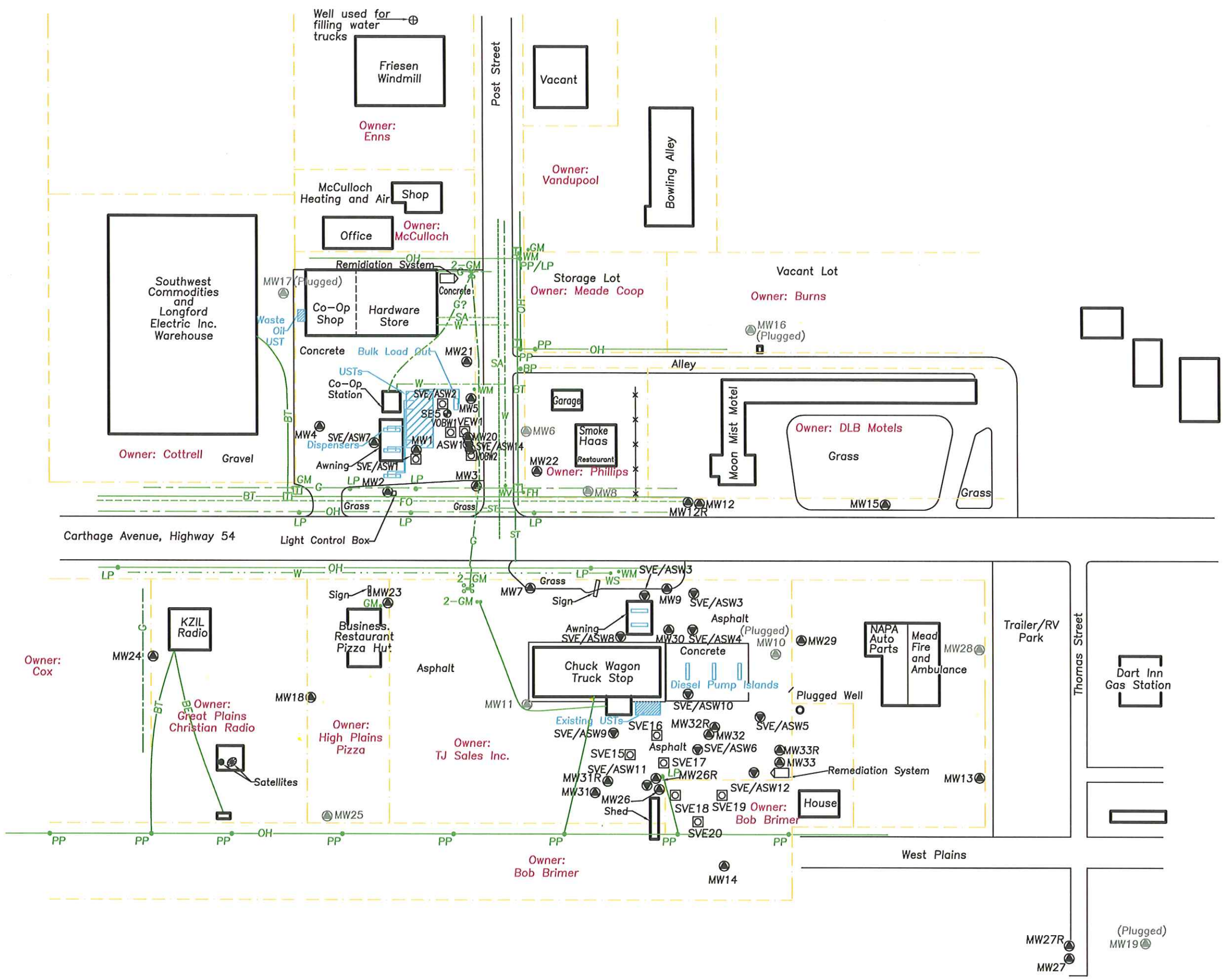

Legend

- MW5 - Monitoring Well Location
- ⊕ SB3 - Soil Boring Location
- ⊙ ASW1 - Air Sparge Well Location
- VOBW1 - Vapor Observation Well
- SVE1 - Soil Vapor Extraction Well
- ⊙ MW11 - Destroyed/Abandoned Well
- - - Property Line
- OH- Overhead Electric
- FO- Fiber Optic (~ 24" deep)
- BT- Buried Telephone (~ 24" deep)
- W- Water Line (~ 48" deep)
- SA- Sanitary Sewer (~ 60" deep)
- ST- Storm Sewer (~ 12" deep)
- G- Natural Gas (~ 30" deep)
- BE- Buried Electric
- PP - Power Pole
- LP - Light Pole
- BP - Brace Pole
- GM - Gas Meter
- WM - Water Meter
- WV - Water Valve
- WS - Water Spigot
- FH - Fire Hydrant
- - Steel Bollard
- - Telephone Pedestal

Scale In Feet
0 120 240

Site Base Map
Meade Coop
Meade, KS
Quarterly Monitoring Report
GCP Project #97013
Prepared By: RH Date: 06-11-12
Reviewed By: LD Date: 06-11-12
Figure 1
Coranco Great Plains, Inc. PO Box 23, Wahoo, NE 68066