

WATER WELL PLUGGING RECORD Form WWC-5P KSA 82a-1212 ID NO.

1 LOCATION OF WATER WELL: County: <u>Meade</u>	Fraction <u>SW 1/4 SE 1/4 SW 1/4 SE 1/4</u>	Section Number <u>3</u>	Township Number <u>T 32 S</u>	Range Number <u>28</u> <input type="checkbox"/> E <input checked="" type="checkbox"/> W
--	--	----------------------------	----------------------------------	--

Street/Rural Address of Well Location; if unknown, distance & direction from nearest town or intersection: If at owner's address, check here
923 W Carthage Ave. Meade, KS 67864

Global Positioning Systems (GPS) information:
 Latitude: 37.2857826 (in decimal degrees)
 Longitude: 100.3499595 (in decimal degrees)
 Elevation: _____
 Datum: WGS84, NAD83, NAD27
 Collection Method:
 GPS unit (Make/Model: _____)
 Digital Map/Photo, Topographic Map, Land Survey
 Est. Accuracy: < 3 m, 3-5 m, 5-15 m, > 15 m

2 WATER WELL OWNER: Meade Coop Elevator
 RR#, St. Address, Box #: PO Box 220
 City, State ZIP Code: Meade, KS 67864

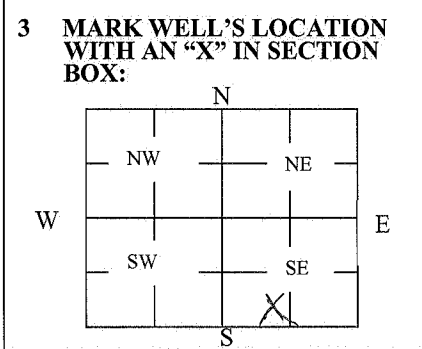

4 DEPTH OF WELL 53.40 ft.
 WELL'S STATIC WATER LEVEL Dry ft
 WELL WAS USED AS:
 Domestic Public Water Supply Dewatering
 Irrigation Oil Field Water Supply Monitoring
 Feedlot Domestic (Lawn & Garden) Injection Well
 Industrial Air Conditioning Other VOBW
 Was a chemical/bacteriological sample submitted to Department? Yes No

5 TYPE OF BLANK CASING USED:

Steel RMP (SR) Wrought Fiberglass Other (Specify below) _____
 PVC ABS Asbestos-Cement Concrete Tile

Blank casing diameter 4 in. Was casing pulled? Yes No If yes, how much _____
 Casing height above or below land surface 36 in.

6 GROUT PLUG MATERIAL: Neat cement Cement grout Bentonite Other _____
 Grout Plug Intervals: From 3 ft. to 53.40 ft., From _____ ft. to _____ ft., From _____ to _____ ft.

What is the nearest source of possible contamination:
 Septic tank Seepage pit Fuel Storage Other (specify below) _____
 Sewer lines Pit privy Fertilizer storage Lust Site _____
 Watertight sewer lines Sewage lagoon Insecticide storage _____
 Lateral lines Feedyard Abandoned water well Direction from well? _____
 Cess pool Livestock pens Oil well/Gas well How many feet? _____

FROM	TO	PLUGGING MATERIALS	FROM	TO	PLUGGING MATERIALS
0	3	Native Surface			
3	53.40	Bentonite Grout			
					VOBW2

7 CONTRACTOR'S OR LANDOWNER'S CERTIFICATION: This water well was plugged under my jurisdiction and was completed on (mo/day/year) 4/26/2013 and this record is true to the best of my knowledge and belief. Kansas Water Well Contractor's License No. 594. This Water Well Record was completed on (mo/day/year) 5/10/2013 under the business name of Coranco Great Plains Inc. by (signature) [Signature]

INSTRUCTIONS: Use typewriter or ballpoint pen. Please press firmly and print clearly. Please fill in blanks, underline or circle the correct answers. Send top three copies to Kansas Department of Health and Environment, Bureau of Water, Geology Section, 1000 SW Jackson St., Ste. 420, Topeka, Kansas 66612-1367. Telephone: 785/296-5524. Send one to Water Well Owner and retain one for your records. Visit us at <http://www.kdheks.gov/waterwell/index.html>.

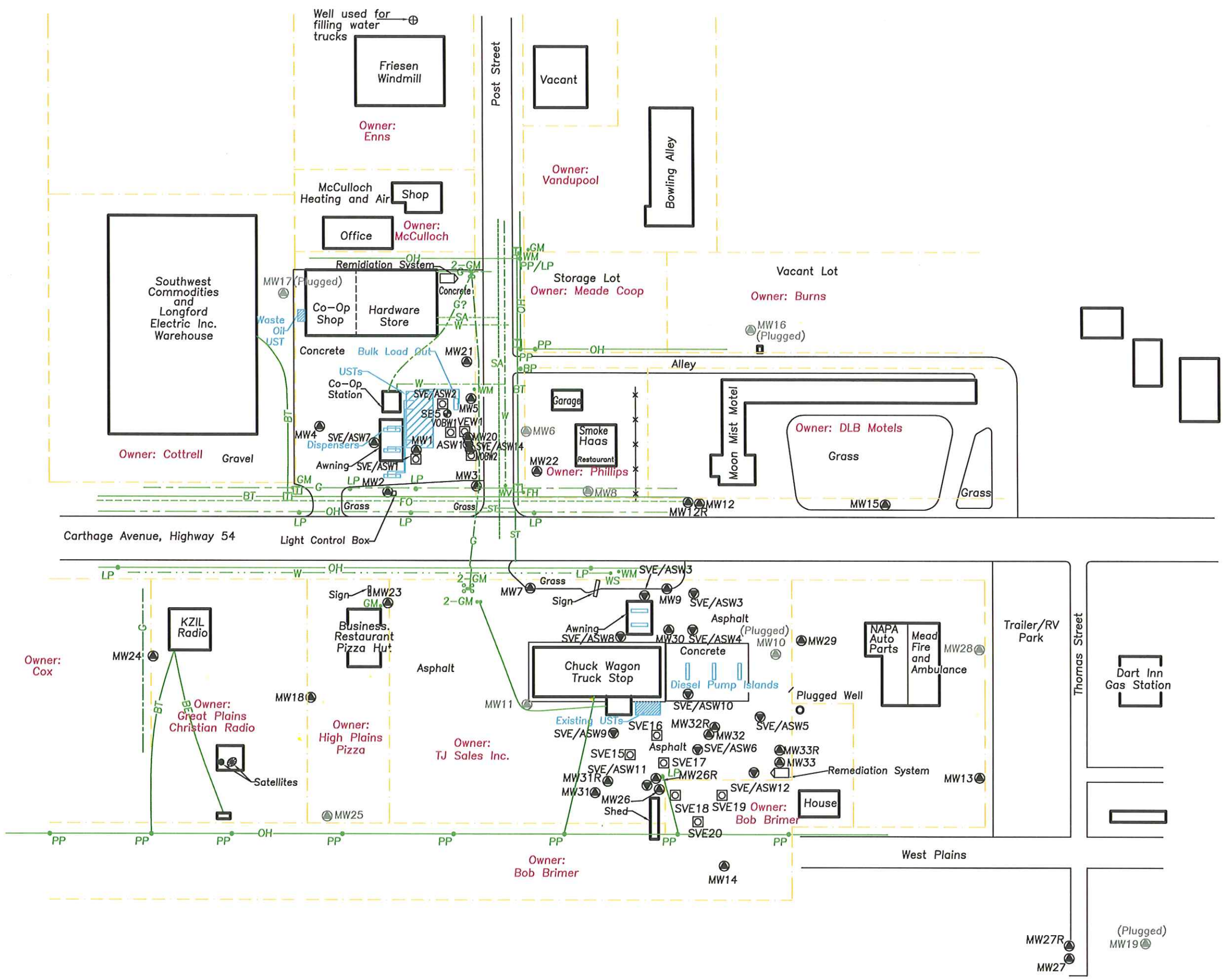

Legend

- MW5 - Monitoring Well Location
- ⊕ SB3 - Soil Boring Location
- ⊙ ASW1 - Air Sparge Well Location
- VOBW1 - Vapor Observation Well
- ⊠ SVE1 - Soil Vapor Extraction Well
- ⊙ MW11 - Destroyed/Abandoned Well
- Property Line
- OH- Overhead Electric
- FO- Fiber Optic (~ 24" deep)
- BT- Buried Telephone (~ 24" deep)
- W- Water Line (~ 48" deep)
- SA- Sanitary Sewer (~ 60" deep)
- ST- Storm Sewer (~ 12" deep)
- G- Natural Gas (~ 30" deep)
- BE- Buried Electric
- PP - Power Pole
- LP - Light Pole
- BP - Brace Pole
- GM - Gas Meter
- WM - Water Meter
- WV - Water Valve
- WS - Water Spigot
- FH - Fire Hydrant
- - Steel Bollard
- ⊠ - Telephone Pedestal

Scale In Feet
0 120 240

Site Base Map
Meade Coop
Meade, KS
Quarterly Monitoring Report
GCP Project #97013
Prepared By: RH Date: 06-11-12
Reviewed By: LD Date: 06-11-12
Figure 1
Coranco Great Plains, Inc. PO Box 23, Wahoo, NE 68066