

WATER WELL PLUGGING RECORD Form WWC-5P

KSA 82a-1212 ID NO.

1 LOCATION OF WATER WELL: County: <u>Meade</u> Street/Rural Address of Well Location; if unknown, distance & direction from nearest town or intersection: If at owner's address, check here <input type="checkbox"/> <u>923 W Carthage Ave. Meade, KS 67864</u>	Fraction SW 1/4 NW 1/4 NE 1/4 NE 1/4	Section Number <u>10</u>	Township Number T <u>32</u> S	Range Number <u>28</u> <input type="checkbox"/> E <input checked="" type="checkbox"/> W
---	---	-----------------------------	----------------------------------	--

Global Positioning Systems (GPS) information:
 Latitude: 37.28494133 (in decimal degrees)
 Longitude: 100.3487485 (in decimal degrees)
 Elevation: _____
 Datum: ☐ WGS84, ☒ NAD83, ☐ NAD27
 Collection Method:
☐ GPS unit (Make/Model: _____)
☐ Digital Map/Photo, ☐ Topographic Map, ☐ Land Survey
 Est. Accuracy: ☐ < 3 m, ☐ 3-5 m, ☐ 5-15 m, ☐ > 15 m

2 WATER WELL OWNER: Meade Coop Elevator RR#, St. Address, Box #: <u>PO Box 220</u> City, State ZIP Code: <u>Meade, KS 67864</u>	3 MARK WELL'S LOCATION WITH AN "X" IN SECTION BOX: <div style="text-align: center;"> </div>
--	---

4 DEPTH OF WELL 54.20/62.00 ft.
 WELL'S STATIC WATER LEVEL Dry/Dry ft.
 WELL WAS USED AS:

<input type="checkbox"/> Domestic	<input type="checkbox"/> Public Water Supply	<input type="checkbox"/> Dewatering
<input type="checkbox"/> Irrigation	<input type="checkbox"/> Oil Field Water Supply	<input type="checkbox"/> Monitoring
<input type="checkbox"/> Feedlot	<input type="checkbox"/> Domestic (Lawn & Garden)	<input type="checkbox"/> Injection Well
<input type="checkbox"/> Industrial	<input type="checkbox"/> Air Conditioning	<input checked="" type="checkbox"/> Other <u>SVE</u>

 Was a chemical/bacteriological sample submitted to Department? Yes ☐ No ☒

5 TYPE OF BLANK CASING USED:

<input type="checkbox"/> Steel	<input type="checkbox"/> RMP (SR)	<input type="checkbox"/> Wrought	<input type="checkbox"/> Fiberglass	<input type="checkbox"/> Other (Specify below) _____
<input checked="" type="checkbox"/> PVC	<input type="checkbox"/> ABS	<input type="checkbox"/> Asbestos-Cement	<input type="checkbox"/> Concrete Tile	

 Blank casing diameter 4/2 in. Was casing pulled? Yes ☐ No ☒ If yes, how much _____
 Casing height above or below land surface 36 in.

6 GROUT PLUG MATERIAL: ☐ Neat cement ☐ Cement grout ☒ Bentonite ☐ Other _____
 Grout Plug Intervals: From 3 ft. to 54.20 ft., From 3 ft. to 62.00 ft., From _____ to _____ ft.
 What is the nearest source of possible contamination:

<input type="checkbox"/> Septic tank	<input type="checkbox"/> Seepage pit	<input type="checkbox"/> Fuel Storage	<input checked="" type="checkbox"/> Other (specify below) _____
<input type="checkbox"/> Sewer lines	<input type="checkbox"/> Pit privy	<input type="checkbox"/> Fertilizer storage	Lust Site
<input type="checkbox"/> Watertight sewer lines	<input type="checkbox"/> Sewage lagoon	<input type="checkbox"/> Insecticide storage	
<input type="checkbox"/> Lateral lines	<input type="checkbox"/> Feedyard	<input type="checkbox"/> Abandoned water well	Direction from well? _____
<input type="checkbox"/> Cess pool	<input type="checkbox"/> Livestock pens	<input type="checkbox"/> Oil well/Gas well	How many feet? _____

FROM	TO	PLUGGING MATERIALS	FROM	TO	PLUGGING MATERIALS
0	3	Native Surface	0	3	Native Surface
3	54.20	Bentonite Grout	3	62.00	Bentonite Grout
					SVE/AS5

7 CONTRACTOR'S OR LANDOWNER'S CERTIFICATION: This water well was plugged under my jurisdiction and was completed on (mo/day/year) 4/26/2013 and this record is true to the best of my knowledge and belief. Kansas Water Well Contractor's License No. 594. This Water Well Record was completed on (mo/day/year) 5/10/2013 under the business name of Coranco Great Plains Inc. by (signature) [Signature]

INSTRUCTIONS: Use typewriter or ballpoint pen. Please press firmly and print clearly. Please fill in blanks, underline or circle the correct answers. Send top three copies to Kansas Department of Health and Environment, Bureau of Water, Geology Section, 1000 SW Jackson St., Ste. 420, Topeka, Kansas 66612-1367. Telephone: 785/296-5524. Send one to Water Well Owner and retain one for your records. Visit us at <http://www.kdheks.gov/waterwell/index.html>.

Check one: ☐ White Copy ☐ Blue Copy ☐ Pink Copy

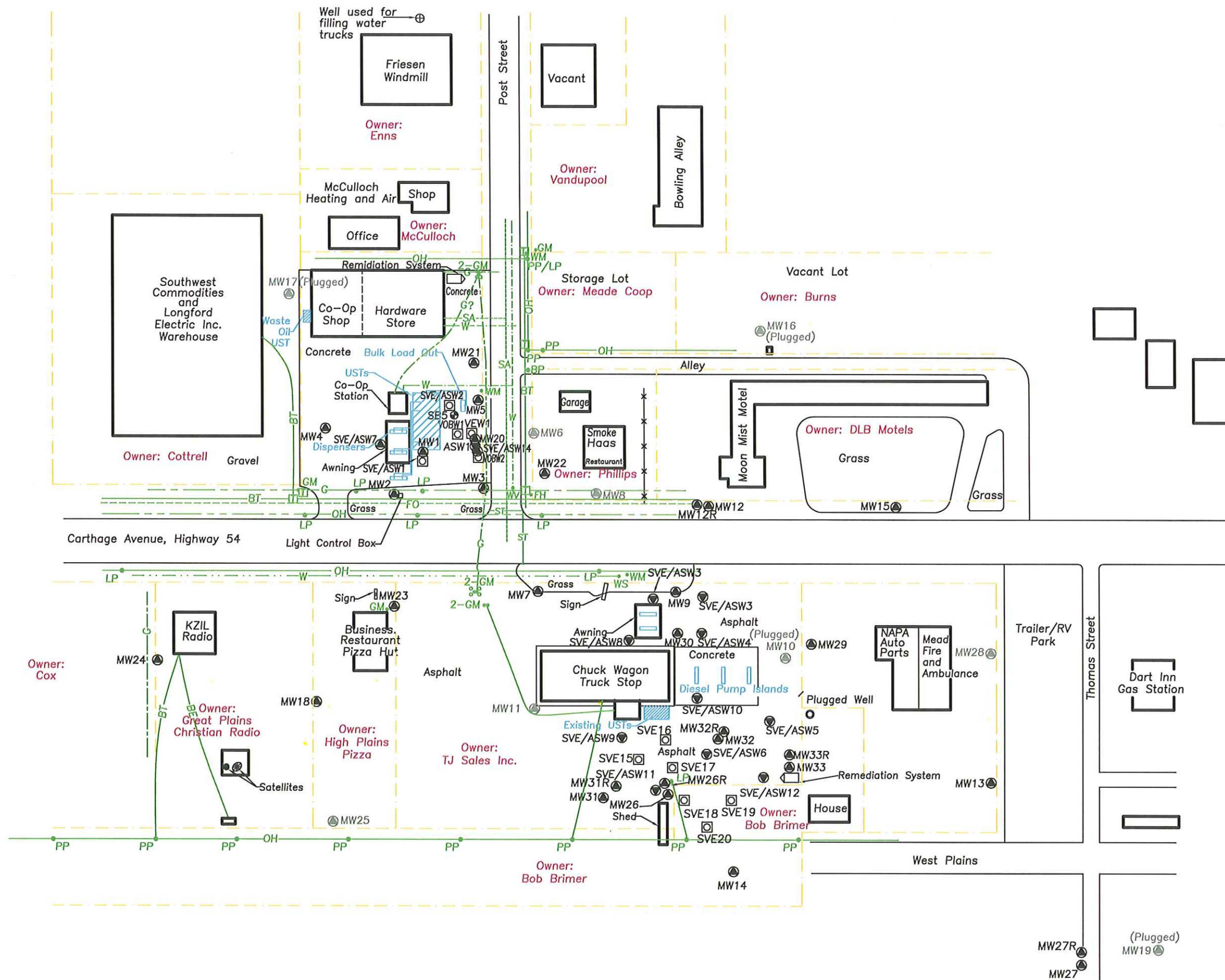

Legend

- MW5 - Monitoring Well Location
- SB3 - Soil Boring Location
- ASW1 - Air Sparge Well Location
- VOBW1 - Vapor Observation Well
- SVE1 - Soil Vapor Extraction Well
- MW11 - Destroyed/Abandoned Well
- Property Line
- OH- - Overhead Electric
- FO- - Fiber Optic (~ 24" deep)
- BT- - Buried Telephone (~ 24" deep)
- W- - Water Line (~ 48" deep)
- SA- - Sanitary Sewer (~ 60" deep)
- ST- - Storm Sewer (~ 12" deep)
- G- - Natural Gas (~ 30" deep)
- BE- - Buried Electric
- PP - Power Pole
- LP - Light Pole
- BP - Brace Pole
- GM - Gas Meter
- WM - Water Meter
- WV - Water Valve
- WS - Water Spigot
- FH - Fire Hydrant
- - Steel Bollard
- - Telephone Pedestal

Scale In Feet
0 120 240

Site Base Map
Meade Coop
Meade, KS
Quarterly Monitoring Report
GCP Project #97013
Prepared By: RH Date: 06-11-12
Reviewed By: LD Date: 06-11-12
Figure 1
Coranco Great Plains, Inc. PO Box 23, Wahoo, NE 68066