

WATER WELL PLUGGING RECORD Form WWC-5P

KSA 82a-1212 ID NO.

0047830

| | | | | |
|--|---------------------------------|-----------------------------|----------------------------------|--|
| 1 LOCATION OF WATER WELL: County: Meade Street/Rural Address of Well Location; if unknown, distance & direction from nearest town or intersection: If at owner's address, check here <input type="checkbox"/> <u>923 W Carthage Ave. Meade, KS 67864</u> | Fraction SW ¼ NW ¼ NE ¼ NE ¼ | Section Number 10 | Township Number T 32 S | Range Number 28 <input type="checkbox"/> E <input checked="" type="checkbox"/> W |
|--|---------------------------------|-----------------------------|----------------------------------|--|

2 WATER WELL OWNER: Meade Coop Elevator
 RR#, St. Address, Box #: **PO Box 220**
 City, State ZIP Code: **Meade, KS 67864**

Global Positioning Systems (GPS) information:
 Latitude: **37.28487** (in decimal degrees)
 Longitude: **100.34923** (in decimal degrees)
 Elevation: 2509.96
 Datum: ☐ WGS84, ☒ NAD83, ☐ NAD27
 Collection Method:
☐ GPS unit (Make/Model: _____)
☐ Digital Map/Photo, ☐ Topographic Map, ☐ Land Survey
 Est. Accuracy: ☐ < 3 m, ☐ 3-5 m, ☐ 5-15 m, ☐ > 15 m

| | |
|---|--|
| 3 MARK WELL'S LOCATION WITH AN "X" IN SECTION BOX: <div style="text-align: center;"> </div> | 4 DEPTH OF WELL <u>57.65</u> ft. WELL'S STATIC WATER LEVEL <u>54.81</u> ft WELL WAS USED AS: <div style="display: flex; justify-content: space-between;"> <div style="width: 30%;"> <input type="checkbox"/> Domestic <input type="checkbox"/> Irrigation <input type="checkbox"/> Feedlot <input type="checkbox"/> Industrial </div> <div style="width: 30%;"> <input type="checkbox"/> Public Water Supply <input type="checkbox"/> Oil Field Water Supply <input type="checkbox"/> Domestic (Lawn & Garden) <input type="checkbox"/> Air Conditioning </div> <div style="width: 30%;"> <input type="checkbox"/> Dewatering <input type="checkbox"/> Monitoring <input type="checkbox"/> Injection Well <input checked="" type="checkbox"/> Other SVE </div> </div> Was a chemical/bacteriological sample submitted to Department? Yes <input type="checkbox"/> No <input checked="" type="checkbox"/> |
|---|--|

5 TYPE OF BLANK CASING USED:

☐ Steel
☒ PVC

☐ RMP (SR)
☐ ABS

☐ Wrought
☐ Asbestos-Cement

☐ Fiberglass
☐ Concrete Tile

☐ Other (Specify below) _____

 Blank casing diameter 4 in. Was casing pulled? Yes ☐ No ☒ If yes, how much _____
 Casing height above or below land surface 36 in.

6 GROUT PLUG MATERIAL: ☐ Neat cement ☐ Cement grout ☒ Bentonite ☐ Other _____
 Grout Plug Intervals: From 3 ft. to 57.65 ft., From _____ ft. to _____ ft., From _____ to _____ ft.
 What is the nearest source of possible contamination:

☐ Septic tank
☐ Sewer lines
☐ Watertight sewer lines
☐ Lateral lines
☐ Cess pool

☐ Seepage pit
☐ Pit privy
☐ Sewage lagoon
☐ Feedyard
☐ Livestock pens

☐ Fuel Storage
☐ Fertilizer storage
☐ Insecticide storage
☐ Abandoned water well
☐ Oil well/Gas well

☒ Other (specify below) Lust Site
 Direction from well? _____
 How many feet? _____

| FROM | TO | PLUGGING MATERIALS | FROM | TO | PLUGGING MATERIALS |
|------|-------|--------------------|------|----|--------------------|
| 0 | 3 | Native Surface | | | |
| 3 | 57.65 | Bentonite Grout | | | SVE 16 |
| | | | | | |
| | | | | | |
| | | | | | |
| | | | | | |
| | | | | | |

7 CONTRACTOR'S OR LANDOWNER'S CERTIFICATION: This water well was plugged under my jurisdiction and was completed on (mo/day/year) 4/26/2013 and this record is true to the best of my knowledge and belief. Kansas Water Well Contractor's License No. 594. This Water Well Record was completed on (mo/day/year) 5/10/2013 under the business name of Coranco Great Plains Inc. by (signature) [Signature]

INSTRUCTIONS: Use typewriter or ballpoint pen. Please press firmly and print clearly. Please fill in blanks, underline or circle the correct answers. Send top three copies to Kansas Department of Health and Environment, Bureau of Water, Geology Section, 1000 SW Jackson St., Ste. 420, Topeka, Kansas 66612-1367. Telephone: 785/296-5524. Send one to Water Well Owner and retain one for your records. Visit us at <http://www.kdheks.gov/waterwell/index.html>.

Check one: ☐ White Copy ☐ Blue Copy ☐ Pink Copy

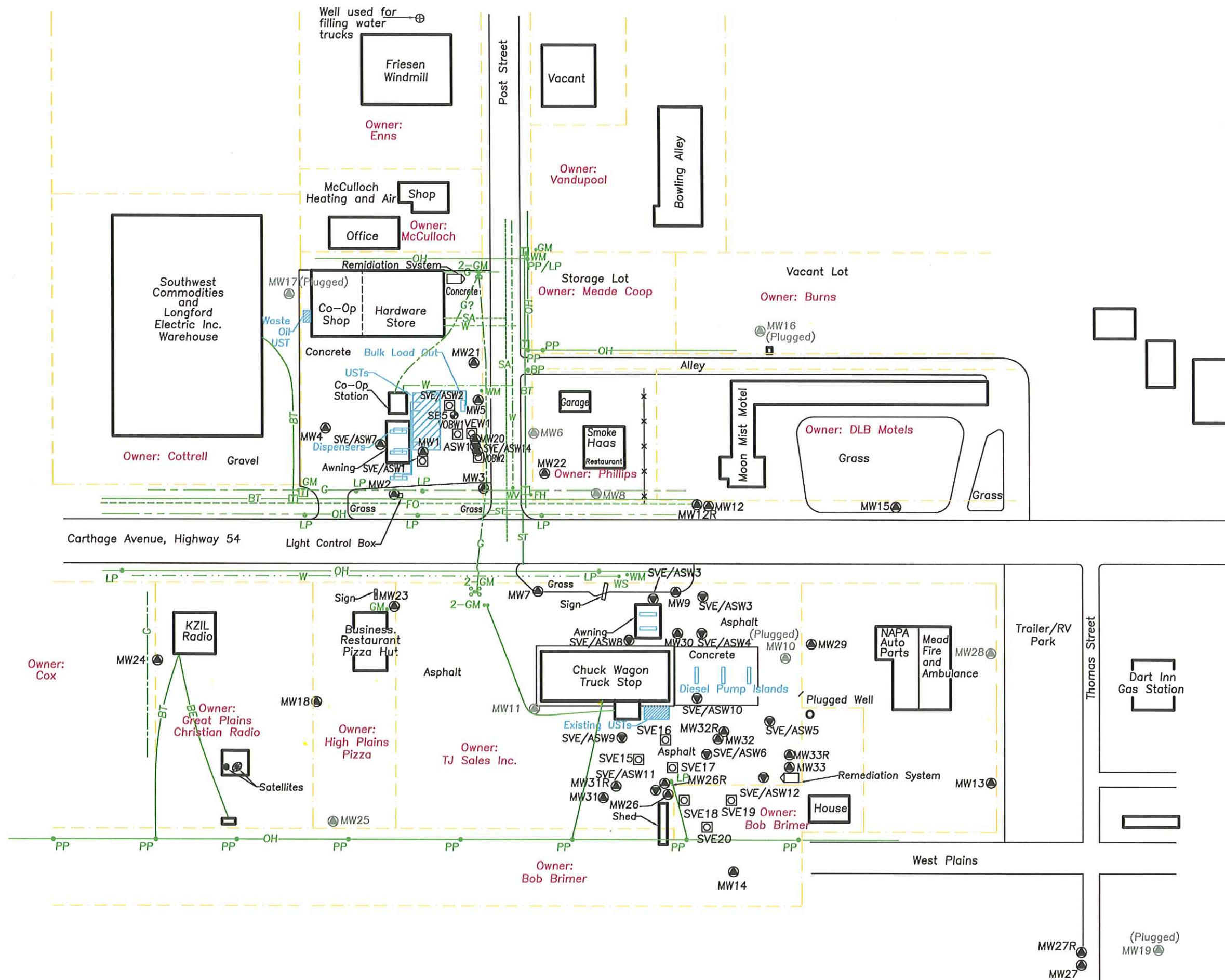

Legend

- MW5 - Monitoring Well Location
- SB3 - Soil Boring Location
- ASW1 - Air Sparge Well Location
- VOBW1 - Vapor Observation Well
- SVE1 - Soil Vapor Extraction Well
- MW11 - Destroyed/Abandoned Well
- Property Line
- OH --- Overhead Electric
- FO --- Fiber Optic (~ 24" deep)
- BT --- Buried Telephone (~ 24" deep)
- W --- Water Line (~ 48" deep)
- SA --- Sanitary Sewer (~ 60" deep)
- ST --- Storm Sewer (~ 12" deep)
- G --- Natural Gas (~ 30" deep)
- BE --- Buried Electric
- PP - Power Pole
- LP - Light Pole
- BP - Brace Pole
- GM - Gas Meter
- WM - Water Meter
- WV - Water Valve
- WS - Water Spigot
- FH - Fire Hydrant
- - Steel Bollard
- - Telephone Pedestal

Scale In Feet
0 120 240

Site Base Map
Meade Coop
Meade, KS
Quarterly Monitoring Report
GCP Project #97013
Prepared By: RH Date: 06-11-12
Reviewed By: LD Date: 06-11-12
Figure 1
Coranco Great Plains, Inc. PO Box 23, Wahoo, NE 68066