

WATER WELL PLUGGING RECORD Form WWC-5P

KSA 82a-1212

ID NO.

0047840

1 LOCATION OF WATER WELL: County: Meade Street/Rural Address of Well Location; if unknown, distance & direction from nearest town or intersection: If at owner's address, check here <input type="checkbox"/> <u>923 W Carthage Ave. Meade, KS 67864</u>	Fraction SW ¼ NW ¼ NE ¼ NE ¼ Section Number 10 Township Number T 32 S Range Number 28 <input type="checkbox"/> E <input checked="" type="checkbox"/> W	Global Positioning Systems (GPS) information: Latitude: 37.28456 (in decimal degrees) Longitude: 100.34902 (in decimal degrees) Elevation: 2507.00 Datum: <input type="checkbox"/> WGS84, <input checked="" type="checkbox"/> NAD83, <input type="checkbox"/> NAD27 Collection Method: <input type="checkbox"/> GPS unit (Make/Model: _____) <input type="checkbox"/> Digital Map/Photo, <input type="checkbox"/> Topographic Map, <input type="checkbox"/> Land Survey Est. Accuracy: <input type="checkbox"/> < 3 m, <input type="checkbox"/> 3-5 m, <input type="checkbox"/> 5-15 m, <input type="checkbox"/> > 15 m																																																
2 WATER WELL OWNER: Meade Coop Elevator RR#, St. Address, Box #: PO Box 220 City, State ZIP Code: Meade, KS 67864																																																		
3 MARK WELL'S LOCATION WITH AN "X" IN SECTION BOX: <div style="text-align: center;"> </div>	4 DEPTH OF WELL <u>61</u> ft. WELL'S STATIC WATER LEVEL <u>52.50</u> ft WELL WAS USED AS: <div style="display: flex; justify-content: space-between;"> <div> <input type="checkbox"/> Domestic <input type="checkbox"/> Irrigation <input type="checkbox"/> Feedlot <input type="checkbox"/> Industrial </div> <div> <input type="checkbox"/> Public Water Supply <input type="checkbox"/> Oil Field Water Supply <input type="checkbox"/> Domestic (Lawn & Garden) <input type="checkbox"/> Air Conditioning </div> <div> <input type="checkbox"/> Dewatering <input type="checkbox"/> Monitoring <input checked="" type="checkbox"/> Injection Well <input checked="" type="checkbox"/> Other SVE </div> </div> Was a chemical/bacteriological sample submitted to Department? Yes <input type="checkbox"/> No <input checked="" type="checkbox"/>																																																	
5 TYPE OF BLANK CASING USED: <div style="display: flex; justify-content: space-between;"> <div> <input type="checkbox"/> Steel <input checked="" type="checkbox"/> PVC </div> <div> <input type="checkbox"/> RMP (SR) <input type="checkbox"/> ABS </div> <div> <input type="checkbox"/> Wrought <input type="checkbox"/> Asbestos-Cement </div> <div> <input type="checkbox"/> Fiberglass <input type="checkbox"/> Concrete Tile </div> <div> <input type="checkbox"/> Other (Specify below) _____ </div> </div> Blank casing diameter <u>4</u> in. Was casing pulled? Yes <input type="checkbox"/> No <input checked="" type="checkbox"/> If yes, how much _____ Casing height above or below land surface <u>36</u> in.																																																		
6 GROUT PLUG MATERIAL: <input type="checkbox"/> Neat cement <input type="checkbox"/> Cement grout <input checked="" type="checkbox"/> Bentonite <input type="checkbox"/> Other _____ Grout Plug Intervals: From <u>3</u> ft. to <u>61</u> ft., From _____ ft. to _____ ft., From _____ to _____ ft. What is the nearest source of possible contamination: <div style="display: flex; justify-content: space-between;"> <div> <input type="checkbox"/> Septic tank <input type="checkbox"/> Sewer lines <input type="checkbox"/> Watertight sewer lines <input type="checkbox"/> Lateral lines <input type="checkbox"/> Cess pool </div> <div> <input type="checkbox"/> Seepage pit <input type="checkbox"/> Pit privy <input type="checkbox"/> Sewage lagoon <input type="checkbox"/> Feedyard <input type="checkbox"/> Livestock pens </div> <div> <input type="checkbox"/> Fuel Storage <input type="checkbox"/> Fertilizer storage <input type="checkbox"/> Insecticide storage <input type="checkbox"/> Abandoned water well <input type="checkbox"/> Oil well/Gas well </div> <div> <input checked="" type="checkbox"/> Other (specify below) _____ Lust Site Direction from well? _____ How many feet? _____ </div> </div> <table border="1" style="width:100%; border-collapse: collapse; margin-top: 10px;"> <thead> <tr> <th>FROM</th> <th>TO</th> <th>PLUGGING MATERIALS</th> <th>FROM</th> <th>TO</th> <th>PLUGGING MATERIALS</th> </tr> </thead> <tbody> <tr> <td>0</td> <td>3</td> <td>Native Surface</td> <td></td> <td></td> <td></td> </tr> <tr> <td>3</td> <td>61</td> <td>Bentonite Grout</td> <td></td> <td></td> <td>SVE 20</td> </tr> <tr><td> </td><td> </td><td> </td><td> </td><td> </td><td> </td></tr> <tr><td> </td><td> </td><td> </td><td> </td><td> </td><td> </td></tr> <tr><td> </td><td> </td><td> </td><td> </td><td> </td><td> </td></tr> <tr><td> </td><td> </td><td> </td><td> </td><td> </td><td> </td></tr> <tr><td> </td><td> </td><td> </td><td> </td><td> </td><td> </td></tr> </tbody> </table>			FROM	TO	PLUGGING MATERIALS	FROM	TO	PLUGGING MATERIALS	0	3	Native Surface				3	61	Bentonite Grout			SVE 20																														
FROM	TO	PLUGGING MATERIALS	FROM	TO	PLUGGING MATERIALS																																													
0	3	Native Surface																																																
3	61	Bentonite Grout			SVE 20																																													
7 CONTRACTOR'S OR LANDOWNER'S CERTIFICATION: This water well was plugged under my jurisdiction and was completed on (mo/day/year) <u>4/26/2013</u> and this record is true to the best of my knowledge and belief. Kansas Water Well Contractor's License No. <u>594</u> . This Water Well Record was completed on (mo/day/year) <u>5/10/2013</u> under the business name of <u>Coranco Great Plains Inc.</u> by (signature) <u>[Signature]</u>																																																		
INSTRUCTIONS: Use typewriter or ballpoint pen. Please press firmly and print clearly. Please fill in blanks, underline or circle the correct answers. Send top three copies to Kansas Department of Health and Environment, Bureau of Water, Geology Section, 1000 SW Jackson St., Ste. 420, Topeka, Kansas 66612-1367. Telephone: 785/296-5524. Send one to Water Well Owner and retain one for your records. Visit us at http://www.kdheks.gov/waterwell/index.html .																																																		

Check one: ☐ White Copy ☐ Blue Copy ☐ Pink Copy

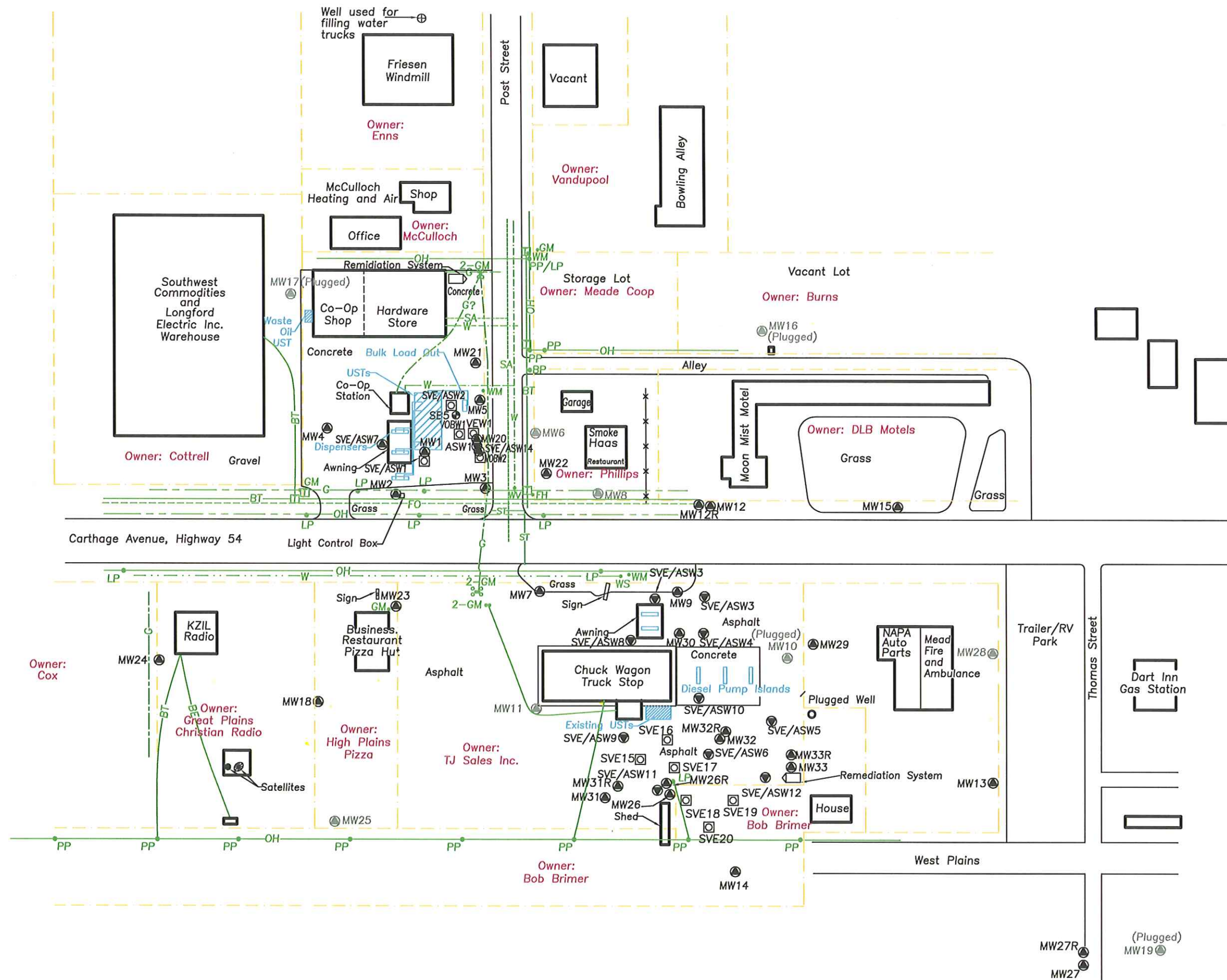

Legend

- MW5 - Monitoring Well Location
- SB3 - Soil Boring Location
- ASW1 - Air Sparge Well Location
- VOBW1 - Vapor Observation Well
- SVE1 - Soil Vapor Extraction Well
- MW11 - Destroyed/Abandoned Well
- Property Line
- OH- Overhead Electric
- FO- Fiber Optic (~ 24"deep)
- BT- Buried Telephone (~ 24"deep)
- W- Water Line (~ 48"deep)
- SA- Sanitary Sewer (~ 60"deep)
- ST- Storm Sewer (~ 12"deep)
- G- Natural Gas (~ 30"deep)
- BE- Buried Electric
- PP - Power Pole
- LP - Light Pole
- BP - Brace Pole
- GM - Gas Meter
- WM - Water Meter
- WV - Water Valve
- WS - Water Spigot
- FH - Fire Hydrant
- - Steel Bollard
- - Telephone Pedestal

Scale In Feet
0 120 240

Site Base Map
Meade Coop
Meade, KS
Quarterly Monitoring Report
GCP Project #97013
Prepared By: RH Date: 06-11-12
Reviewed By: LD Date: 06-11-12
Figure 1
Coranco Great Plains, Inc. PO Box 23, Wahoo, NE 68066