

WATER WELL PLUGGING RECORD Form WWC-5P

KSA 82a-1212

ID NO.

MW-6

1 LOCATION OF WATER WELL: HARPER COUNTY	Fraction NE ¼ NW ¼ NE	Section Number 12	Township Number T 32 S	Range Number R 7 W
---	--------------------------	----------------------	---------------------------	-----------------------

Distance and direction from nearest town or city street address of well if located within city?
103 W. 14TH ST. HARPER KS

2 WATER WELL OWNER: KDHE RR#, St. Address, Box #: 1000 SW JACKSON City, State ZIP Code: TOPEKA, KS 66612	Global Positioning Systems (decimal degrees, min. of 4 digits) Latitude: <u> </u> N 37.28307 <u> </u> Longitude: <u> </u> W 98.02622 <u> </u> Elevation: <u> </u> 1417.85 <u> </u> Datum: <u> </u> Data Collection Method: <u> </u>
---	---

3 MARK WELL'S LOCATION WITH AN "X" IN SECTION BOX:

4 DEPTH OF WELL 17.55 ft.

WELL'S STATIC WATER LEVEL 17.26 ft

WELL WAS USED AS: X

1 Domestic	5 Public Water Supply	9 Dewatering
2 Irrigation	6 Oil Field Water Supply	<u>10 Monitoring</u>
3 Feedlot	7 Domestic (Lawn & Garden)	11 Injection Well
4 Industrial	8 Air Conditioning	12 Other <u> </u>

Was a chemical/bacteriological sample submitted to Department? Yes No x

5 TYPE OF BLANK CASING USED:

1 Steel	3 RMP (SR)	5 Wrought	7 Fiberglass	9 Other (Specify below)
<u>2 PVC</u>	4 ABS	6 Asbestos-Cement	8 Concrete Tile	<u> </u>

Blank casing diameter 2 in. Was casing pulled? Yes x No If yes, how much 3'
Casing height above or below land surface 36 in.

6 GROUT PLUG MATERIAL: 1 Neat cement 2 Cement grout 3 Bentonite 4 Other Soil

Grout Plug Intervals: From 0 ft. to 3 ft., From 3 ft. to 17.55 ft., From to ft.

What is the nearest source of possible contamination:

1 Septic tank	6 Seepage pit	11 Fuel Storage	16 Other (specify below)
2 Sewer lines	7 Pit privy	12 Fertilizer storage	<u> Contaminated Site </u>
3 Watertight sewer lines	8 Sewage lagoon	13 Insecticide storage	
4 Lateral lines	9 Feedyard	14 Abandoned water well	Direction from well? <u> </u>
5 Cess pool	10 Livestock pens	15 Oil well/Gas well	How many feet? <u> </u>

FROM	TO	PLUGGING MATERIALS	FROM	TO	PLUGGING MATERIALS
0'	3'	CONCRETE			
3'	17.55'	BENTONITE			

7 CONTRACTOR'S OR LANDOWNER'S CERTIFICATION: This water well was plugged under my jurisdiction and was completed on (mo/day/year) 10-25-16 and this record is true to the best of my knowledge and belief. Kansas Water Well Contractor's License No. 585 . This Water Well Record was completed on (mo/day/year) 11-27-16 under the business name of Associated Environmental, Inc. by (signature) [Signature]

INSTRUCTIONS: Use typewriter or ballpoint pen. Please press firmly and print clearly. Please fill in blanks, underline or circle the correct answers. Send top three copies to Kansas Department of Health and Environment, Bureau of Water, Geology Section, 1000 SW Jackson St., Ste. 420, Topeka, Kansas 66612-1367. Telephone: 785/296-5522. Send one to Water Well Owner and retain one for your records. Visit us at <http://www.kdheks.gov/waterwell/index.html>.

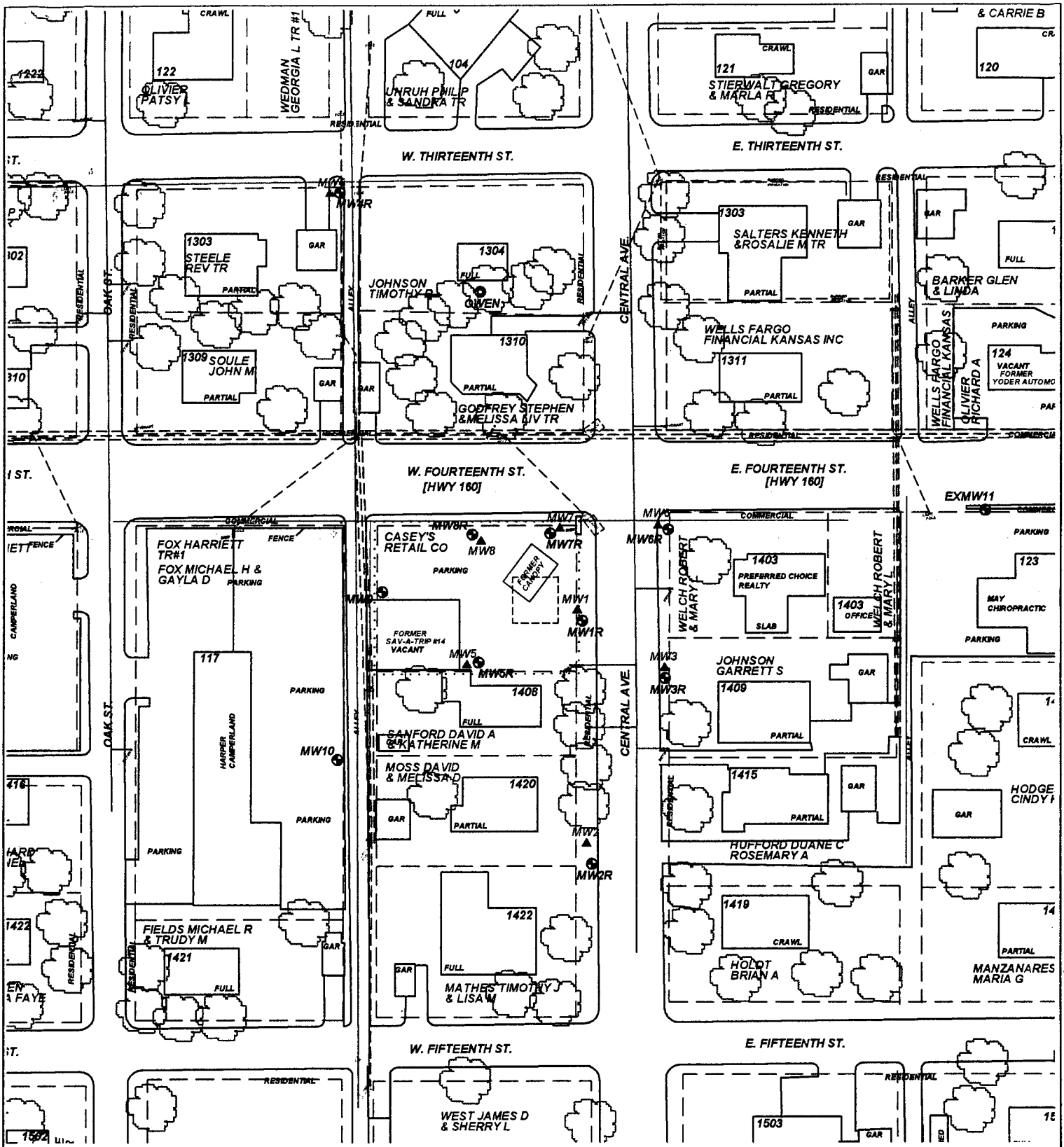

PROJECT: **SAV-A-TRIP #14**

ADDRESS: **103 W. 14TH ST.**

LOCATION: **HARPER, KS**

DRAWN BY: **B. STALNAKER** DATE: **8/18/16**

REVISED BY: **C. ROE** DATE: **8/25/16**

AEI JOB #: **TM209** KDHE JOB #: **U2-039-13689**

SCALE: **1" = 100'**

NOTES:

TITLE: **FIGURE 2.1
SITE MAP
350' RADIUS**

**ASSOCIATED
ENVIRONMENTAL
INC.**

LEGEND:

- = FORMER UST BASIN/EXCAVATION & CANOPY/PUMP ISLAND LOCATIONS
- = MONITOR WELL
- = PRIVATE WELL
- = PLUGGED/DESTROYED WELL
- = SUBJECT PROPERTY
- = PARCEL BOUNDARY
- = OVERHEAD ELECTRIC (10-25)
- = BURIED ELECTRIC (2-5)
- = BURIED WATER (3-6)
- = BURIED GAS (2-4)
- = BURIED SEWER (2-12)
- = BURIED CABLE (2-5)