

WATER WELL RECORD Form WWC-5

Division of Water Resources App. No.

Well ID MW10

Original Record Correction Change in Well Use

1 LOCATION OF WATER WELL: County: Harper Fraction NE 1/4 NW 1/4 NE 1/4 Section Number 12 Township Number T 32 S Range Number R 7 E W

2 WELL OWNER: Last Name: KDHE BER Business: KDHE BER Address: 1000 SW Jackson STE 410 City: Topeka State: KS ZIP: 66612-1367 Street or Rural Address where well is located: 117 W. 14th St., Harper, KS East side of property near alley in parking area

3 LOCATE WELL WITH 'X' IN SECTION BOX: N W E S 1 mile

4 DEPTH OF COMPLETED WELL: 30 ft. Depth(s) Groundwater Encountered: 1) 23 ft. 2) 23.35 ft. WELL'S STATIC WATER LEVEL: 23.35 ft. below land surface, measured on (mo-day-yr) 10-25-16

5 Latitude: 37.28265 Longitude: 98.02666 Horizontal Datum: WGS 84 NAD 83 NAD 27 Source for Latitude/Longitude: GPS Land Survey Topographic Map Online Mapper Elevation: 1421.20 ft. Ground Level TOC Source: Land Survey GPS Topographic Map Other

7 WELL WATER TO BE USED AS: 1. Domestic: Household Lawn & Garden Livestock Irrigation Feedlot Industrial 5. Public Water Supply: well ID 6. Dewatering: how many wells? 7. Aquifer Recharge: well ID 8. Monitoring: well ID MW10 9. Environmental Remediation: well ID Air Sparge Soil Vapor Extraction Recovery Injection 10. Oil Field Water Supply: lease 11. Test Hole: well ID Cased Uncased Geotechnical 12. Geothermal: how many bores? a) Closed Loop Horizontal Vertical b) Open Loop Surface Discharge Inj. of Water 13. Other (specify):

Was a chemical/bacteriological sample submitted to KDHE? Yes No If yes, date sample was submitted: Water well disinfected? Yes No

8 TYPE OF CASING USED: Steel PVC Other CASING JOINTS: Glued Clamped Welded Threaded Casing diameter 2 in. to 20 ft., Diameter in. to ft., Diameter in. to ft. Casing height above land surface in. Weight lbs./ft. Wall thickness or gauge No. SCH 40

TYPE OF SCREEN OR PERFORATION MATERIAL: Steel Stainless Steel Fiberglass PVC Brass Galvanized Steel Concrete tile None used (open hole) SCREEN OR PERFORATION OPENINGS ARE: Continuous Slot Mill Slot Gauze Wrapped Torch Cut Drilled Holes Other (Specify) Louvered Shutter Key Punched Wire Wrapped Saw Cut None (Open Hole) SCREEN-PERFORATED INTERVALS: From 20 ft. to 30 ft., From ft. to ft., From ft. to ft. GRAVEL PACK INTERVALS: From ft. to ft., From ft. to ft., From ft. to ft.

9 GROUT MATERIAL: Neat cement Cement grout Bentonite Other Grout Intervals: From 0.85 ft. to 16 ft., From 16 ft. to 18 ft., From ft. to ft. Nearest source of possible contamination: Septic Tank Lateral Lines Pit Privy Livestock Pens Insecticide Storage Sewer Lines Cess Pool Sewage Lagoon Fuel Storage Abandoned Water Well Watertight Sewer Lines Seepage Pit Feedyard Fertilizer Storage Oil Well/Gas Well Other (Specify) Direction from well? Distance from well? ft.

Table with 6 columns: 10 FROM, TO, LITHOLOGIC LOG, FROM, TO, LITHO. LOG (cont.) or PLUGGING INTERVALS. Rows: 0-0.5 Concrete, 0.5-30 Silty Clay (CL), brown trace gravel. Includes a Notes section.

11 CONTRACTOR'S OR LANDOWNER'S CERTIFICATION: This water well was constructed, reconstructed, or plugged under my jurisdiction and was completed on (mo-day-yr) 10/10/16 and this record is true to the best of my knowledge and belief. Kansas Water Well Contractor's License No. 585 This Water Well Record was completed on (mo-day-yr) 11/10/16 under the business name of Associated Environmental, Inc. Signature

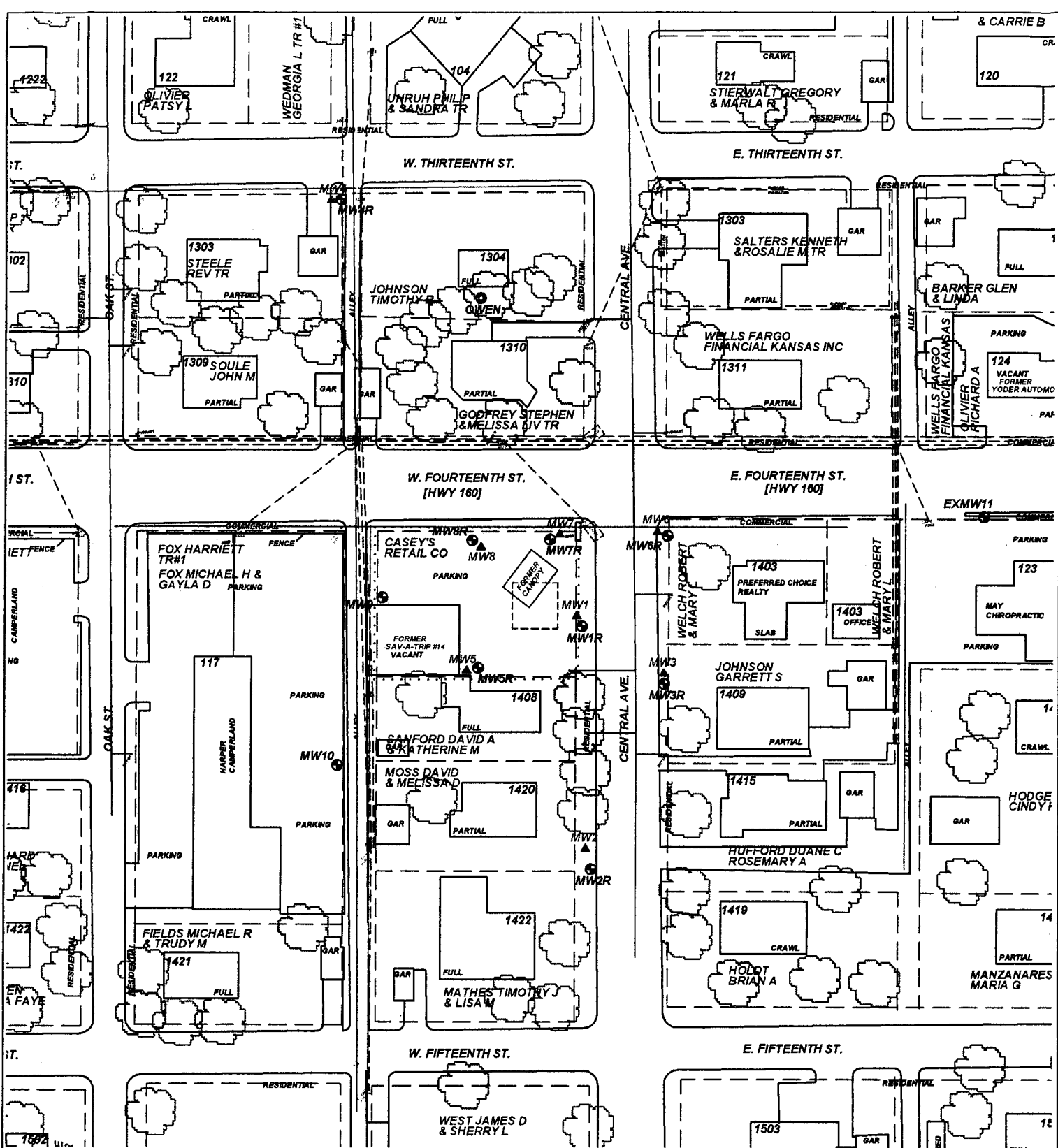

PROJECT: **SAV-A-TRIP #14**

ADDRESS: **103 W. 14TH ST.**

LOCATION: **HARPER, KS**

DRAWN BY: **B. STALNAKER** DATE: **8/18/16**

REVISED BY: **C. ROE** DATE: **8/25/16**

AEI JOB # **TM209** KDHE JOB # **U2-039-13689**

TITLE: **FIGURE 2.1  
SITE MAP  
350' RADIUS**

**ASSOCIATED  
ENVIRONMENTAL  
INC.**

LEGEND:

- = FORMER UST BASIN/EXCAVATION & CANOPY/PUMP ISLAND LOCATIONS
- = MONITOR WELL
- = PRIVATE WELL
- = PLUGGED/DESTROYED WELL
- ..... = SUBJECT PROPERTY
- = PARCEL BOUNDARY
- = OVERHEAD ELECTRIC (10-25)
- = BURIED ELECTRIC (2-5)
- = BURIED WATER (3-6)
- = BURIED GAS (2-4)
- = BURIED SEWER (2-12)
- = BURIED CABLE (2-5)

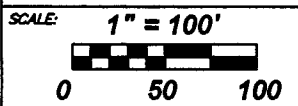

NOTES: