

# SMH CONSULTANTS

November 10, 2022

SCS Engineers  
Leah Meyer  
6161 S. Syracuse Way, Suite 210  
Greenwood Village, Colorado 80111

RE: Project No. 2211-0447

Leah,

The following is the information requested on a Monitoring Well Site, Wright-Price #1, Attica, Harper County, Kansas.

Point	North Coord.	East Coord.	Distance SE Cor. North	From S.30 West	Elev. Top Of Rim or PK Nail	Elev. Top of PVC Pipe	Latitude North	Longitude West
SE Corner S.30-T32S-R8W	40000	40000						
MW17	45016.27	38716.86	5016.27	1283.14	1453.59	1453.08	37.23868	98.22497
MW18	44941.80	38904.98	4941.80	1095.02	1453.94	1453.40	37.23847	98.22433
MW19	44855.90	38864.63	4855.90	1135.37	1451.54	1451.19	37.23824	98.22447
MW20	44594.38	38738.26	4594.38	1261.74	1451.56	1451.13	37.23752	98.22492
MW21	44581.88	38626.61	4581.88	1373.39	1451.27	1450.82	37.23749	98.22530
MW22	44611.54	38515.77	4611.54	1484.23	1450.33	1449.89	37.23758	98.22568
Site BM	45168.34	38537.43	5168.34	1462.57		SBM Elevation = 1454.17		

Description: "X" cut on north bolt on top of fire hydrant on East side of property.

MW17 is in the:	NW¼	NW¼	NE¼	NE¼	S.30-T32S-R8W
MW18 and MW19 are in the:	SW¼	NW¼	NE¼	NE¼	S.30-T32S-R8W
MW20 is in the:	NW¼	SW¼	NE¼	NE¼	S.30-T32S-R8W
MW21 and MW22 are in the:	NE¼	SE¼	NW¼	NE¼	S.30-T32S-R8W

If you have any questions, please do not hesitate in giving us a call.

Sincerely,



Tim Sloan, L.S.  
SMH CONSULTANTS

**COLORADO SPRINGS**  
411 South Tejon Street, Suite i  
Colorado Springs, CO 80903  
P: 719-465-2145

**DODGE CITY**  
707 3<sup>rd</sup> Avenue, Suite A  
Dodge City, KS 67801  
P: 620-255-1952

**MANHATTAN - HQ**  
2017 Vanesta Place, Suite 110  
Manhattan, KS 66503  
P: 785-776-0541

**KANSAS CITY**  
5201 Johnson Drive, Suite 405  
Mission, KS 66205  
P: 913-444-9615

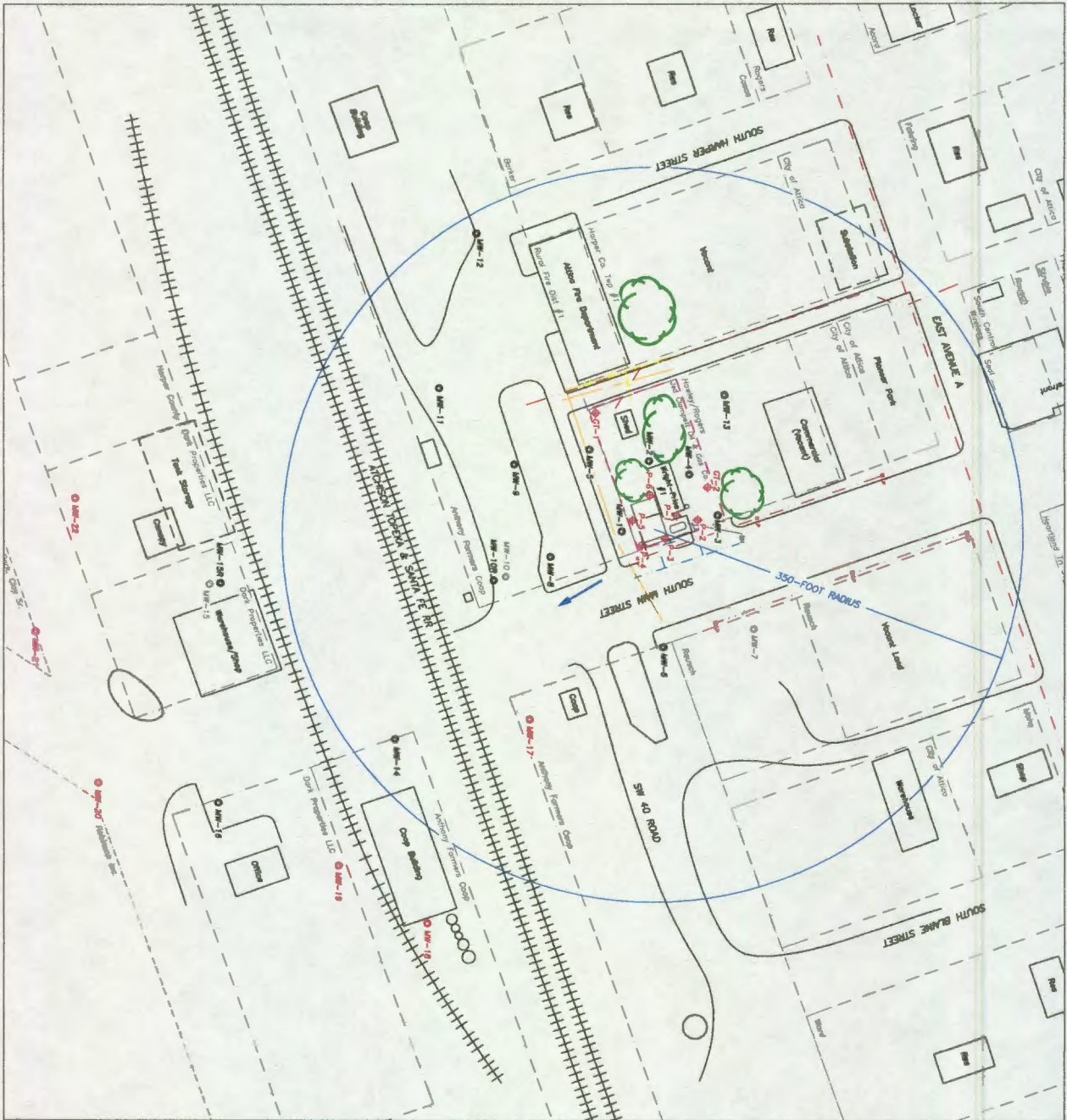

- LEGEND:**
- ◆ RORBA SOIL BORING
  - NEW MONITORING WELL
  - EXISTING MONITORING WELL
  - ABANDONED MONITORING WELL
  - PROPERTY SITE BOUNDARY
  - PROPERTY LINE/OWNER'S
  - OVERHEAD ELECTRIC/TELEPHONE LINE
  - GAS LINE (APPROX. 1.5-3')
  - SANITARY SEWER LINE (APPROX. 2-6')
  - STORM SEWER LINE (APPROX. 2 TO 8')
  - FIBER OPTICS LINE (APPROX. 1.5 TO 3')
  - WATER LINE (APPROX. 2-6')
  - GROUNDWATER FLOW DIRECTION
- NOTES:**
1. THE LOCATION OF THE UST BASIN, PRODUCT LINES & PUMP ISLANDS ARE APPROXIMATE, BASED ON SITE OBSERVATIONS AND PHOTO MAPS PROVIDED BY ABOVE.
  2. UTILITY LOCATIONS AND DEPTHS ARE APPROXIMATE, BASED ON FIELD SURVEY AND PHOTO MAPS PROVIDED BY ABOVE.

FIGURE 2.1 - AREA BASE MAP (350-FOOT RADIUS)

REV: 0	DATE: 2.1	PROJECT NUMBER: 27222103.00	CLIENT: WRIGHT-PRICE #1 (U2-039-13994) 125 SOUTH MAIN ATTICA, KANSAS	DATE: 11/2/2022	PROJECT NAME: SLM	REV: R5	DATE: 5BY	DESCRIPTION:
0	2.1	27222103.00	WRIGHT-PRICE #1	11/2/2022	SLM	R4	4BY	
						R3	3BY	
						R2	2BY	
						R1	1BY	
						RO	0BY	

**SCS ENGINEERS**  
 8575 West 110th Street, Suite 100  
 Overland Park, Kansas 66210



**WATER WELL RECORD Form WWC-5**

Division of Water Resources App. No.

Well ID **MW-19**

Original Record  Correction  Change in Well Use

<b>1 LOCATION OF WATER WELL:</b> County: <b>Harper</b>	Fraction <b>SW 1/4 NW 1/4 NE 1/4 NE 1/4</b>	Section Number <b>30</b>	Township Number <b>T 32 S</b>	Range Number <b>R 8 <input type="checkbox"/> E <input checked="" type="checkbox"/> W</b>
---	--	-----------------------------	----------------------------------	---

<b>2 WELL OWNER:</b> Last Name: <b>First:</b> Business: <b>KDHE</b> Address: <b>1000 SW Jackson St., Suite 420</b> Address: City: <b>Topeka</b> State: <b>KS</b> ZIP: <b>66612-1367</b>	Street or Rural Address where well is located (if unknown, distance and direction from nearest town or intersection): If at owner's address, check here: <input type="checkbox"/> <b>Approximately 150 ft. N. &amp; 150 ft. E. of intersection of S. Main Street &amp; Attica Road, Attica, Ks.</b>
---	--

<b>3 LOCATE WELL WITH "X" IN SECTION BOX:</b> <div style="text-align: center;"> </div>	<b>4 DEPTH OF COMPLETED WELL:</b> ..... <b>15</b> ..... ft. Depth(s) Groundwater Encountered: 1) ..... ft. 2) ..... ft. 3) ..... ft., or 4) <input checked="" type="checkbox"/> Dry Well WELL'S STATIC WATER LEVEL: ..... <b>11.35</b> ..... ft. <input checked="" type="checkbox"/> below land surface, measured on (mo-day-yr) <b>10-26-2022</b> <input type="checkbox"/> above land surface, measured on (mo-day-yr)..... Pump test data: Well water was ..... ft. after ..... hours pumping ..... gpm Well water was ..... ft. after ..... hours pumping ..... gpm Estimated Yield: ..... gpm Bore Hole Diameter: <b>8.75</b> in. to <b>15</b> ft. and ..... in. to ..... ft.	<b>5 Latitude:</b> ..... <b>37.23824</b> .....(decimal degrees) <b>Longitude:</b> ..... <b>98.22447</b> .....(decimal degrees) Horizontal Datum: <input checked="" type="checkbox"/> WGS 84 <input type="checkbox"/> NAD 83 <input type="checkbox"/> NAD 27 Source for Latitude/Longitude: <input type="checkbox"/> GPS (unit make/model: .....) (WAAS enabled? <input type="checkbox"/> Yes <input type="checkbox"/> No) <input checked="" type="checkbox"/> Land Survey <input type="checkbox"/> Topographic Map <input type="checkbox"/> Online Mapper: .....
<b>6 Elevation:</b> <b>1451.19</b> ft. <input type="checkbox"/> Ground Level <input type="checkbox"/> TOC Source: <input type="checkbox"/> Land Survey <input type="checkbox"/> GPS <input type="checkbox"/> Topographic Map <input type="checkbox"/> Other .....		

**7 WELL WATER TO BE USED AS:**

1. Domestic: <input type="checkbox"/> Household <input type="checkbox"/> Lawn & Garden <input type="checkbox"/> Livestock 2. <input type="checkbox"/> Irrigation 3. <input type="checkbox"/> Feedlot 4. <input type="checkbox"/> Industrial	5. <input type="checkbox"/> Public Water Supply: well ID ..... 6. <input type="checkbox"/> Dewatering: how many wells? ..... 7. <input type="checkbox"/> Aquifer Recharge: well ID ..... 8. <input checked="" type="checkbox"/> Monitoring: well ID <b>MW-19</b> 9. Environmental Remediation: well ID ..... <input type="checkbox"/> Air Sparge <input type="checkbox"/> Soil Vapor Extraction <input type="checkbox"/> Recovery <input type="checkbox"/> Injection	10. <input type="checkbox"/> Oil Field Water Supply: lease ..... 11. Test Hole: well ID ..... <input type="checkbox"/> Cased <input type="checkbox"/> Uncased <input type="checkbox"/> Geotechnical 12. Geothermal: how many bores? ..... a) Closed Loop <input type="checkbox"/> Horizontal <input type="checkbox"/> Vertical b) Open Loop <input type="checkbox"/> Surface Discharge <input type="checkbox"/> Inj. of Water 13. <input type="checkbox"/> Other (specify): .....
---	--	---

Was a chemical/bacteriological sample submitted to KDHE?  Yes  No If yes, date sample was submitted: .....

Water well disinfected?  Yes  No

**8 TYPE OF CASING USED:**  Steel  PVC  Other ..... CASING JOINTS:  Glued  Clamped  Welded  Threaded  
 Casing diameter .....**2**..... in. to .....**5**..... ft., Diameter ..... in. to ..... ft., Diameter ..... in. to ..... ft.  
 Casing height above land surface .....**0**..... in. Weight ..... lbs./ft. Wall thickness or gauge No. **sch 40**.....

TYPE OF SCREEN OR PERFORATION MATERIAL:  
 Steel  Stainless Steel  Fiberglass  PVC  Other (Specify) .....  
 Brass  Galvanized Steel  Concrete tile  None used (open hole)

SCREEN OR PERFORATION OPENINGS ARE:  
 Continuous Slot  Mill Slot  Gauze Wrapped  Torch Cut  Drilled Holes  Other (Specify) .....  
 Louvered Shutter  Key Punched  Wire Wrapped  Saw Cut  None (Open Hole)

SCREEN-PERFORATED INTERVALS: From .....**2**..... ft. to **15**..... ft., From ..... ft. to ..... ft., From ..... ft. to ..... ft.  
 GRAVEL PACK INTERVALS: From .....**3**..... ft. to **15**..... ft., From ..... ft. to ..... ft., From ..... ft. to ..... ft.

**9 GROUT MATERIAL:**  Neat cement  Cement grout  Bentonite  Other cement pad .....  
 Grout Intervals: From .....**1**..... ft. to **3**..... ft., From **0**..... ft. to **1**..... ft., From ..... ft. to ..... ft.

Nearest source of possible contamination:  
 Septic Tank  Lateral Lines  Pit Privy  Livestock Pens  Insecticide Storage  
 Sewer Lines  Cess Pool  Sewage Lagoon  Fuel Storage  Abandoned Water Well  
 Watertight Sewer Lines  Seepage Pit  Feedyard  Fertilizer Storage  Oil Well/Gas Well  
 Other (Specify) .....

Direction from well? **SE** Distance from well? **375** ft.

10 FROM	TO	LITHOLOGIC LOG	FROM	TO	LITHO. LOG (cont.) or PLUGGING INTERVALS
0	1	Gravel & Soil			
1	5	Sandy Clay, dark brown			
5	11.5	Sand, tan-brown, fine, damp			
11.5	13	Sand, tan-brown, fine, wet			
13	16	Sand, tan-brown, with gravel and brown cl			
Notes:					

**11 CONTRACTOR'S OR LANDOWNER'S CERTIFICATION:** This water well was  constructed,  reconstructed, or  plugged under my jurisdiction and was completed on (mo-day-year) **10-18-2022** and this record is true to the best of my knowledge and belief. Kansas Water Well Contractor's License No. **604** This Water Well Record was completed on (mo-day-year) **11/15/22** under the business name of **Environmental Priority Service, Inc.** Signature **P. M. [unclear]**