

# SMH CONSULTANTS

November 10, 2022

SCS Engineers  
Leah Meyer  
6161 S. Syracuse Way, Suite 210  
Greenwood Village, Colorado 80111

RE: Project No. 2211-0447

Leah,

The following is the information requested on a Monitoring Well Site, Wright-Price #1, Attica, Harper County, Kansas.

Point	North Coord.	East Coord.	Distance SE Cor. North	From S.30 West	Elev. Top Of Rim or PK Nail	Elev. Top of PVC Pipe	Latitude North	Longitude West
SE Corner S.30-T32S-R8W	40000	40000						
MW17	45016.27	38716.86	5016.27	1283.14	1453.59	1453.08	37.23868	98.22497
MW18	44941.80	38904.98	4941.80	1095.02	1453.94	1453.40	37.23847	98.22433
MW19	44855.90	38864.63	4855.90	1135.37	1451.54	1451.19	37.23824	98.22447
MW20	44594.38	38738.26	4594.38	1261.74	1451.56	1451.13	37.23752	98.22492
MW21	44581.88	38626.61	4581.88	1373.39	1451.27	1450.82	37.23749	98.22530
MW22	44611.54	38515.77	4611.54	1484.23	1450.33	1449.89	37.23758	98.22568
Site BM	45168.34	38537.43	5168.34	1462.57		SBM Elevation = 1454.17		

Description: "X" cut on north bolt on top of fire hydrant on East side of property.

MW17 is in the:	NW¼	NW¼	NE¼	NE¼	S.30-T32S-R8W
MW18 and MW19 are in the:	SW¼	NW¼	NE¼	NE¼	S.30-T32S-R8W
MW20 is in the:	NW¼	SW¼	NE¼	NE¼	S.30-T32S-R8W
MW21 and MW22 are in the:	NE¼	SE¼	NW¼	NE¼	S.30-T32S-R8W

If you have any questions, please do not hesitate in giving us a call.

Sincerely,



Tim Sloan, L.S.  
SMH CONSULTANTS

**COLORADO SPRINGS**  
411 South Tejon Street, Suite 100  
Colorado Springs, CO 80903  
P: 719-465-2145

**DODGE CITY**  
707 3<sup>rd</sup> Avenue, Suite A  
Dodge City, KS 67801  
P: 620-255-1952

**MANHATTAN - HQ**  
2017 Vanesta Place, Suite 110  
Manhattan, KS 66503  
P: 785-776-0541

**KANSAS CITY**  
5201 Johnson Drive, Suite 405  
Mission, KS 66205  
P: 913-444-9615

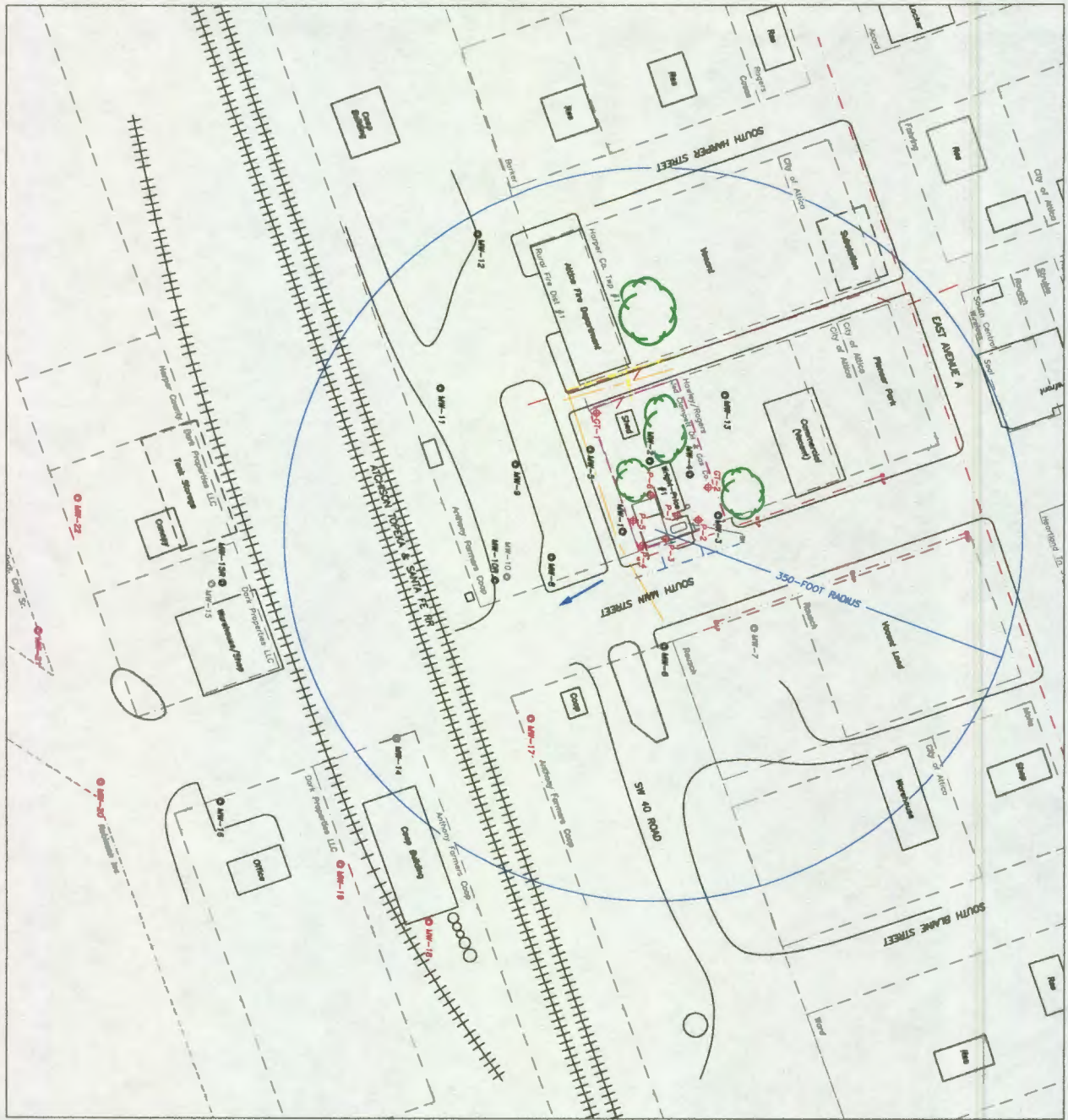

**LEGEND:**

- ◆ RIBSEA SOIL BORING
- NEW MONITORING WELL
- EXISTING MONITORING WELL
- ABANDONED MONITORING WELL
- - - SUBJECT SITE BOUNDARY
- - - PROPERTY LINE/OWNERS
- DUST BAY/PUMP ISLANDS
- - - OVERHEAD ELECTRIC/TELEPHONE LINE
- - - GAS LINE (APPROX. 1.5-3')
- - - SANITARY SEWER LINE (APPROX. 2-6')
- - - STORM SEWER LINE (APPROX. 2 TO 8')
- - - FIBER OPTIC LINE (APPROX. 1.5 TO 3')
- - - WATER LINE (APPROX. 2-6')
- GROUNDWATER FLOW DIRECTION

**NOTES:**

1. THE LOCATION OF THE DUST BAY, PRODUCT LINES & PUMP ISLANDS ARE APPROXIMATE, BASED ON SITE OBSERVATIONS AND PHOTO MAPS PROVIDED BY KONE.
2. UTILITY LOCATIONS AND DEPTHS ARE APPROXIMATE, BASED ON PHOTO MAPS PROVIDED BY KONE.
3. LIMITED SITE OBSERVATIONS AND PHOTO MAPS PROVIDED BY KONE.

FIGURE 2.1 - AREA BASE MAP (350-FOOT RADII)

REV.	DATE	DESCRIPTION
0	2.1	27222103.00

WRIGHT-PRICE #1  
(U2-039-13994)  
125 SOUTH MAIN  
ATTICA, KANSAS

DESIGNED BY LAM PROJECT NO. SLM  
DATE 11/2/2022

**SCS ENGINEERS**  
8575 West 110th Street, Suite 100  
Overland Park, Kansas 66210

REV.	DATE	BY	DESCRIPTION
R3		SBY	
R4		4BY	
R5		3BY	
R2		2BT	
R1		1BT	
RO		0BY	



WATER WELL RECORD Form WWC-5

Division of Water Resources App. No.

MW-20

Original Record Correction Change in Well Use

1 LOCATION OF WATER WELL: County: Harper Fraction NW 1/4 SW 1/4 NE 1/4 NE 1/4 Section Number 30 Township Number T 32 S Range Number R 8 E W

2 WELL OWNER: Last Name: KDHE Business: KDHE Address: 1000 SW Jackson St., Suite 420 City: Topeka State: KS ZIP: 66612-1367 Street or Rural Address where well is located: SE corner of intersection of Main St. + Attica Rd. Attica, KS.

3 LOCATE WELL WITH 'X' IN SECTION BOX: N W E S 1 mile

4 DEPTH OF COMPLETED WELL: 16 ft. Depth(s) Groundwater Encountered: 1) 16 ft. 2) ... 3) ... 4) Dry Well WELL'S STATIC WATER LEVEL: 12.31 ft. below land surface, measured on (mo-day-yr) 10-28-2022 Pump test data: Well water was ... after ... hours pumping ... gpm Estimated Yield: ... gpm Bore Hole Diameter: 8.75 in. to 16 ft. and ... in. to ... ft.

5 Latitude: 37.23752 (decimal degrees) Longitude: 98.22492 (decimal degrees) Horizontal Datum: WGS 84 NAD 83 NAD 27 Source for Latitude/Longitude: GPS (unit make/model: ... (WAAS enabled? Yes No) Land Survey Topographic Map Online Mapper: ... 6 Elevation: 1451.13 ft. Ground Level TOC Source: Land Survey GPS Topographic Map Other

7 WELL WATER TO BE USED AS: 1. Domestic: Household Lawn & Garden Livestock 2. Irrigation 3. Feedlot 4. Industrial 5. Public Water Supply: well ID 6. Dewatering: how many wells? 7. Aquifer Recharge: well ID 8. Monitoring: well ID MW-20 9. Environmental Remediation: well ID Air Sparge Soil Vapor Extraction Recovery Injection 10. Oil Field Water Supply: lease 11. Test Hole: well ID Cased Uncased Geotechnical 12. Geothermal: how many bores? a) Closed Loop Horizontal Vertical b) Open Loop Surface Discharge Inj. of Water 13. Other (specify):

Was a chemical/bacteriological sample submitted to KDHE? Yes No If yes, date sample was submitted: Water well disinfected? Yes No

8 TYPE OF CASING USED: Steel PVC Other CASING JOINTS: Glued Clamped Welded Threaded Casing diameter 2 in. to 6 ft., Diameter in. to ft., Diameter in. to ft. Casing height above land surface 0 in. Weight lbs./ft. Wall thickness or gauge No. sch 40 TYPE OF SCREEN OR PERFORATION MATERIAL: Steel Stainless Steel Fiberglass PVC Other (Specify) SCREEN OR PERFORATION OPENINGS ARE: Continuous Slot Mill Slot Gauze Wrapped Torch Cut Drilled Holes Other (Specify) Louvered Shutter Key Punched Wire Wrapped Saw Cut None (Open Hole) SCREEN-PERFORATED INTERVALS: From 6 ft. to 16 ft., From ft. to ft., From ft. to ft. GRAVEL PACK INTERVALS: From 4 ft. to 16 ft., From ft. to ft., From ft. to ft.

9 GROUT MATERIAL: Neat cement Cement grout Bentonite Other cement pad Grout Intervals: From 1 ft. to 4 ft., From 0 ft. to 1 ft., From ft. to ft. Nearest source of possible contamination: Septic Tank Lateral Lines Pit Privy Livestock Pens Insecticide Storage Sewer Lines Cess Pool Sewage Lagoon Fuel Storage Abandoned Water Well Watertight Sewer Lines Seepage Pit Feedyard Fertilizer Storage Oil Well/Gas Well Other (Specify) Direction from well? south Distance from well? 500 ft.

10 FROM TO LITHOLOGIC LOG FROM TO LITHO. LOG (cont.) or PLUGGING INTERVALS

FROM	TO	LITHOLOGIC LOG	FROM	TO	LITHO. LOG (cont.) or PLUGGING INTERVALS
0	1	Soil, brown			
1	7	Silty Clay, dark brown, dry			
7	10	Sand, tan-brown, fine, damp			
10	12.5	Sand, tan-brown, coarse, some gravel, da			
12.5	16	Sand, tan-brown, coarse, with gravel, wet			

Notes:

11 CONTRACTOR'S OR LANDOWNER'S CERTIFICATION: This water well was constructed, reconstructed, or plugged under my jurisdiction and was completed on (mo-day-year) 10-18-2022 and this record is true to the best of my knowledge and belief. Kansas Water Well Contractor's License No. 604 This Water Well Record was completed on (mo-day-year) 11/28/22 under the business name of Environmental Priority Service, Inc. Signature