

SMH CONSULTANTS

November 10, 2022

SCS Engineers
Leah Meyer
6161 S. Syracuse Way, Suite 210
Greenwood Village, Colorado 80111

RE: Project No. 2211-0447

Leah,

The following is the information requested on a Monitoring Well Site, Wright-Price #1, Attica, Harper County, Kansas.

Point	North Coord.	East Coord.	Distance SE Cor. North	From S.30 West	Elev. Top Of Rim or PK Nail	Elev. Top of PVC Pipe	Latitude North	Longitude West
SE Corner S.30-T32S-R8W	40000	40000						
MW17	45016.27	38716.86	5016.27	1283.14	1453.59	1453.08	37.23868	98.22497
MW18	44941.80	38904.98	4941.80	1095.02	1453.94	1453.40	37.23847	98.22433
MW19	44855.90	38864.63	4855.90	1135.37	1451.54	1451.19	37.23824	98.22447
MW20	44594.38	38738.26	4594.38	1261.74	1451.56	1451.13	37.23752	98.22492
MW21	44581.88	38626.61	4581.88	1373.39	1451.27	1450.82	37.23749	98.22530
MW22	44611.54	38515.77	4611.54	1484.23	1450.33	1449.89	37.23758	98.22568
Site BM	45168.34	38537.43	5168.34	1462.57		SBM Elevation = 1454.17		

Description: "X" cut on north bolt on top of fire hydrant on East side of property.

MW17 is in the:	NW¼ NW¼ NE¼ NE¼	S.30-T32S-R8W
MW18 and MW19 are in the:	SW¼ NW¼ NE¼ NE¼	S.30-T32S-R8W
MW20 is in the:	NW¼ SW¼ NE¼ NE¼	S.30-T32S-R8W
MW21 and MW22 are in the:	NE¼ SE¼ NW¼ NE¼	S.30-T32S-R8W

If you have any questions, please do not hesitate in giving us a call.

Sincerely,



Tim Sloan, L.S.
SMH CONSULTANTS

COLORADO SPRINGS
411 South Tejon Street, Suite i
Colorado Springs, CO 80903
P: 719-465-2145

DODGE CITY
707 3rd Avenue, Suite A
Dodge City, KS 67801
P: 620-255-1952

MANHATTAN - HQ
2017 Vanesta Place, Suite 110
Manhattan, KS 66503
P: 785-776-0541

KANSAS CITY
5201 Johnson Drive, Suite 405
Mission, KS 66205
P: 913-444-9615

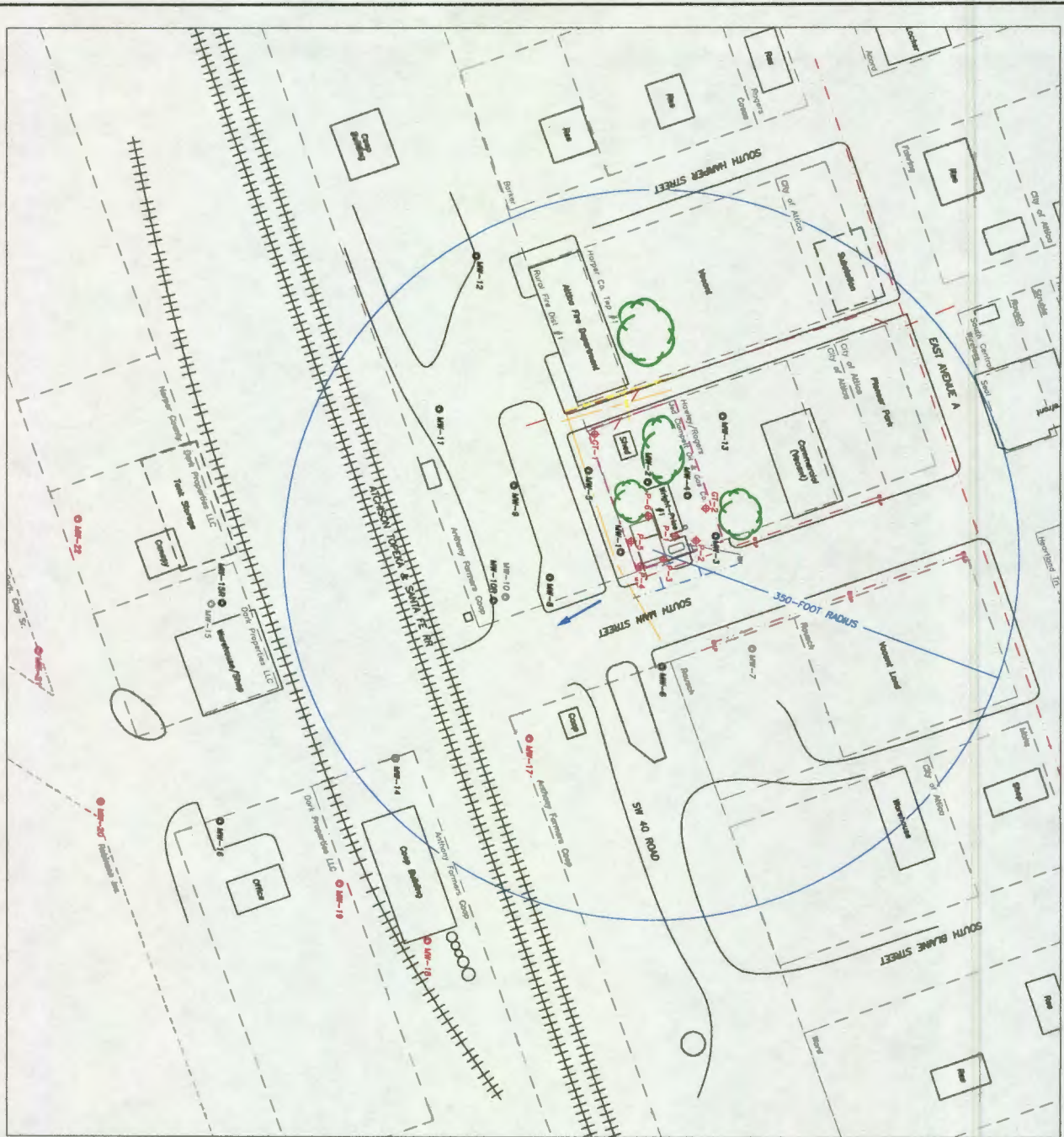

- LEGEND:**
- ◆ KOSKA SOIL BORING
 - ◆ NEW MONITORING WELL
 - EXISTING MONITORING WELL
 - ABANDONED MONITORING WELL
 - SUBJECT SITE BOUNDARY
 - PROPERTY LINE/OWNER'S
 - OVERHEAD ELECTRIC/TELEPHONE LINE
 - GAS LINE (APPROX. 1.5"-3")
 - SANITARY SEWER LINE (APPROX. 2'-6")
 - STORM SEWER LINE (APPROX. 2 TO 8')
 - FIBER OPTICS LINE (APPROX. 1.5 TO 3')
 - WATER LINE (APPROX. 2'-6')
 - GROUNDWATER FLOW DIRECTION
- NOTES:**
1. THE LOCATION OF THE LIST BASH, PRODUCT LINES & PUMP ISLANDS ARE APPROXIMATE, BASED ON SITE OBSERVATIONS AND PROXY LINES PROVIDED BY KONE.
 2. UTILITY LOCATIONS AND DEPTHS ARE APPROXIMATE, BASED ON FIELD SITE OBSERVATIONS AND FROM MAPS PROVIDED BY KONE.

FIGURE 2.1 - AREA BASE MAP (350-FOOT RADIUS)

REV. 0	ISSUANCE NUMBER	PROJECT NUMBER
	2.1	27222103.00

CLIENT	WRIGHT-PRICE #1 (U2-039-13994) 125 SOUTH MAIN ATTICA, KANSAS
DRAWN BY LAM	RECORD BY LAM
PROJECT DATE SLJ	DATE
11/2/2022	11/2/2022

SCS ENGINEERS
8575 West 110th Street, Suite 100
Overland Park, Kansas 66210

REV.	DATE	BY	DESCRIPTION
R3		58Y	
R4		48Y	
R3		38Y	
R2		28Y	
R1		18Y	
RO		08Y	

WATER WELL RECORD Form WWC-5

Division of Water Resources App. No.

MW-21

Original Record Correction Change in Well Use

Well ID

1 LOCATION OF WATER WELL: County: Harper Fraction NE 1/4 SE 1/4 NW 1/4 NE 1/4 Section Number 30 Township Number T 32 S Range Number R 8 E W

2 WELL OWNER: Last Name: KDHE Business: KDHE Address: 1000 SW Jackson St., Suite 420 City: Topeka State: KS ZIP: 66612-1367 Street or Rural Address where well is located: Approximately 50 ft. W. of the SW corner of the intersection of S. Main Street & Attica Road, Attica, Ks.

3 LOCATE WELL WITH 'X' IN SECTION BOX: N W E S 1 mile. 4 DEPTH OF COMPLETED WELL: 15 ft. Depth(s) Groundwater Encountered: 1) 15 ft. 2) 12.79 ft. 3) 10-26-2022. WELL'S STATIC WATER LEVEL: 12.79 ft. below land surface, measured on (mo-day-yr) 10-26-2022. Pump test data: Well water was 10-26-2022 after 10-26-2022 hours pumping 10-26-2022 gpm. Estimated Yield: 10-26-2022 gpm. Bore Hole Diameter: 8.75 in. to 16 ft. and 10-26-2022 in. to 10-26-2022 ft. 5 Latitude: 37.23749 (decimal degrees) Longitude: 98.22530 (decimal degrees) Horizontal Datum: WGS 84 NAD 83 NAD 27 Source for Latitude/Longitude: GPS (unit make/model: (WAAS enabled? Yes No) Land Survey Topographic Map Online Mapper: 6 Elevation: 1450.82 ft. Ground Level TOC Source: Land Survey GPS Topographic Map Other

7 WELL WATER TO BE USED AS: 1. Domestic: Household Lawn & Garden Livestock Irrigation Feedlot Industrial 2. Public Water Supply: well ID 3. Dewatering: how many wells? 4. Aquifer Recharge: well ID 5. Monitoring: well ID MW-21 6. Environmental Remediation: well ID Air Sparge Soil Vapor Extraction Recovery Injection 7. Oil Field Water Supply: lease 8. Test Hole: well ID Cased Uncased Geotechnical 9. Geothermal: how many bores? a) Closed Loop Horizontal Vertical b) Open Loop Surface Discharge Inj. of Water 10. Other (specify):

Was a chemical/bacteriological sample submitted to KDHE? Yes No If yes, date sample was submitted: Water well disinfected? Yes No

8 TYPE OF CASING USED: Steel PVC Other CASING JOINTS: Glued Clamped Welded Threaded Casing diameter 2 in. to 5 ft., Diameter in. to ft., Diameter in. to ft. Casing height above land surface 0 in. Weight lbs./ft. Wall thickness or gauge No. sch. 40 TYPE OF SCREEN OR PERFORATION MATERIAL: Steel Stainless Steel Fiberglass PVC Other (Specify) Brass Galvanized Steel Concrete tile None used (open hole) SCREEN OR PERFORATION OPENINGS ARE: Continuous Slot Mill Slot Gauze Wrapped Torch Cut Drilled Holes Other (Specify) Louvered Shutter Key Punched Wire Wrapped Saw Cut None (Open Hole) SCREEN-PERFORATED INTERVALS: From 5 ft. to 15 ft., From ft. to ft., From ft. to ft. GRAVEL PACK INTERVALS: From 3 ft. to 15 ft., From ft. to ft., From ft. to ft.

9 GROUT MATERIAL: Neat cement Cement grout Bentonite Other cement pad Grout Intervals: From 1 ft. to 3 ft., From 0 ft. to 1 ft., From ft. to ft. Nearest source of possible contamination: Septic Tank Lateral Lines Pit Privy Livestock Pens Insecticide Storage Sewer Lines Cess Pool Sewage Lagoon Fuel Storage Abandoned Water Well Watertight Sewer Lines Seepage Pit Feedyard Fertilizer Storage Oil Well/Gas Well Other (Specify) Direction from well? south Distance from well? 550 ft.

Table with 6 columns: FROM, TO, LITHOLOGIC LOG, FROM, TO, LITHO. LOG (cont.) or PLUGGING INTERVALS. Rows: 0-1 Soil, brown; 1-7.5 Silty Clay, brown, dry; 7.5-11.5 Sand, tan-brown, coarse, damp; 11.5-13 Sand, tan-brown, fine, damp; 13-15 Sand, tan-brown, fine, wet. Includes Notes section.

11 CONTRACTOR'S OR LANDOWNER'S CERTIFICATION: This water well was constructed, reconstructed, or plugged under my jurisdiction and was completed on (mo-day-year) 10-18-2022 and this record is true to the best of my knowledge and belief. Kansas Water Well Contractor's License No. 604 This Water Well Record was completed on (mo-day-year) 11/15/22 under the business name of Environmental Priority Service, Inc. Signature P. S. H. T.